



4901 S. ORANGE AVENUE

Orlando, FL 32806

RETAIL SPACE FOR LEASE | SODO / EDGEWOOD | ORLANDO, FL 32806



PROPERTY DESCRIPTION

This retail redevelopment opportunity is located along **South Orange Avenue in the SoDo / Edgewood** area of Orlando, offering exceptional visibility along a corridor seeing **over 50,000 vehicles per day**.

The property is undergoing a **full redesign and renovation**, with delivery anticipated in early 2027. Once complete, the project will total **4,607 square feet**, thoughtfully reimagined to bring new life and energy to a well-known address.

Mosaic Hair Studio and Blowout Bar are already committed to the project, occupying **2,507 square feet**. Mosaic is a proven placemaker known for transforming properties into vibrant destinations, with successful redesign projects in **Ivanhoe Row** and the **Milk District**. Their presence brings a steady flow of daily traffic and sets the tone for the overall vision of the site.

Approximately **2,100 square feet remain available** for an additional retail user. The space is well suited for a **health and wellness concept**, though other retail users that align with the vision and complement Mosaic's presence will be considered. The completed project will deliver a curated, design-forward retail environment reflective of the surrounding SoDo / Edgewood community.

PROPERTY HIGHLIGHTS

- Retail redevelopment opportunity on South Orange Avenue
- SoDo / Edgewood location
- 50,000+ average daily traffic
- 4,607 SF total project
- 2,507 SF committed to Mosaic Hair Studio and Blowout Bar
 - *2,100 SF available for an additional retail user
- Full redesign and renovation underway
- Delivery anticipated early 2027
- Health & wellness-forward retail opportunity
- Open to other retail users that align with the project vision
- Mosaic projects include successful redesigns in Ivanhoe Row and the Milk District

SITE PLAN / FLOOR PLAN

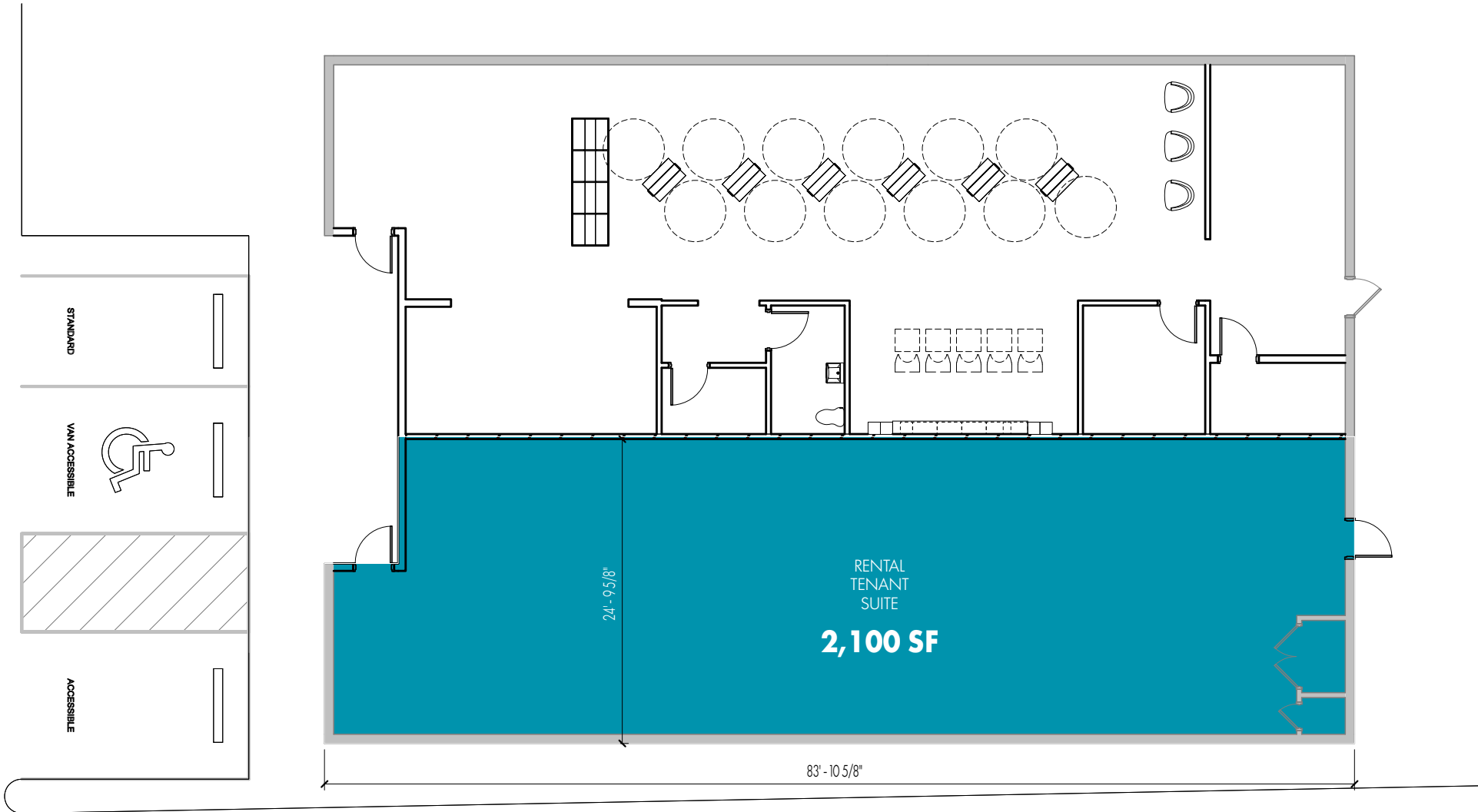

AERIAL PHOTOS





Population Density
Per Sq Miles

Under 350
351 - 600
601 - 900
901 - 1,200
1,201 - 1,800

1 MILE

3 MILES



Oak Ridge

Holden Heights

527

Edgewood

Pine Castle

17

527A

Landstreet Rd W

Landstreet Rd E

East-West Expy

Hurry Ford Rd

Shing Ave

Leevist

Cargo Rd

Aleigh St

Columbia St

McLeod Rd

Taino's BAKERY

Americana Blvd

Oak Ridge

Sand Lake Rd

Landstreet Rd W

Landstreet Rd E

W South St

W Gore St

S Westmoreland Dr

Rio Grande Ave S

S Orange Blossom Trl

S John Young Pkwy

Holden Ave

527

S Fern Creek Ave

Bumby Ave S

S Crystal Lake Dr

Hoffner Ave

Judge Rd

Conway Rd

Daetwyler Dr

SR-528-TOLL W Jetport Dr

E Michigan St

Lake Margaret Dr

Hurry Ford Rd

Shing Ave

Leevist

Cargo Rd

DEMOGRAPHICS

POPULATION SUMMARY	1 mile	3 miles	5 miles
2025 TOTAL POPULATION	6,818	112,812	285,759
2030 TOTAL POPULATION	6,979	114,163	292,605
2025 TOTAL HOUSEHOLDS	2,810	42,868	116,201
AVERAGE HOUSEHOLD INCOME	\$154,883	\$102,926	\$95,578
2025 DAYTIME POPULATION	6,481	149,622	430,045
HOUSEHOLD GROWTH RATE 2025-2030	0.4%	0.2%	0.5%



CONTACT INFORMATION:

AMY CALANDRINO, CCIM, SIOR
Director
Direct: +1 407 492 0433
amy.calandrino@cushwake.com

EASTON RICKS
Associate
Direct: +1 407 949 0803
easton.ricks@cushwake.com

20 North Orange Avenue
Orlando, Florida 32801
+1 407 841 8000
cushmanwakefield.com

©2026 Cushman & Wakefield. All rights reserved. The information contained in this communication is strictly confidential. This information has been obtained from sources believed to be reliable but has not been verified. NO WARRANTY OR REPRESENTATION, EXPRESS OR IMPLIED, IS MADE AS TO THE CONDITION OF THE PROPERTY (OR PROPERTIES) REFERENCED HEREIN OR AS TO THE ACCURACY OR COMPLETENESS OF THE INFORMATION CONTAINED HEREIN, AND SAME IS SUBMITTED SUBJECT TO ERRORS, OMISSIONS, CHANGE OF PRICE, RENTAL OR OTHER CONDITIONS, WITHDRAWAL WITHOUT NOTICE, AND TO ANY SPECIAL LISTING CONDITIONS IMPOSED BY THE PROPERTY OWNER(S). ANY PROJECTIONS, OPINIONS OR ESTIMATES ARE SUBJECT TO UNCERTAINTY AND DO NOT SIGNIFY CURRENT OR FUTURE PROPERTY PERFORMANCE.