

Specifications

±48,797 SF AVAILABLE SIZE	±1.75 AC LOT SIZE
±17' – 25' CEILING HEIGHTS	LED LIGHTING
20' x 20' COLUMN SPACING	6 LOADING DOCKS
120' TRUCK COURT	1 DRIVE-IN DOOR
±5,516 SF 1 st Floor	
±3,122 SF 2 nd Floor	
±8,638 SF Total OFFICE	
20-Car Parking	
Fully Fenced & Secured Lot	
New Roof, Repainted Exterior	
Interior Spaced White Boxed	
COMMENTS	

For additional property information or to arrange an inspection, please contact the exclusive brokers:

Jason M. Crimmins, CCIM, SIOR
Chief Executive Officer
973.379.6644 x 122
jmcrimmins@blauberg.com

Alessandro (Alex) Conte, CCIM, SIOR
President
973.379.6644 x 131
aconte@blauberg.com

Peter J. Murano, Jr., SIOR
Managing Executive Director
973.379.6644 x 114
pjmurano@blauberg.com

FOR LEASE | 328 THOMAS STREET | NEWARK, NJ



For additional property information or to arrange an inspection, please contact the exclusive brokers:

Jason M. Crimmins, CCIM, SIOR
Chief Executive Officer
973.379.6644 x 122
jmcrimmins@blauberg.com

Alessandro (Alex) Conte, CCIM, SIOR
President
973.379.6644 x 131
aconte@blauberg.com

Peter J. Murano, Jr., SIOR
Managing Executive Director
973.379.6644 x 114
pjmurano@blauberg.com

The information contained herein has been obtained from sources considered to be reliable, but no guarantee of its accuracy is made by this company. In addition, no representation is made respecting zoning, condition of title, dimensions, or any matters of a legal or environmental nature. Such matters should be referred to legal counsel for determination. Terms and conditions are subject to change without prior notice. Subject to errors and omissions.



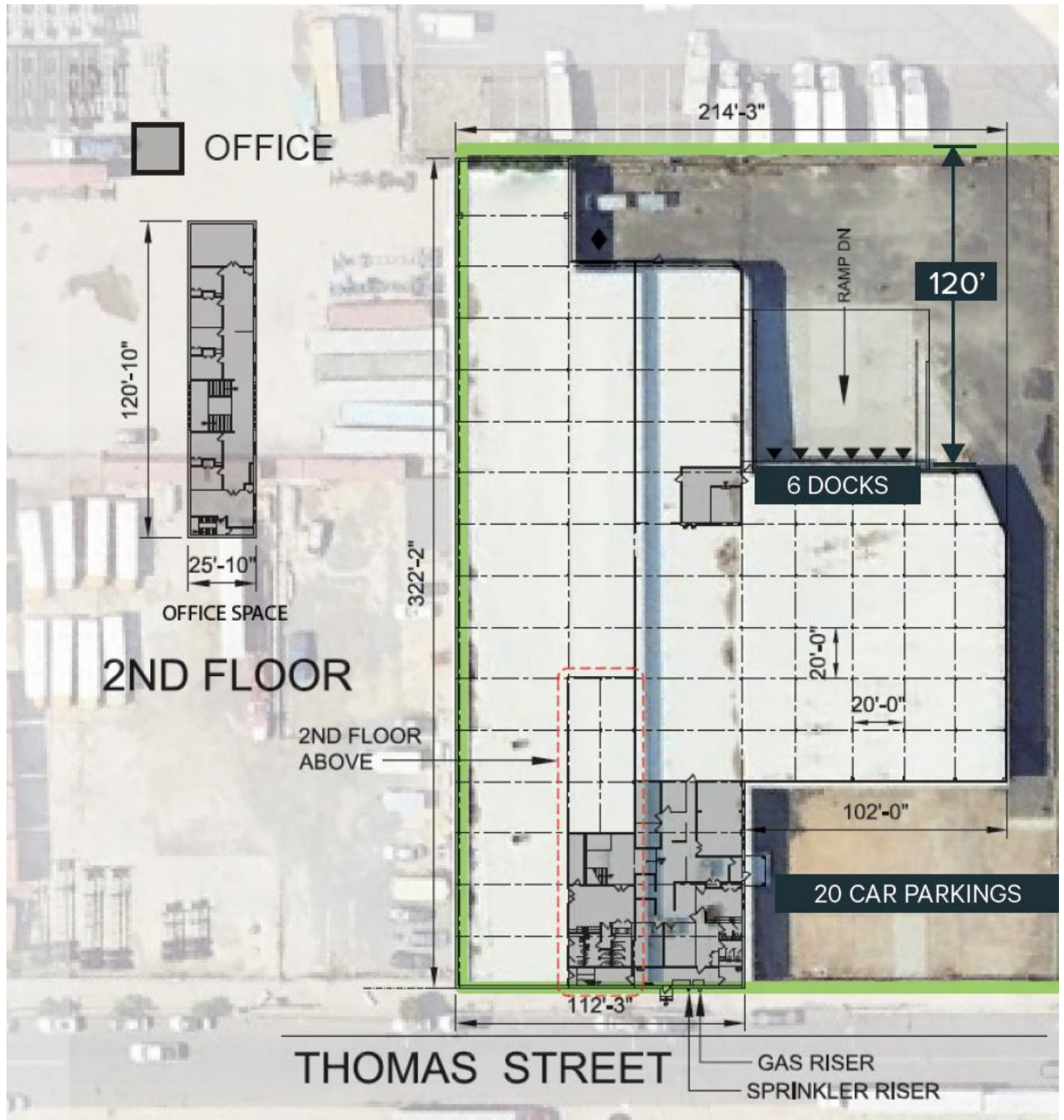

For additional property information or to arrange an inspection, please contact the exclusive brokers:

Jason M. Crimmins, CCIM, SIOR
Chief Executive Officer
973.379.6644 x 122
jmcrimmins@blauberg.com

Alessandro (Alex) Conte, CCIM, SIOR
President
973.379.6644 x 131
aconte@blauberg.com

Peter J. Murano, Jr., SIOR
Managing Executive Director
973.379.6644 x 114
pjmurano@blauberg.com

The information contained herein has been obtained from sources considered to be reliable, but no guarantee of its accuracy is made by this company. In addition, no representation is made respecting zoning, condition of title, dimensions, or any matters of a legal or environmental nature. Such matters should be referred to legal counsel for determination. Terms and conditions are subject to change without prior notice. Subject to errors and omissions.



5 MILES

- Total Population: 896,462
- Households: 328,030
- Median Household Income: \$72,995
- Average Household Size: 2.7
- Transportation to Work: 431,352
- Labor Force: 713,859

10 MILES

- Total Population: 3.3M
- Households: 1.34M
- Median Household Income: \$115,457
- Average Household Size: 2.4
- Transportation to Work: 1.78M
- Labor Force: 2.72M

15 MILES

- Total Population: 8.53M
- Households: 3.42M
- Median Household Income: \$109,335
- Average Household Size: 2.4
- Transportation to Work: 4.5M
- Labor Force: 7.03M

For additional property information or to arrange an inspection, please contact the exclusive brokers:

Jason M. Crimmins, CCIM, SIOR
Chief Executive Officer
973.379.6644 x 122
jmcrimmins@blauberg.com

Alessandro (Alex) Conte, CCIM, SIOR
President
973.379.6644 x 131
aconte@blauberg.com

Peter J. Murano, Jr., SIOR
Managing Executive Director
973.379.6644 x 114
pjmurano@blauberg.com

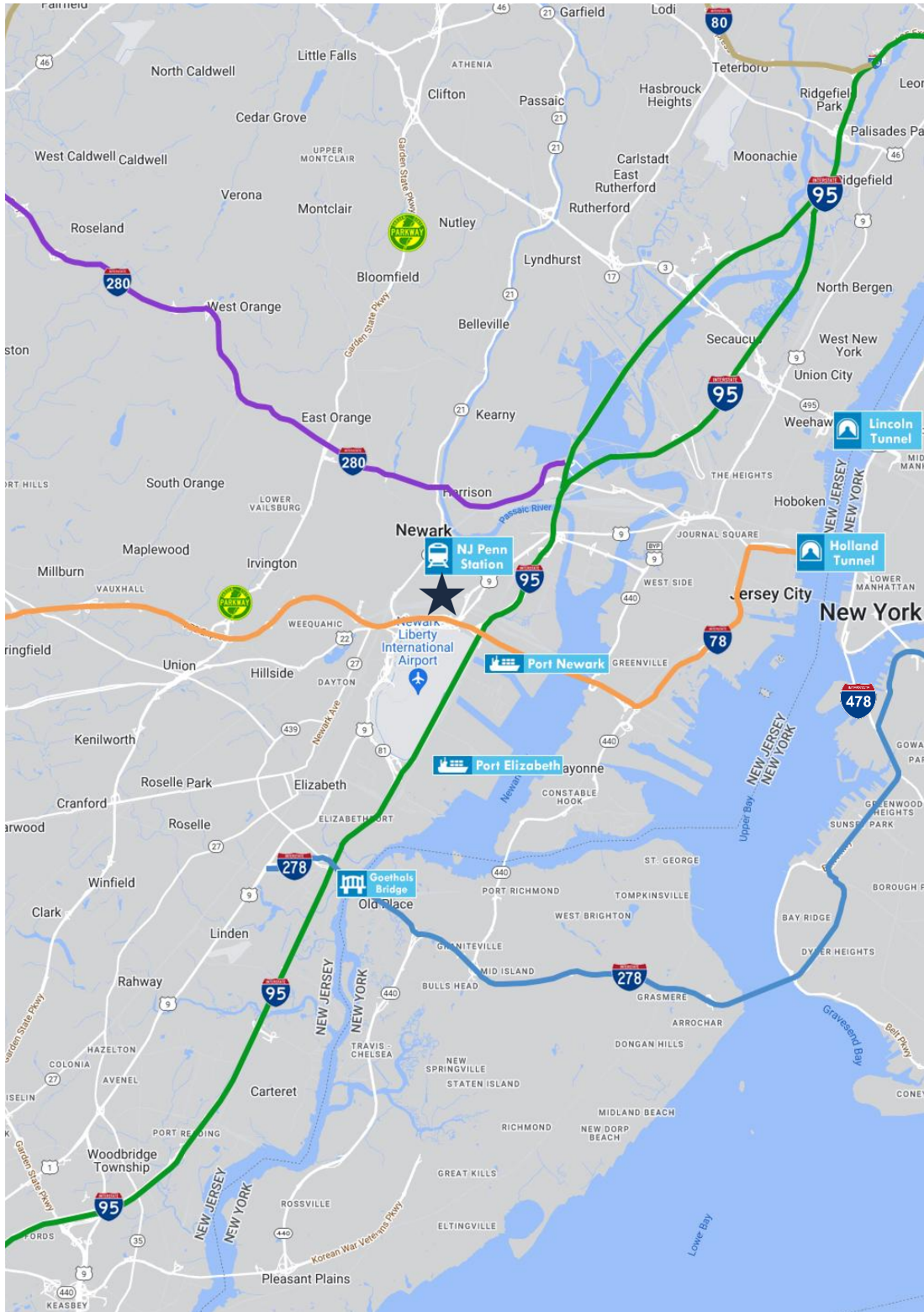

ACCESSIBILITY



0.6 MI
US Hwy 1 & 9



1.0 MI
I-78



1.6 MI
Penn Station



1.9 MI
I-95 Exit 14



2.8 MI
I-280 Exit 15



4.1 MI
Newark Airport



5.4 MI
Ports Newark
and Elizabeth



8.1 MI
Holland Tunnel



13.1 MI
Lincoln Tunnel

For additional property information or to arrange an inspection, please contact the exclusive brokers:

Jason M. Crimmins, CCIM, SIOR
Chief Executive Officer
973.379.6644 x 122
jmcrimmins@blauberg.com

Alessandro (Alex) Conte, CCIM, SIOR
President
973.379.6644 x 131
aconte@blauberg.com

Peter J. Murano, Jr., SIOR
Managing Executive Director
973.379.6644 x 114
pjmurano@blauberg.com

The information contained herein has been obtained from sources considered to be reliable, but no guarantee of its accuracy is made by this company. In addition, no representation is made respecting zoning, condition of title, dimensions, or any matters of a legal or environmental nature. Such matters should be referred to legal counsel for determination. Terms and conditions are subject to change without prior notice. Subject to errors and omissions.