



# STADIUM PLAZA BUSINESS PARK



# ±18,400 SF

## FOR LEASE

2530-2532 E. CERRITOS AVENUE, ANAHEIM, CA

### FEATURES

- ±4,000 Square Feet of Office Space
- ±14,400 Square Feet of Warehouse Space
- 4 Ground Level Doors
- 1 Exterior Truckwell
- 16' Warehouse Clear Height
- 400 Amps 120/208 Volt Power
- Fire Sprinklered
- Excellent Access to the , , , and Freeways
- On Site Property Management
- Close to Retail Amenities
- Business Park Environment

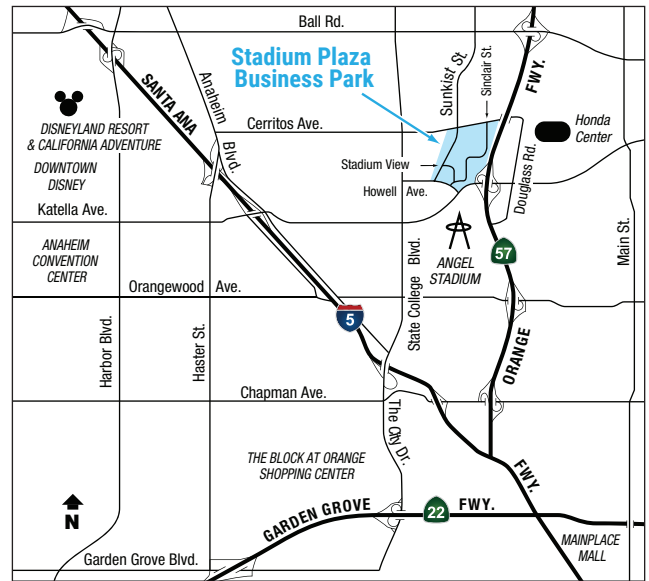

[WWW.STADIUMPLAZABUSINESSPARK.COM](http://WWW.STADIUMPLAZABUSINESSPARK.COM)

**MITCH ZEHNER**  
 Executive Vice President  
 714.935.2307  
 MZehner@voitco.com  
 Lic. #00882464

**MICHAEL ZEHNER**  
 Senior Vice President  
 714.935.2328  
 McZehner@voitco.com  
 Lic. #01917963

**SETH DAVENPORT**  
 Executive Vice President  
 714.935.2376  
 SDavenport@voitco.com  
 Lic. #01413387



2020 Main Street, Suite 100 | Irvine, California 92614 | 949.851.5100 | 949.261.9092 Fax | Lic #01991785 | [www.VoitCo.com](http://www.VoitCo.com)

Licensed as Real Estate Salespersons by the DRE. The information contained herein has been obtained from sources we deem reliable. While we have no reason to doubt its accuracy, we do not guarantee it. ©2023 Voit Real Estate Services, Inc. All Rights Reserved. License #01991785.



# STADIUM PLAZA BUSINESS PARK

## ±18,400 SF FOR LEASE

2530-2532 E. CERRITOS AVENUE  
Anaheim, California

### Site Plan

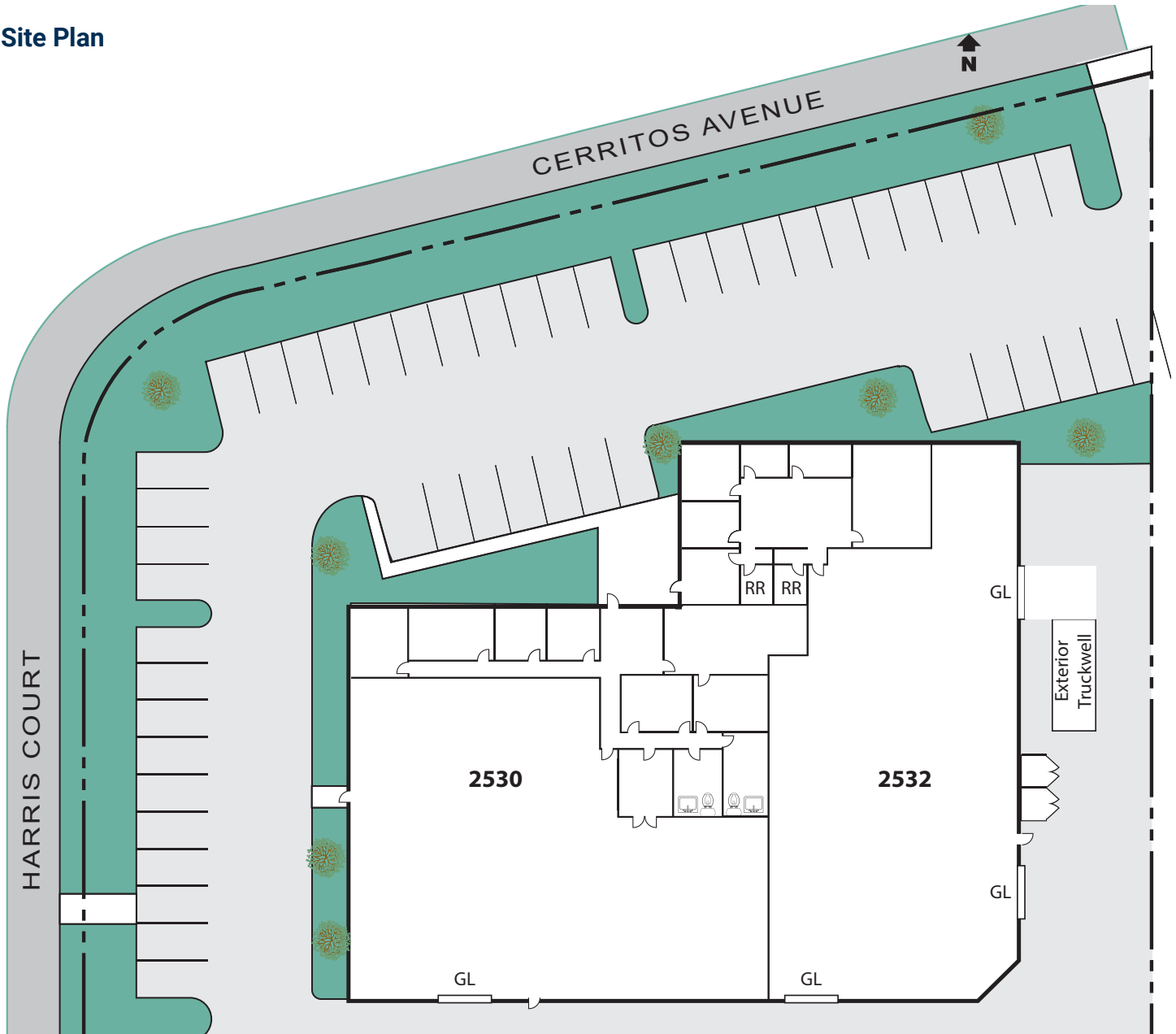

**MITCH ZEHNER**  
Executive Vice President  
714.935.2307  
MZehner@voitco.com  
Lic. #00882464

**MICHAEL ZEHNER**  
Senior Vice President  
714.935.2328  
McZehner@voitco.com  
Lic. #01917963

**SETH DAVENPORT**  
Executive Vice President  
714.935.2376  
SDavenport@voitco.com  
Lic. #01413387



2020 Main Street, Suite 100 | Irvine, California 92614 | 949.851.5100 | 949.261.9092 Fax | Lic #01991785 | [www.VoitCo.com](http://www.VoitCo.com)

Licensed as Real Estate Salespersons by the DRE. The information contained herein has been obtained from sources we deem reliable. While we have no reason to doubt its accuracy, we do not guarantee it.  
©2023 Voit Real Estate Services, Inc. All Rights Reserved. License #01991785.



# STADIUM PLAZA BUSINESS PARK

## ±18,400 SF FOR LEASE

2530-2532 E. CERRITOS AVENUE  
Anaheim, California

### Floor Plan

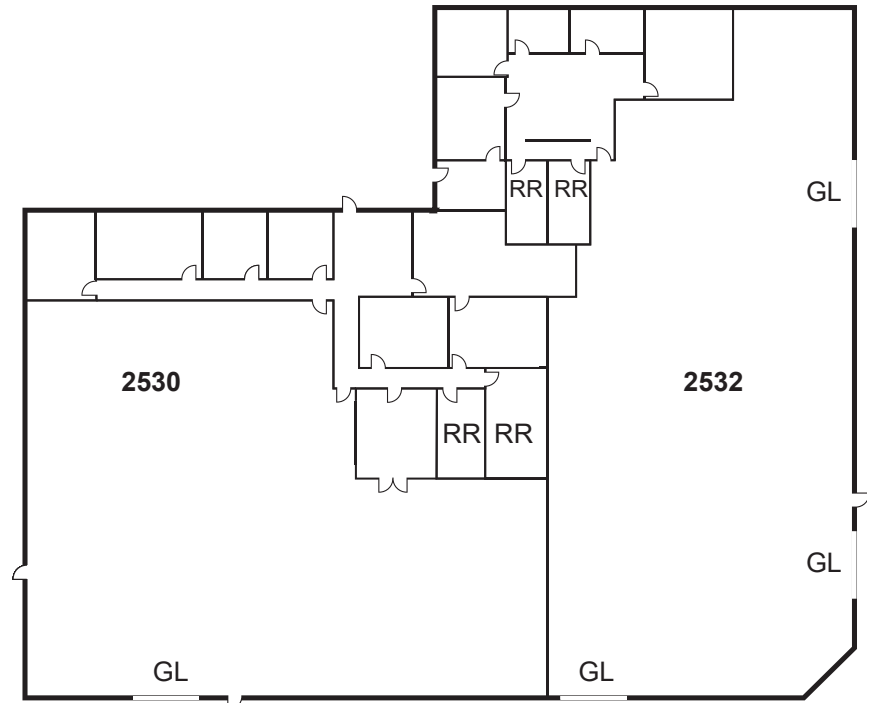

**MITCH ZEHNER**  
Executive Vice President  
714.935.2307  
MZehner@voitco.com  
Lic. #00882464

**MICHAEL ZEHNER**  
Senior Vice President  
714.935.2328  
McZehner@voitco.com  
Lic. #01917963

**SETH DAVENPORT**  
Executive Vice President  
714.935.2376  
SDavenport@voitco.com  
Lic. #01413387



2020 Main Street, Suite 100 | Irvine, California 92614 | 949.851.5100 | 949.261.9092 Fax | Lic #01991785 | [www.VoitCo.com](http://www.VoitCo.com)

Licensed as Real Estate Salespersons by the DRE. The information contained herein has been obtained from sources we deem reliable. While we have no reason to doubt its accuracy, we do not guarantee it. ©2023 Voit Real Estate Services, Inc. All Rights Reserved. License #01991785.