



10969 TRADE CENTER DRIVE, RANCHO CORDOVA  
PROFESSIONAL OFFICE SPACE FOR LEASE

**NEWMARK**

**JACK BLACKMON**  
916.569.2372  
Jack.Blackmon@nrmk.com

02

PROPERTY  
HIGHLIGHTS

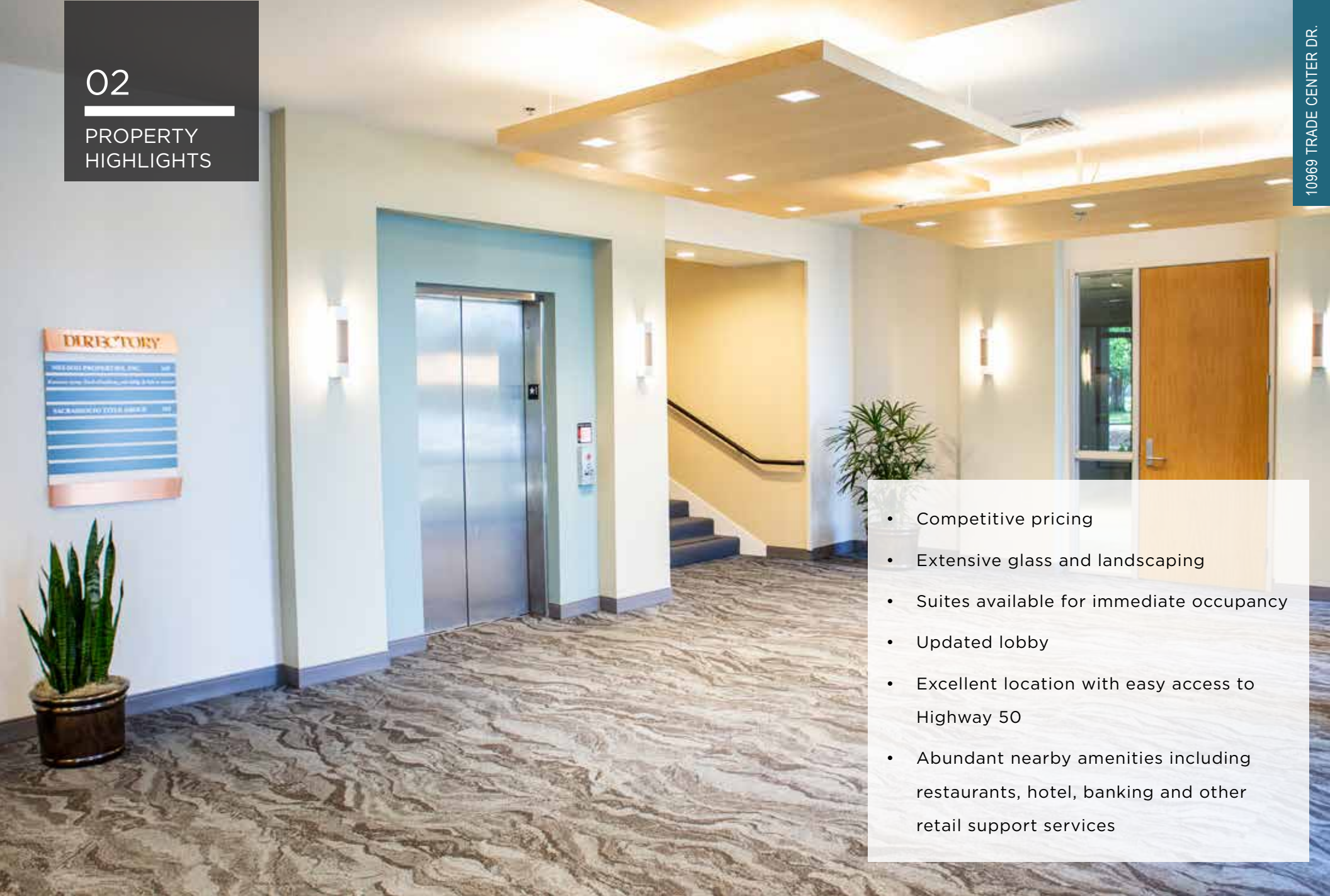

- Competitive pricing
- Extensive glass and landscaping
- Suites available for immediate occupancy
- Updated lobby
- Excellent location with easy access to Highway 50
- Abundant nearby amenities including restaurants, hotel, banking and other retail support services

03

FLOOR  
PLAN

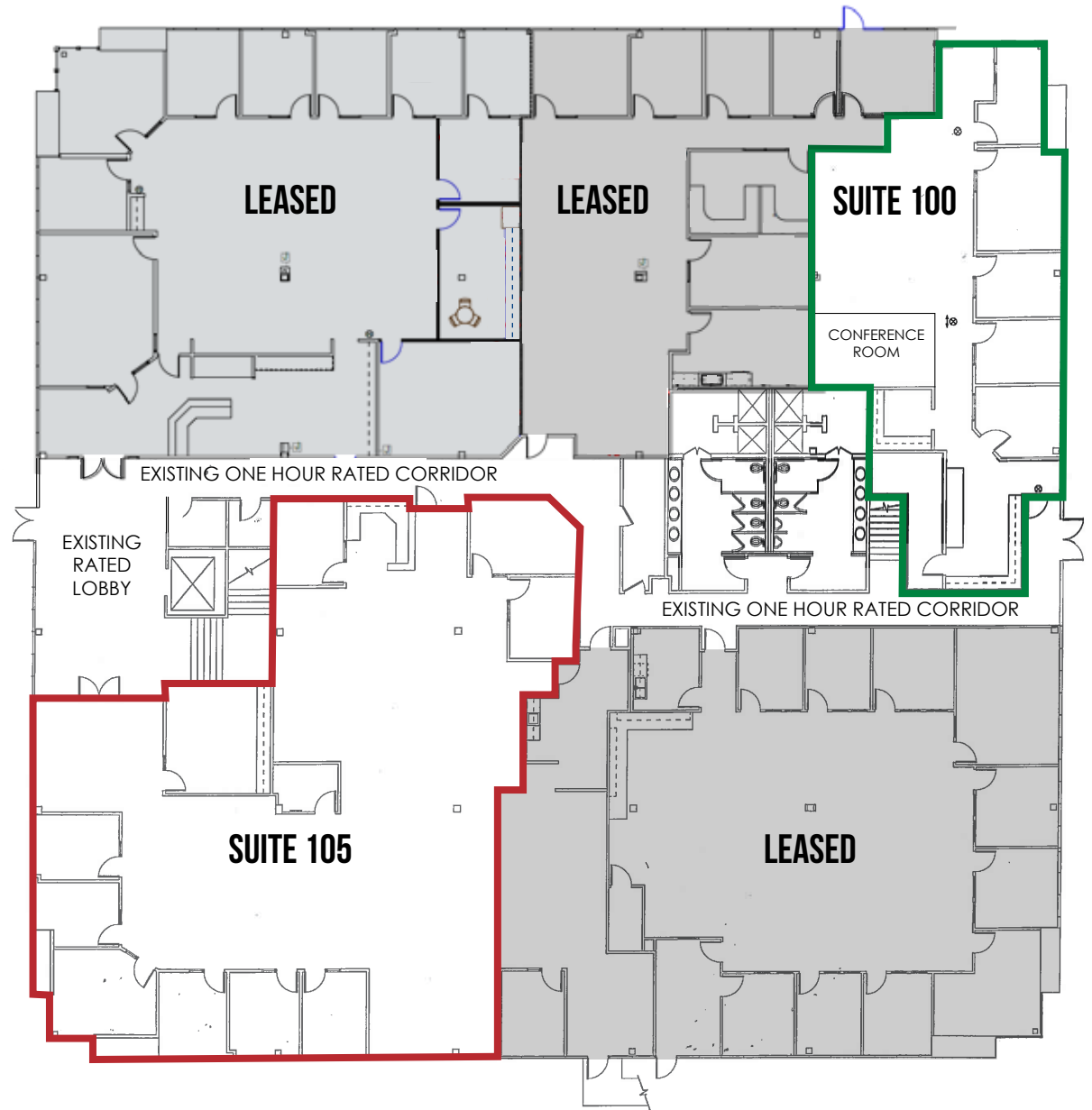

■ Suite 100: ±2,481 RSF

■ Suite 105: ±5,150 RSF

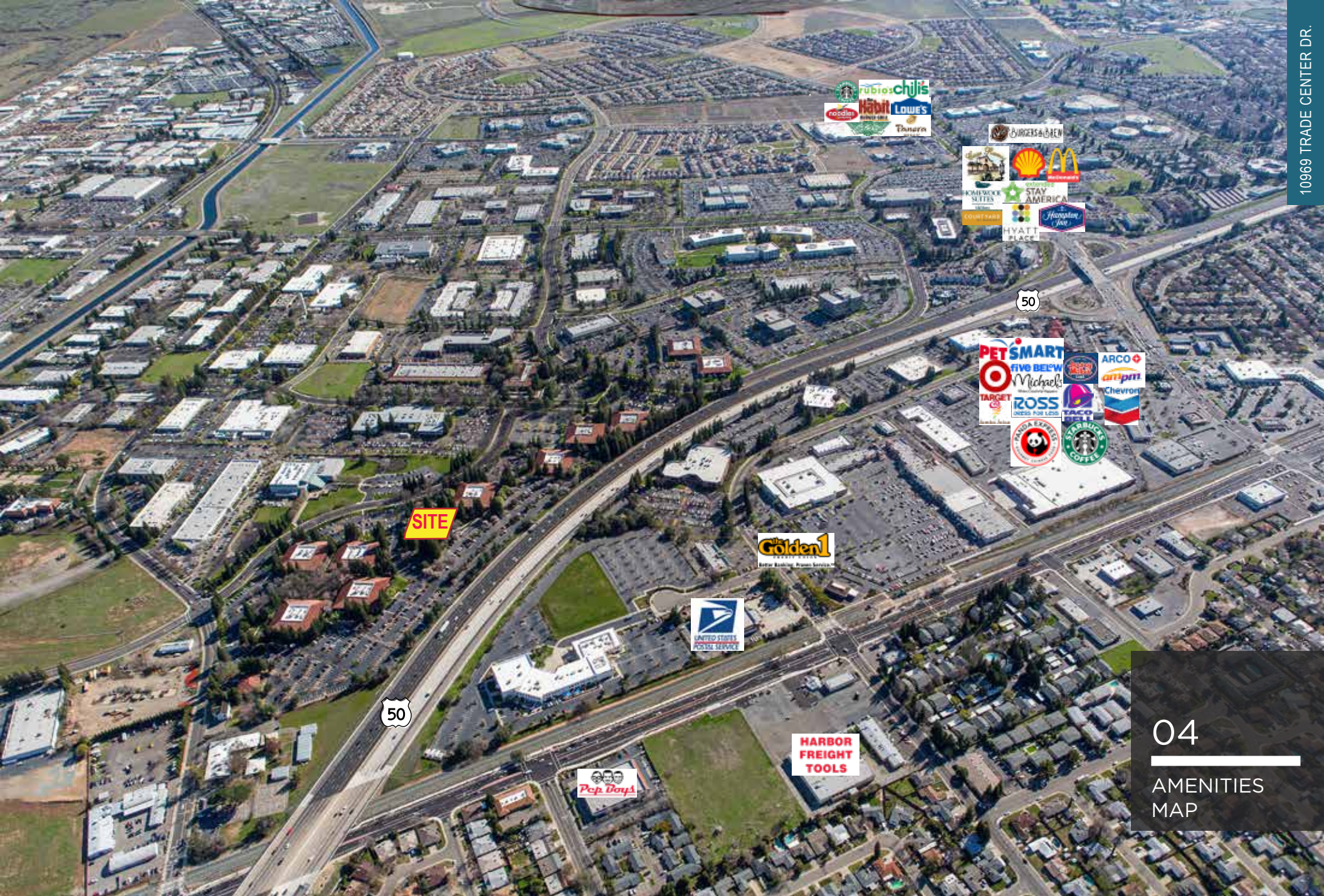

**SITE**

50

50

**The Golden 1**  
Member Banking. Member Services.

UNITED STATES  
POSTAL SERVICE

**Peppercorn's**

**HARBOR  
FREIGHT  
TOOLS**

**Publix**  
**schij's**  
**habib**  
**LOWE'S**  
**panera**

**BURGERS & BREAD**  
**McDonald's**  
**STAY GREEN AMERICA**  
**HYATT PLACE**

**PET SMART**  
**Five Below**  
**Target**  
**ROSS**  
**ARCO**  
**am pm**  
**Chevron**  
**STARBUCKS COFFEE**

04  
AMENITIES  
MAP

**LIGHT RAIL**

- Gold Line
- Gold Line Station

**BUS ROUTES**

- 74 International
- 175 Zinfandel to Sunrise Park
- 176 Zinfandel to Kavala Ranch
- 177 Zinfandel to Baroque & Corvina
- Site



05  
TRANSPORTATION  
MAP

PLUG & PLAY

06

ADDITIONAL  
PHOTOS



10969 TRADE CENTER DR.



NEWMARK



**JACK BLACKMON**

916.569.2372 o

916.494.2349 c

Jack.Blackmon@nmrk.com

CA RE License #01999561

NEWMARK

980 NINTH STREET, SUITE 2500 | SACRAMENTO, CA 95814

**NEWMARK**

The distributor of this communication is performing acts for which a real estate license is required. The information contained herein has been obtained from sources deemed reliable but has not been verified and no guarantee, warranty or representation, either express or implied, is made with respect to such information. Terms of sale or lease and availability are subject to change or withdrawal without notice. NMRK-NWMKTG - 17-0879 • 12/2025