

# FOR LEASE

## Fourth Plain Business Park

6700 NE 152nd Avenue  
Vancouver, WA 98682

**PACIFIC NW**  
**PNW PROPERTIES**



### LOCATION

- High traffic count fronting Fourth Plain Blvd
- Adjacent to the new Walmart
- 3 minutes to SR 500; 5 minutes to I-205
- Close to amenities: Vancouver Mall, Walmart, food, shopping, fitness & hotels.

### PROJECT HIGHLIGHTS

- Brand new construction with modern finishes
- Build-to-suit improvements
- Dock and Grade loading doors
- 16' ceiling clear height
- Fire sprinklered
- Well-maintained, professional setting
- Locally-owned and managed
- Please call for competitive pricing and more info

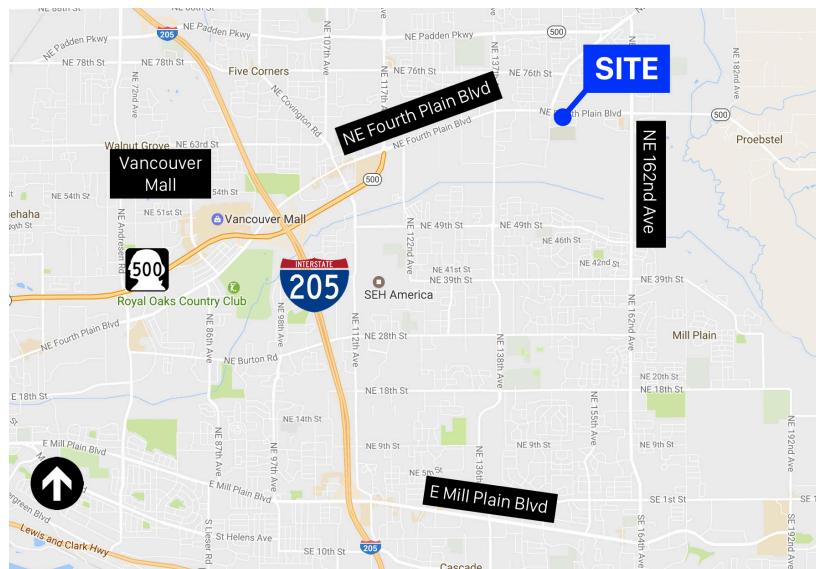

For more information, please contact:

**Mitch Page or Evan Bernstein**  
**(503) 626-3500**

**[mitch.page@pnwprop.com](mailto:mitch.page@pnwprop.com)**

**[evan.bernstein@pnwprop.com](mailto:evan.bernstein@pnwprop.com)**

**pnwprop.com**

The information contained herein is believed to be accurate but is not warranted as to its accuracy and may change or be updated without notice.

# FOR LEASE

## Fourth Plain Business Park

6700 NE 152nd Avenue  
Vancouver, WA 98682

**PACIFIC NW**  
**PNW PROPERTIES**

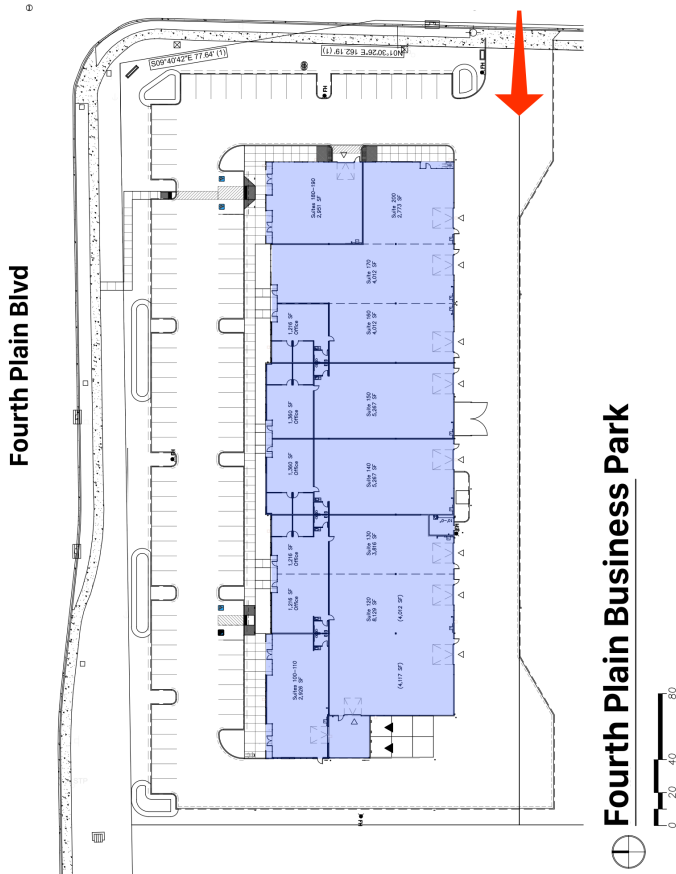

For more information, please contact:  
**Mitch Page or Evan Bernstein**  
**(503) 626-3500**  
[mitch.page@pnwprop.com](mailto:mitch.page@pnwprop.com)  
[evan.bernstein@pnwprop.com](mailto:evan.bernstein@pnwprop.com)

[pnwprop.com](http://pnwprop.com)

The information contained herein is believed to be accurate but is not warranted as to its accuracy and may change or be updated without notice.