

# 420 EAST SOUTH TEMPLE

FOR SUBLEASE



## PROPERTY DETAILS

420 East South Temple, Salt Lake City, Utah 84111

- **\$14.95/RSF full service**
- **6% commission to procuring agent**
- **Plug and play opportunity**
- Like new condition
- Great views
- 11,105 RSF available
- Ten (10) modern workstations
- Office furniture in place
- 3/1,000 SF parking included
- CAT-5 wiring
- Lease expiration: 6/30/2026



**COLLIN PERKINS**  
cperkins@newmarkmw.com  
direct 801.604.0064  
[View Profile](#)

**SKYE GALLEY**  
sgalley@newmarkmw.com  
direct 801.971.3602  
[View Profile](#)

**FULL SERVICE  
COMMERCIAL REAL ESTATE**  
312 East South Temple  
Salt Lake City, Utah 84111  
Office 801.456.8800  
[www.newmarkmw.com](http://www.newmarkmw.com)

# 420 EAST SOUTH TEMPLE

| SUITE 520



**NEWMARK**  
MOUNTAIN WEST

**COLLIN PERKINS**  
cperkins@newmarkmw.com  
direct 801.604.0064  
[View Profile](#)

**SKYE GALLEY**  
sgalley@newmarkmw.com  
direct 801.971.3602  
[View Profile](#)

**FULL SERVICE  
COMMERCIAL REAL ESTATE**  
312 East South Temple  
Salt Lake City, Utah 84111  
Office 801.456.8800  
[www.newmarkmw.com](http://www.newmarkmw.com)

# 420 EAST SOUTH TEMPLE

## FLOOR PLAN

### FIFTH FLOOR

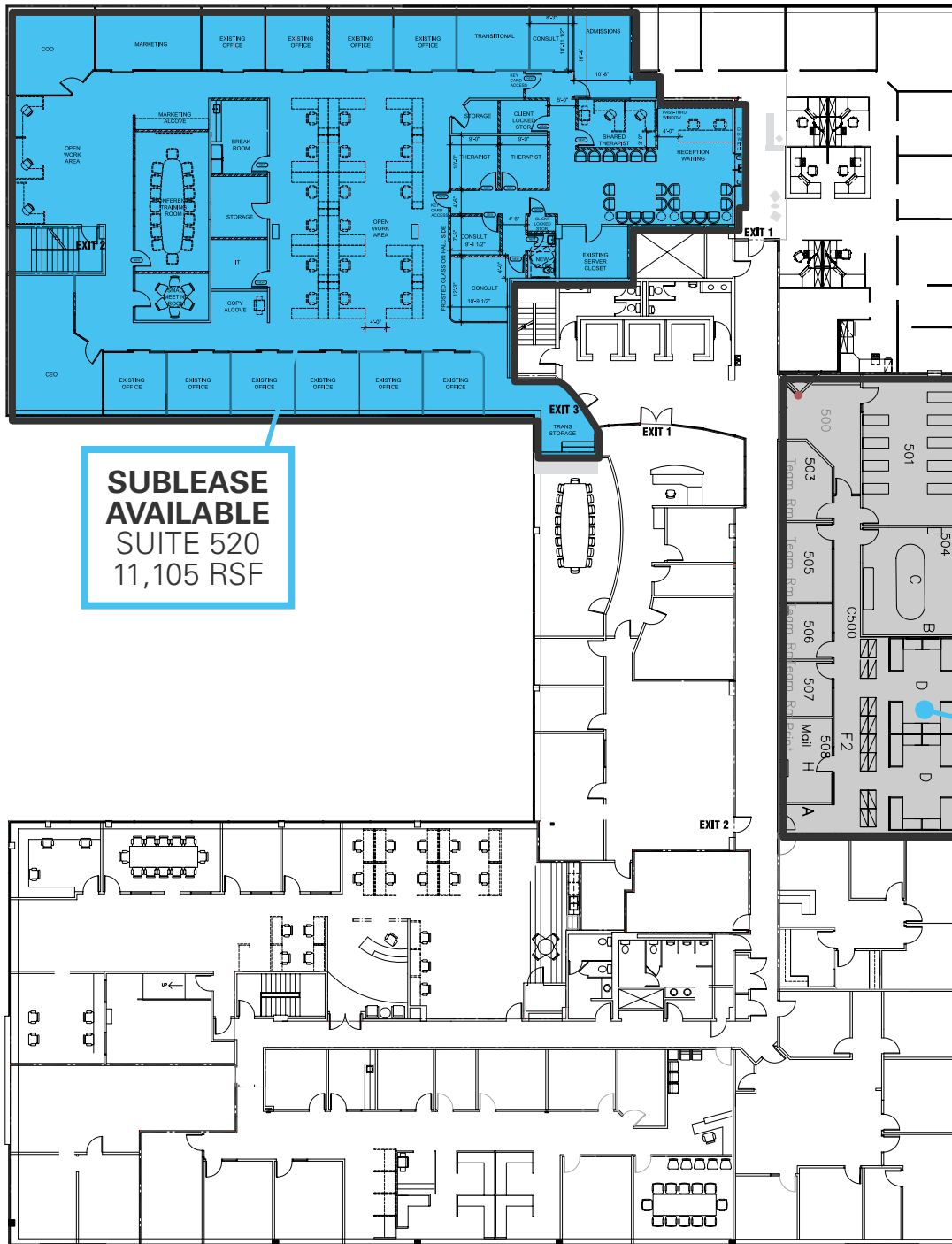

**COLLIN PERKINS**  
cperkins@newmarkmw.com  
direct 801.604.0064  
[View Profile](#)

**SKYE GALLEY**  
sgalley@newmarkmw.com  
direct 801.971.3602  
[View Profile](#)

**FULL SERVICE  
COMMERCIAL REAL ESTATE**  
312 East South Temple  
Salt Lake City, Utah 84111  
Office 801.456.8800  
[www.newmarkmw.com](http://www.newmarkmw.com)

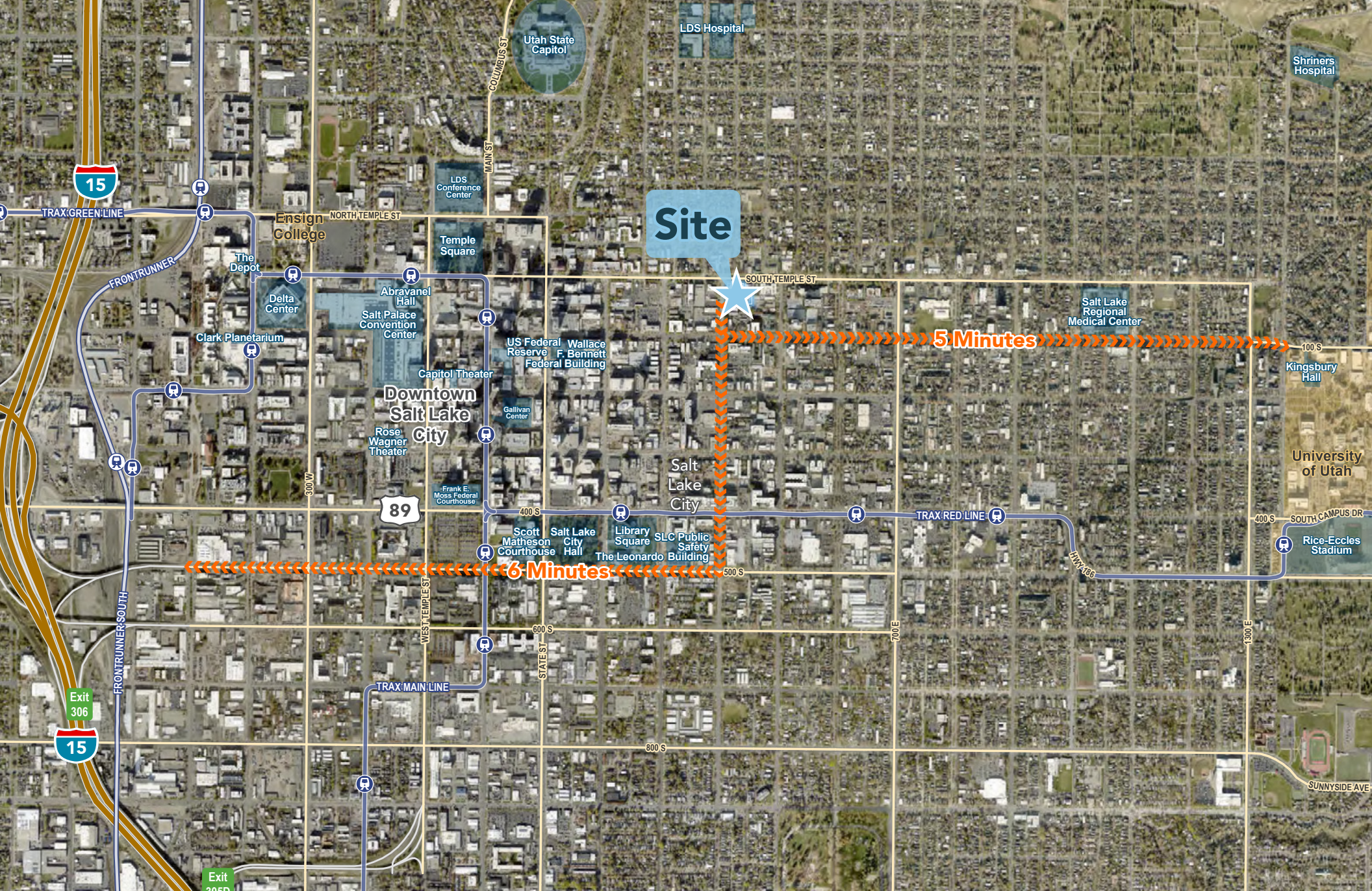

**NEWMARK**  
MOUNTAIN WEST

**COLLIN PERKINS**  
cperkins@newmarkmw.com  
direct 801.604.0064  
[View Profile](#)

**SKYE GALLEY**  
sgalley@newmarkmw.com  
direct 801.971.3602  
[View Profile](#)

**FULL SERVICE  
COMMERCIAL REAL ESTATE**  
312 East South Temple  
Salt Lake City, Utah 84111  
Office 801.456.8800  
[www.newmarkmw.com](http://www.newmarkmw.com)