

**For  
Lease**

**14,535 SF**  
Industrial Unit  
Available

OWNED & MANAGED BY



## 3729 N 25th Avenue

SCHILLER PARK, ILLINOIS

AVAILABLE	14,535 SF
BUILDING SIZE	42,546 SF
CLEAR HEIGHT	18'
OFFICE AREA	2,400 SF
LOADING	3 Drive-In Doors
POWER	200A @ 240V Subpanel 150A @ 208V 3-Phase
RE TAXES	\$4.68 PSF
CAM & INS	\$1.32 PSF
LEASE RATE	Subject to Offer
COMMENTS	Excellent proximity to O'Hare Institutionally owned & managed

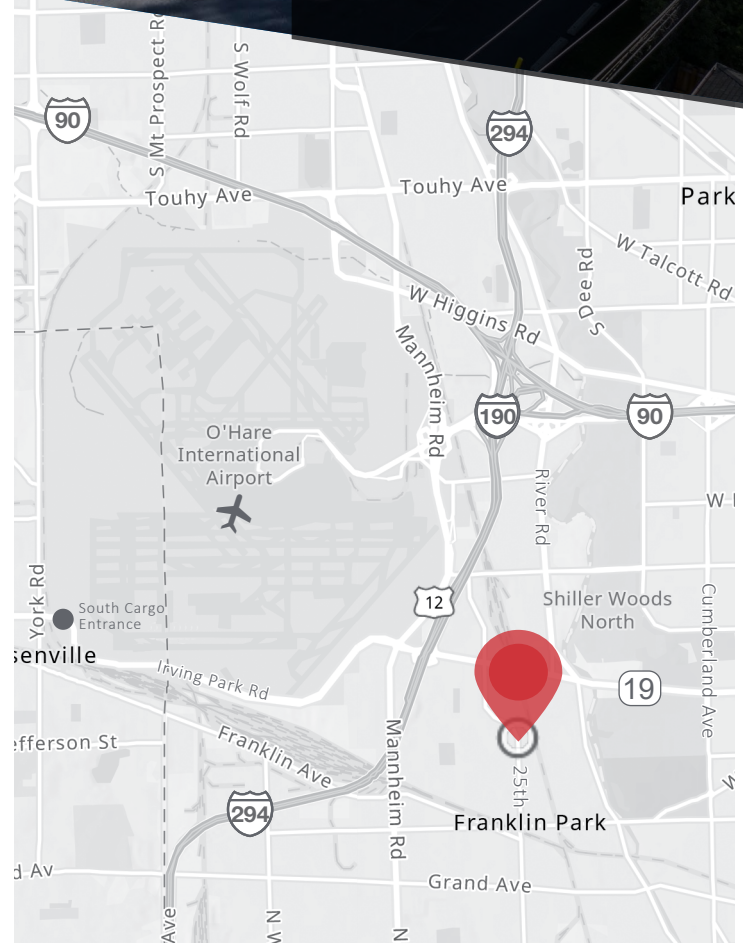

### Contact

Terry Herlihy  
+1 630 693 0664  
therlihy@hiffman.com

Mark Baumhart, CCIM  
+1 630 691 0550  
mbaumhart@hiffman.com

One Oakbrook Terrace Suite 400  
Oakbrook Terrace, Illinois 60181  
+1 630 932 1234  
**hiffman.com**

UNIT PLAN

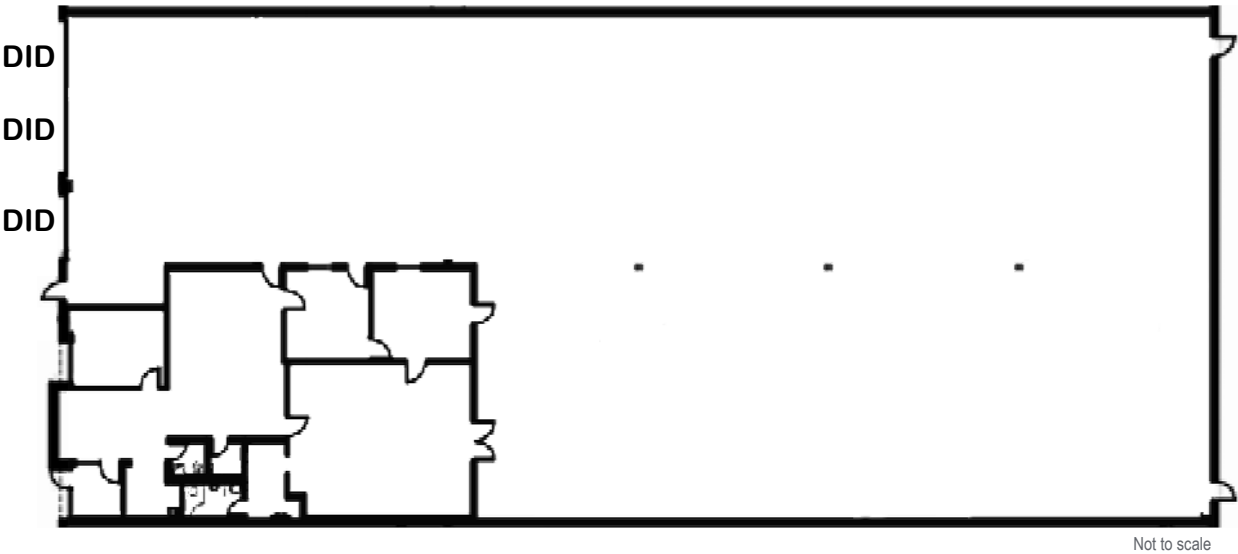

Not to scale

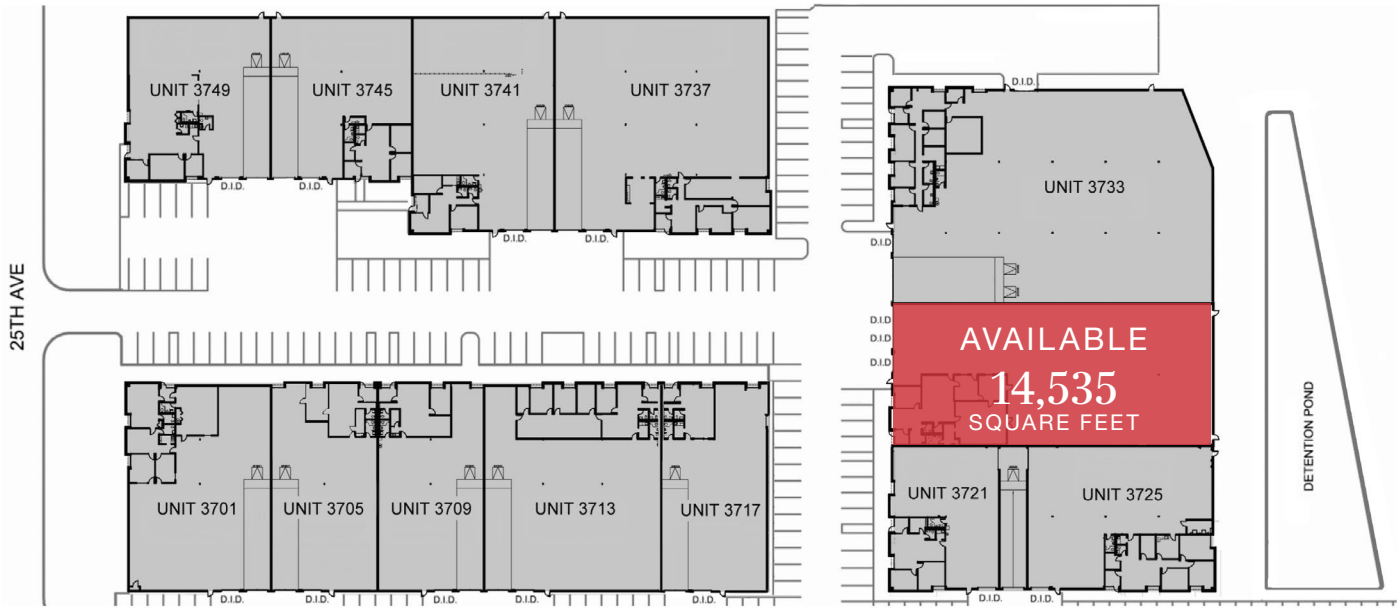

OWNED & MANAGED BY

**WESTMOUNT**  
REALTY CAPITAL, LLC

**NAL Hiffman**  
Commercial Real Estate Services, Worldwide

**HIFFMAN**  
NATIONAL

One Oakbrook Terrace  
Suite 400  
Oakbrook Terrace, Illinois 60181  
+1 630 932 1234

[hiffman.com](http://hiffman.com)