



# 207 Adelaide Suite 200

Available Summer 2023

# Location:

Address:	207 Adelaide Street East
Access:	On King and Queen streetcar line, 5 minutes to King and Queen subway station, 15 minutes to Union Station



# Floorplan

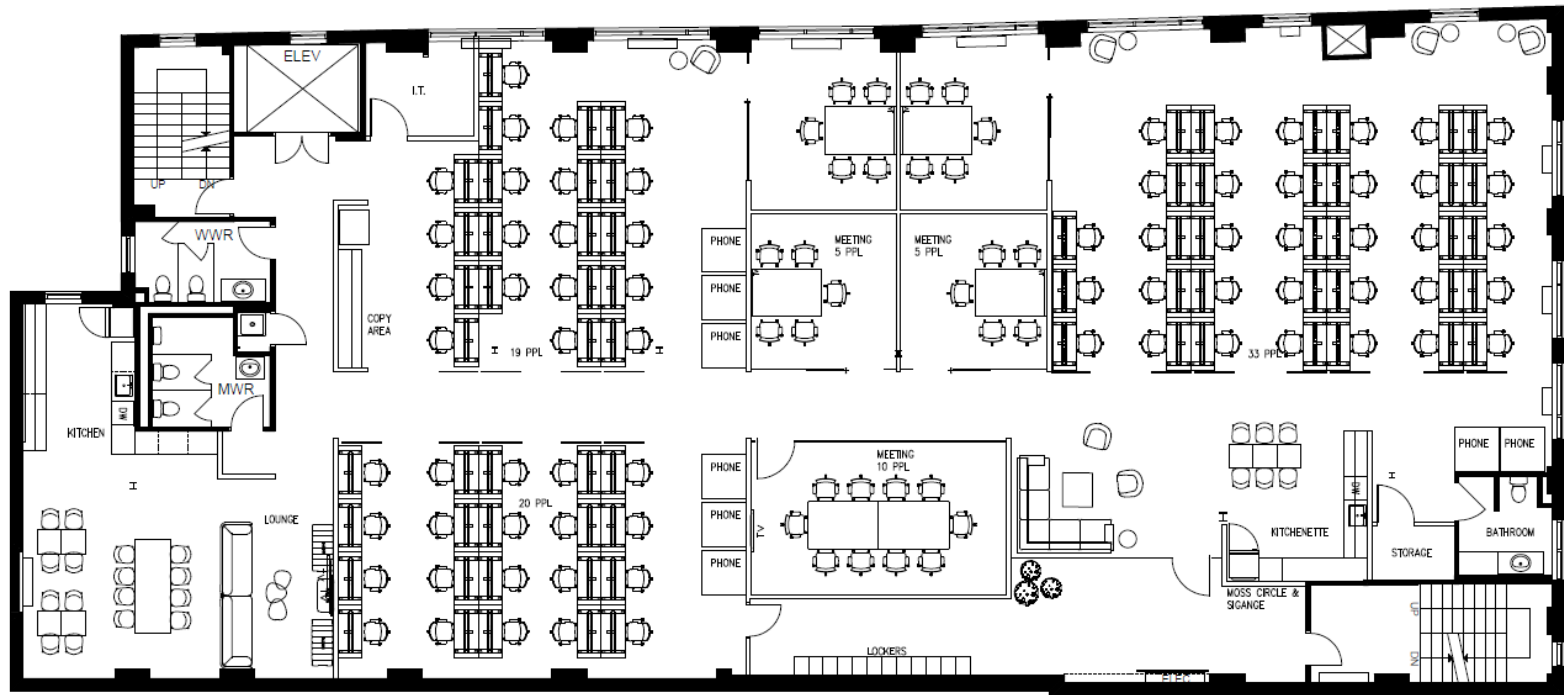

Full floorplate in heritage brick and beam building, featuring:

- Seats 72 people on sit-stand desks
- Two lounges
- Two kitchens
- 8 phone booths
- Four meeting rooms seating 5 people each (full AV set-up)
- Conference room seating 10 people
- Fully managed and serviced office (coffee + tea service), dedicated concierge, managed IT and security cameras
- Individual lockers
- Private washrooms



# HQ Suite Benefits

In addition to the numerous member benefits, our HQ Suite solution provides exclusive benefits for your team

	Entire floorplan HQ Suite	Private Office
Dedicated meeting rooms	Y	-
Access to shared meeting rooms	Y	Y
Dedicated phone booth	Y	-
Ensuite kitchenette	Y	-
Ensuite washrooms	Y	-
Ensuite lounge	Y	-
Access to shared coworking lounge	Y	Y





Rethink your workspace

