

2,370 SF MidTown End Cap
With Patio Available for Lease

FOR LEASE

Virginia Street Plaza

555 S Virginia Street, Reno, NV 89501

Smith Retzloff Retail Team

Shannon Leonard

Associate

+1 775 413 9026

shannon.leonard@colliers.com

CA Lic 02146615

Shawn Smith

Executive Vice President

+1 775 823 4667

shawn.smith@colliers.com

CA Lic 01986877

Sean Retzloff

Senior Vice President

+1 775 823 6621

sean.retzloff@colliers.com

CA Lic 02025190

Colliers

Colliers Reno

5520 Kietzke Lane, Suite 300

Reno, NV 89511

Colliers.com/Reno

Located in MidTown Reno and within close proximity to high-density residential neighborhoods. The center offers excellent visibility on South Virginia Street, a heavily-traveled thoroughfare with over 13,800 vehicles per day.

Tenants in the center include: Great Full Gardens, Statement Barbershop, and Batch Cupcakery

Attractive tenants create a significant amount of traffic to property on a daily basis

Rare dedicated parking in high density retail corridor

The center benefits from approximately 135 feet of frontage along South Virginia Street

An average of 13,800 vehicles per day on South Virginia Street

Unit Availability

Suite 101	Available - Former MoneyTree	2,370 SF
-----------	------------------------------	----------



Available for Lease

Unit Availability

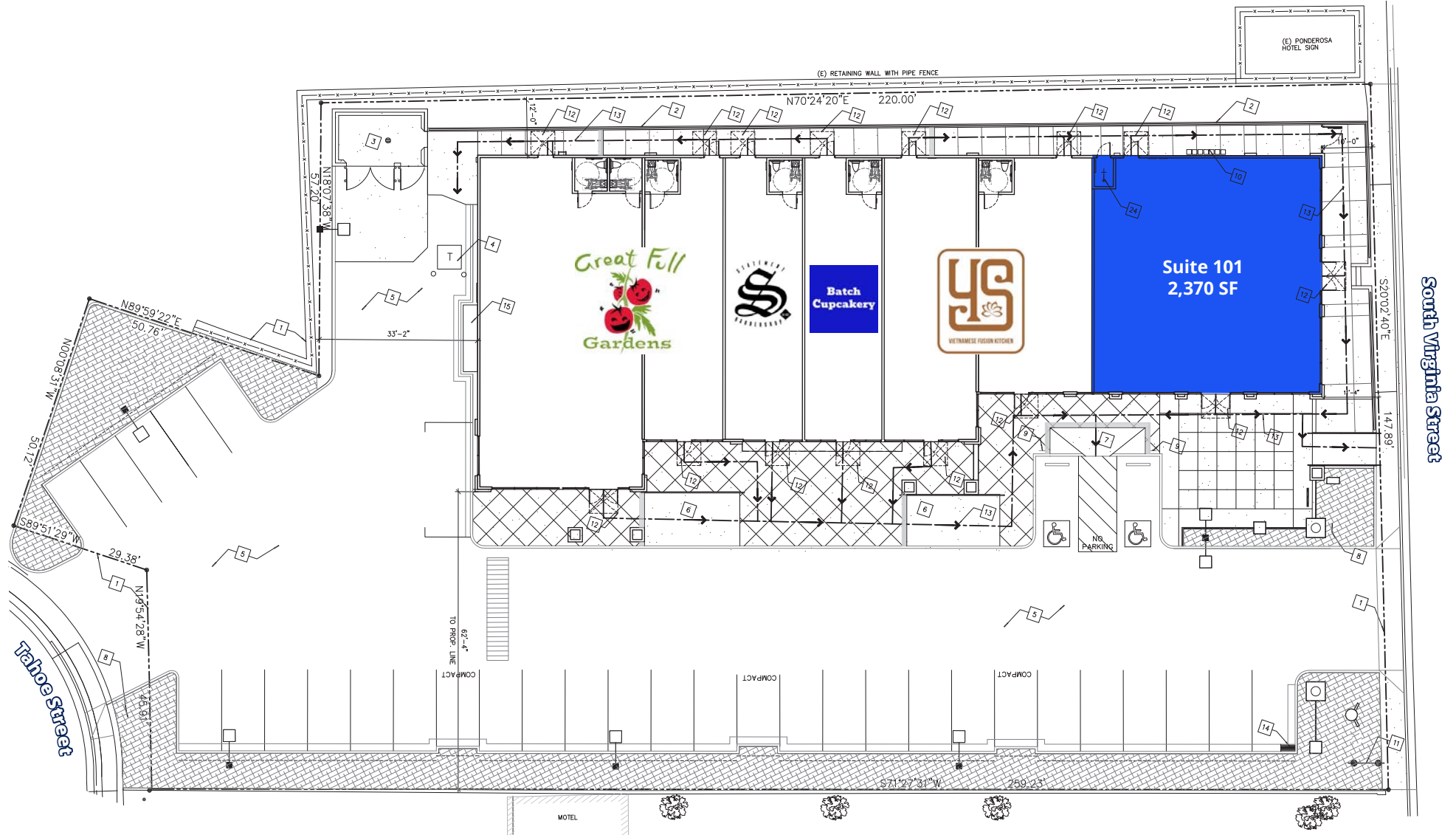

Available for Lease

© 2026 Colliers International. Information herein has been obtained from sources deemed reliable, however its accuracy cannot be guaranteed. The user is required to conduct their own due diligence and verification.



Suite 101 - 2,370 SF End Cap with Patio



Available for Lease



Available for Lease

© 2026 Colliers International. Information herein has been obtained from sources deemed reliable, however its accuracy cannot be guaranteed. The user is required to conduct their own due diligence and verification.





Available for Lease

© 2026 Colliers International. Information herein has been obtained from sources deemed reliable, however its accuracy cannot be guaranteed. The user is required to conduct their own due diligence and verification.



Traffic Counts

13,800
ADT | S Virginia St

6,450
ADT | Plumas St



VIRGINIA STREET PLAZA

MIDTOWN
DISTRICT | RENO

Restaurants & Bars

- sup
- MOO DANG
- My Favorite Muffin
- EMERSON
- Cherry's
- FLORIAN'S
- Pottery
- Too Cute
- JO STELLA
- Great Fall
- LAUGHING PLANET
- WHEELS & TAP
- WHEELS & TAP
- WHEELS & TAP
- WHEELS & TAP

Services

- THE ABBY KONGO
- LS
- TDC
- Sierra Nevada
- BUYER'S AGENT
- EYEZONE
- GORELICK

Shopping

- THE FRAMERY
- CRYSTAL COURT
- MY D&B & grace
- N
- THE MASSA HOUSE
- Good Deals on Wheels
- hello yoga
- RECYCLED TAP
- BLACK HOLE
- STATEWIDE LIGHTS & ACCENTS
- JANKEE
- BLACK HOLE

Health, Wellness & Beauty

- Shine dance
- RENO
- EVOLUTION TATTOO
- AU SALON
- blüm
- BLACK HOLE

Available for Lease

© 2026 Colliers International. Information herein has been obtained from sources deemed reliable, however its accuracy cannot be guaranteed. The user is required to conduct their own due diligence and verification.



Population	1 Miles	3 Miles	5 Miles
2025 Est. Population	21,714	137,997	246,647
2030 Proj. Population	23,136	142,743	255,159
2025 Med. Age	41.6	35.6	36.5
Daytime Population	45,958	183,733	306,670

Household Income	1 Miles	3 Miles	5 Miles
2025 Est. Avg. HH Income	\$89,248	\$88,846	\$100,798
2030 Proj. Avg. HH Income	\$99,935	\$98,894	\$112,034
2025 Est. Med. HH Income	\$57,553	\$62,280	\$72,160
2030 Proj. Med. HH Income	\$65,837	\$70,752	\$81,029
2025 Est. Per Capita Income	\$49,416	\$38,811	\$42,495

Household	1 Miles	3 Miles	5 Miles
2025 Est. HH	12,063	59,989	103,911
2030 Proj. HH	13,003	62,679	108,549
Avg. HH Size	1.76	2.21	2.31

Consumer Expenditure	1 Miles	3 Miles	5 Miles
Annual HH Budget	\$78,139	\$77,805	\$87,788
Annual Retail Goods	\$24,456	\$24,487	\$27,777

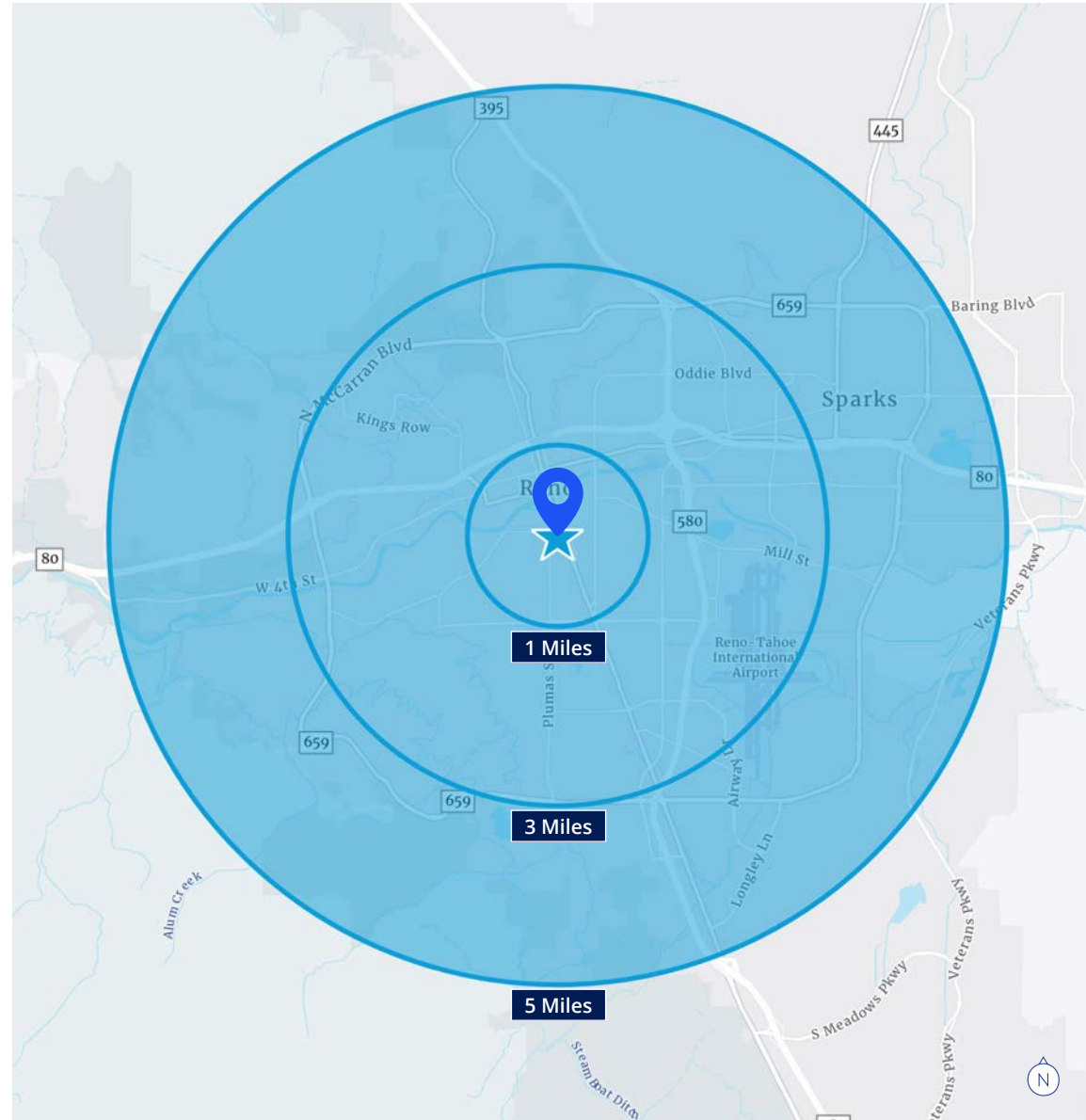

Available for Lease

Reno-Sparks MSA Facts & Demographics

588,069
Population

2.48
Avg HH Size

\$121,655
Avg HH Income

39.5
Median Age

Home Ownership (2025 Housing Units)



Employment

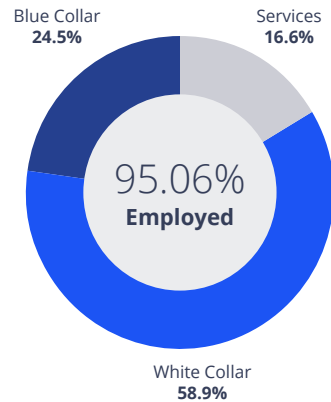

Household Spending

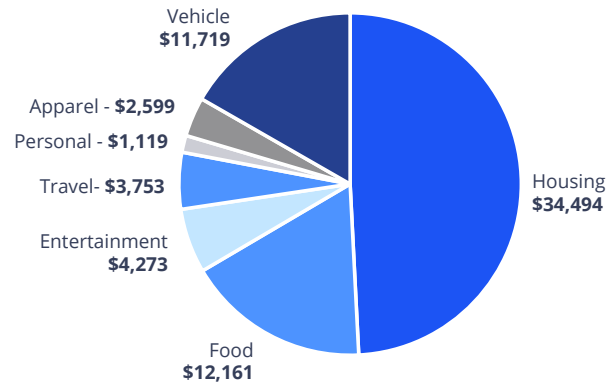

Race & Ethnicity (2025) - % of total population

White	62.97
Black/African American	2.55
American Indian/Alaska Native	1.89
Asian	6.03
Pacific Islander	0.70
Other Race	12.12
Multiple Races	13.73
Hispanic (any race)	25.95

Age Distribution (2025) - % of total population

50.97% Men 49.03% Women

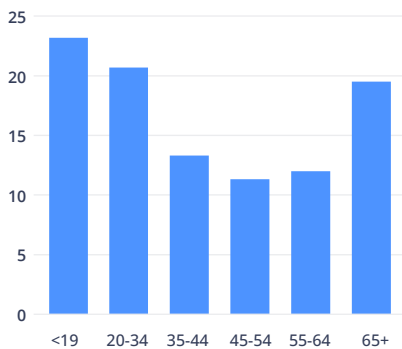

Education (Population Age 25+)

4.35%
Less than 9th Grade

5.71%
9th - 12th Grade, No Diploma

20.34%
High School Graduate

4.36%
GED/Alternative Credential

21.47%
Some College, No Degree

9.77%
Associate Degree

21.12%
Bachelor's Degree

12.87%
Graduate/Professional Degree



Virginia Street Plaza

Smith Retzloff Retail Team

Shannon Leonard

Associate
+1 775 413 9026
shannon.leonard@colliers.com
CA Lic 02146615

Shawn Smith

Executive Vice President
+1 775 823 4667
shawn.smith@colliers.com
CA Lic 01986877

Sean Retzloff

Senior Vice President
+1 775 823 6621
sean.retzloff@colliers.com
CA Lic 02025190



Accelerating success.

Colliers Reno

5520 Kietzke Lane, Suite 300
Reno, NV 89511
Colliers.com/Reno