



SE COMMERCE PARK | FOR LEASE

8707 POLE RD., OKLAHOMA CITY, OK

BRETT PRICE, CCIM, SIOR
bprice@newmarkrp.com
C: 405.613.8380

KRIS DAVIS, SIOR
kgdavis@newmarkrp.com
C: 405.202.9525

KARLEY HARPER
kharper@newmarkrp.com
C: 405.371.3498



BLUE ROAD INVESTMENTS

NEWMARK
ROBINSON PARK

8707 POLE RD. / FOR LEASE

DETAILS

Available SF	181,008 SF±
Lease Rate	Contact Broker
Building Size	181,008 SF±
Lot Size	27 Acres±
Zoning	I-3
Building Completion	Nov. 2022
Cross Streets	SE 89th & Pole Rd.

HIGHLIGHTS

Cross-dock (40 dock doors)	60' speed bay
1,965 SF office space	4 pit levelers
4 drive-in doors	180' truck court
32' clear height	56 trailer parks 112 car parks
54' x 56' column spacing	Divisible to 79,701 SF±

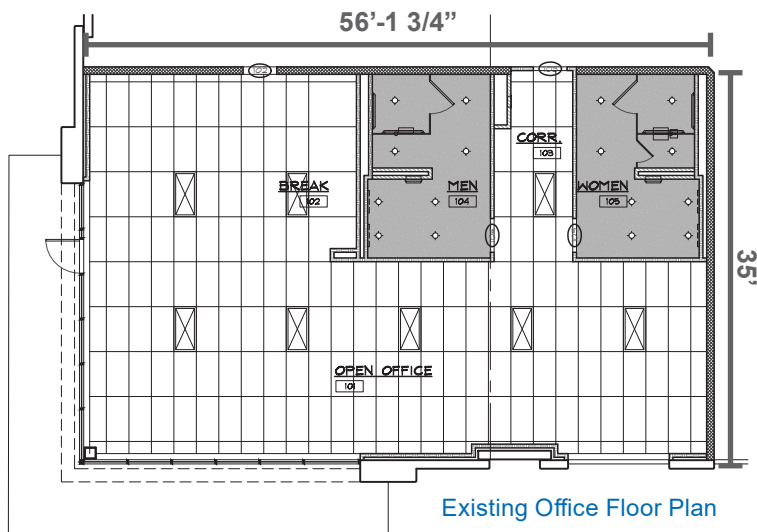

PROPERTY OVERVIEW

Southeast Commerce Park is a master planned industrial park with 3 buildings totaling 403,791 SF. It is located 1/2 mile east of I-35 and 1 mile south of I-240, which connects southeast Oklahoma City to Will Rogers World Airport. The development is within a 10 minute drive time to Tinker Air Force Base, Will Rogers World Airport, and Downtown Oklahoma City. Tenants in the transportation and logistics industries are well-served in this submarket by the Fed Ex Freight facility as well as one of BNSF's four logistics centers throughout the country.

