

FOR SALE

1110 CALLE IGLESIA, SAN CLEMENTE

±8,200 SF FREESTANDING INDUSTRIAL BUILDING



PROPERTY FEATURES

- ±8,200 SF Freestanding Industrial Building
- ±2,000 SF of Office
- 1 GL Door
- 400 Amps - 120/208v 3p4w
- 18' Clear Height
- Sprinklers - 0.58GPM/2,000 Sq.ft
- Private Yard
- 2.68:1,000 Parking Ratio
- Built in 2004
- 28,575 SF Parcel (0.66 AC)
- **Asking: \$4,500,000**

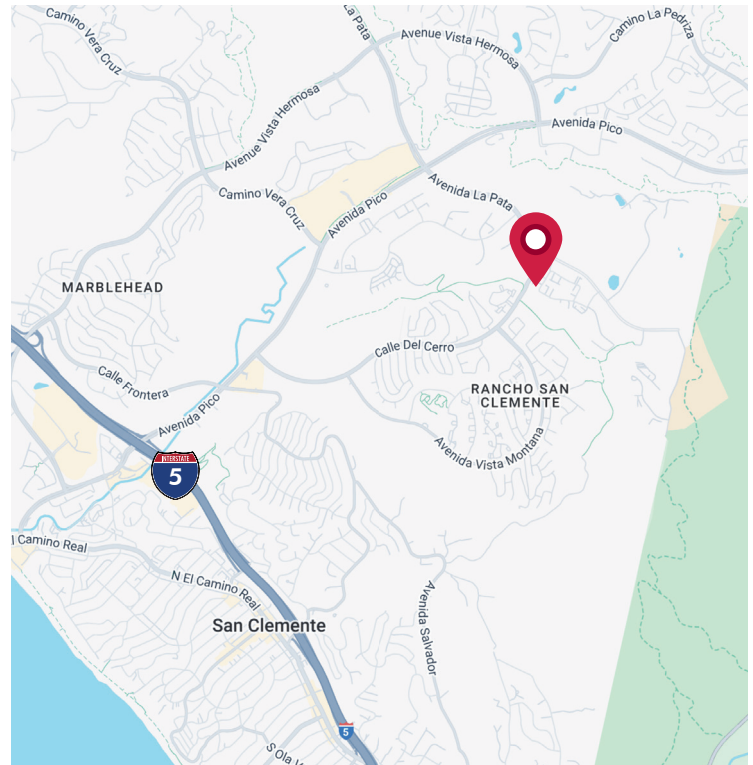

ZACH SCHWANER
Senior Vice President
License ID# 02009623
949.790.3159
zschwaner@leeirvine.com

JASON HELMICK
Senior Vice President
License ID# 01786729
949.790.3119
jhelmick@leeirvine.com

DALE CAMERA
Senior Vice President
License ID# 01313921
949.790.3132
dcamera@leeirvine.com

DYLAN DAVEY
Associate
License ID# 02219560
949.790.3162
ddavey@leeirvine.com

LEE & ASSOCIATES
COMMERCIAL REAL ESTATE SERVICES

ORANGE COUNTY INDUSTRIAL

FOR SALE

110 CALLE IGLESIA, SAN CLEMENTE

±8,200 SF FREESTANDING INDUSTRIAL BUILDING



ZACH SCHWANER
Senior Vice President
License ID# 02009623
949.790.3159
zschwaner@leeirvine.com

JASON HELMICK
Senior Vice President
License ID# 01786729
949.790.3119
jhelmick@leeirvine.com

DALE CAMERA
Senior Vice President
License ID# 01313921
949.790.3132
dcamera@leeirvine.com

DYLAN DAVEY
Associate
License ID# 02219560
949.790.3162
ddavey@leeirvine.com



FOR SALE

110 CALLE IGLESIA, SAN CLEMENTE

±8,200 SF FREESTANDING INDUSTRIAL BUILDING

FLOORPLAN

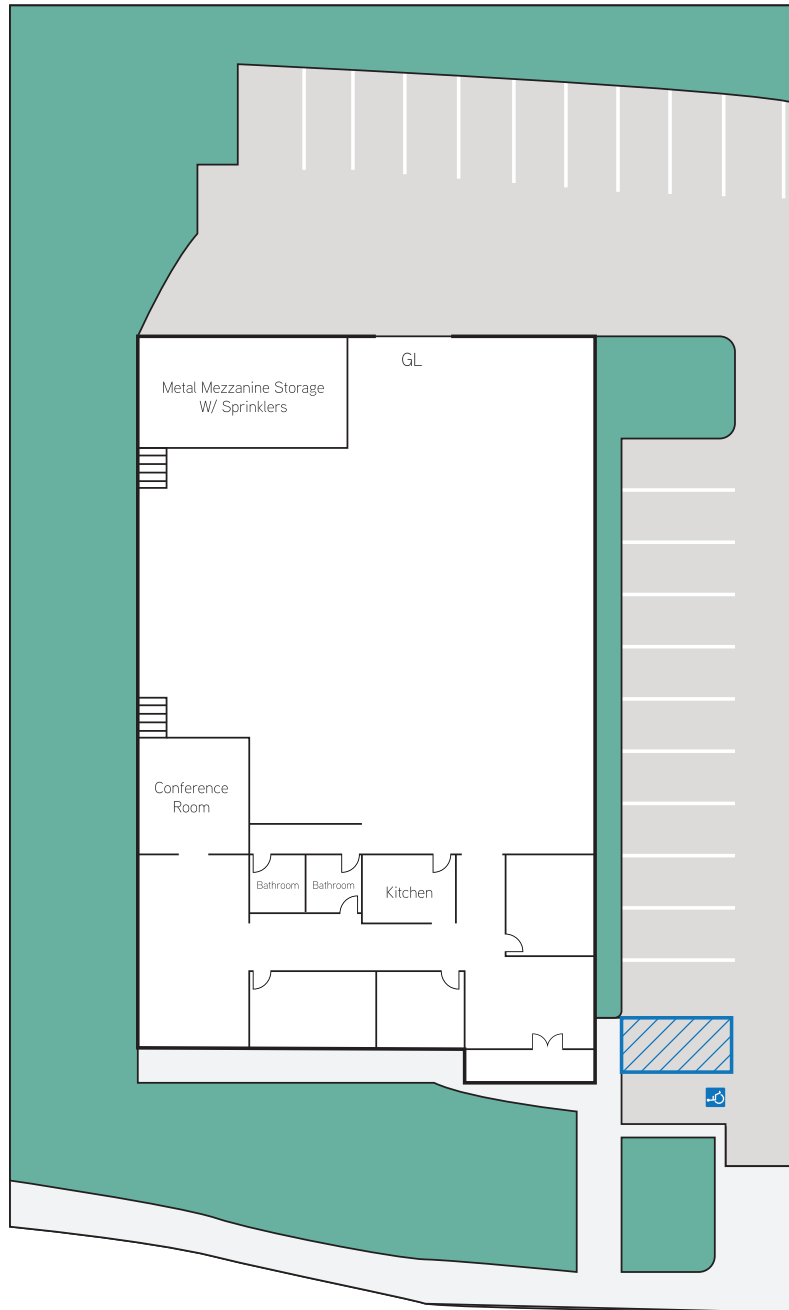

ZACH SCHWANER
Senior Vice President
License ID# 02009623
949.790.3159
zschwaner@leeirvine.com

JASON HELMICK
Senior Vice President
License ID# 01786729
949.790.3119
jhelmick@leeirvine.com

DALE CAMERA
Senior Vice President
License ID# 01313921
949.790.3132
dcamera@leeirvine.com

DYLAN DAVEY
Associate
License ID# 02219560
949.790.3162
ddavey@leeirvine.com

