

**FOR LEASE**

811 Connecticut Avenue

Roanoke, Virginia



**OFFICE | WAREHOUSE**  
**10,035 SF**



CUSHMAN &  
WAKEFIELD

**THALHIMER**



# SITE & BUILDING SPECS

811 Connecticut Avenue, NE, Roanoke, Virginia 24012



**AVAILABLE IMMEDIATELY**

<b>Space Available:</b>	10,035 SF AVAILABLE
<b>Office Area:</b>	3 offices plus conference room and open office
<b>Building Exterior:</b>	Attractive entrance, metal frame signage opportunity
<b>Clear Height:</b>	22'
<b>Loading:</b>	Drive in sales/service entrance
<b>Parking:</b>	22 parking spaces
<b>Zoning:</b>	I-1
<b>Power</b>	3 phase power
<b>Lighting:</b>	LED
<b>Loading:</b>	Drive in sales/service entrance, 12' drive-in door, 9' dock door
<b>Sprinkler:</b>	Yes
<b>Description:</b>	Heated warehouse space (a portion is temperature controlled)
<b>Lease Rate:</b>	Contact Agent



# OVERVIEW



**Rare Industrial  
Warehouse  
Opportunity**

# FLOOR PLAN

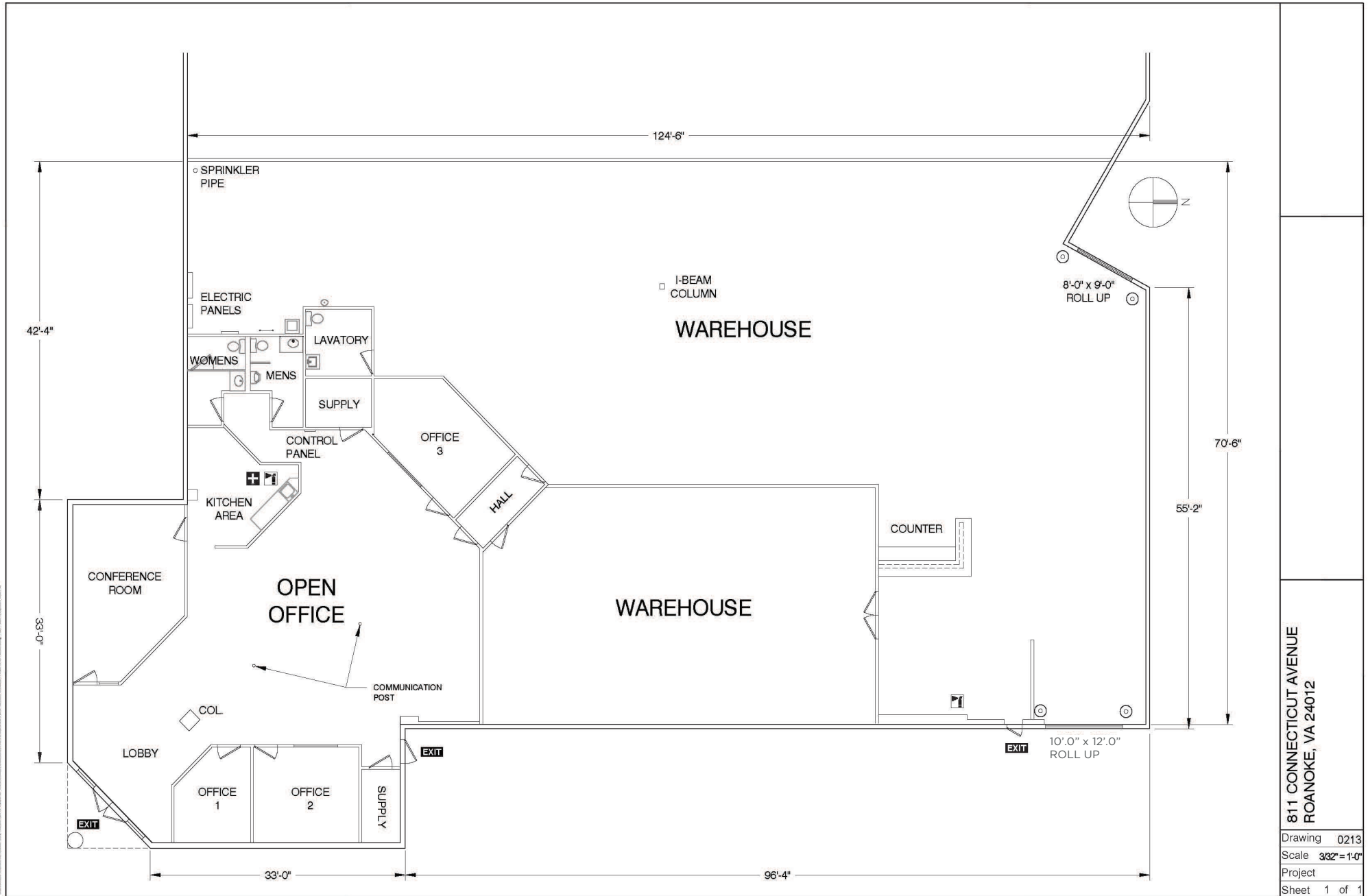

811 CONNECTICUT AVENUE  
ROANOKE, VA 24012

Drawing	0213
Scale	3/32" = 1'-0"
Project	
Sheet	1 of 1



# AERIAL



Carilion Roanoke Community Hospital

Elmwood Park

Downtown Roanoke

INTERSTATE  
581

460

811 CONNECTICUT

460





10,035 SF OFFICE/WAREHOUSE FOR LEASE

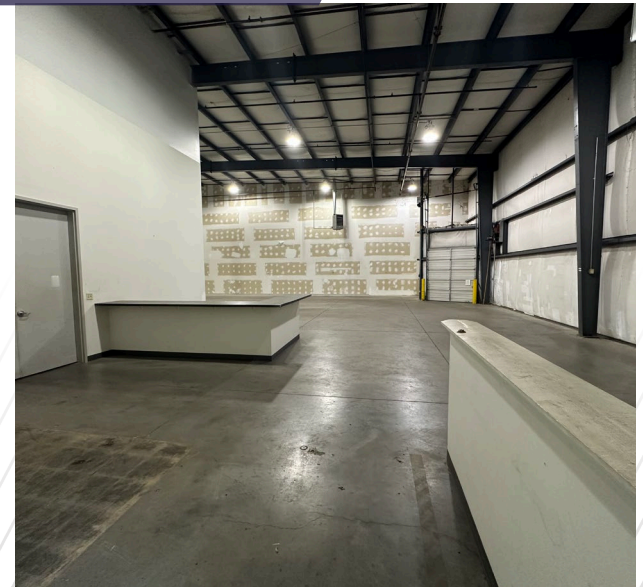



# LOCATION

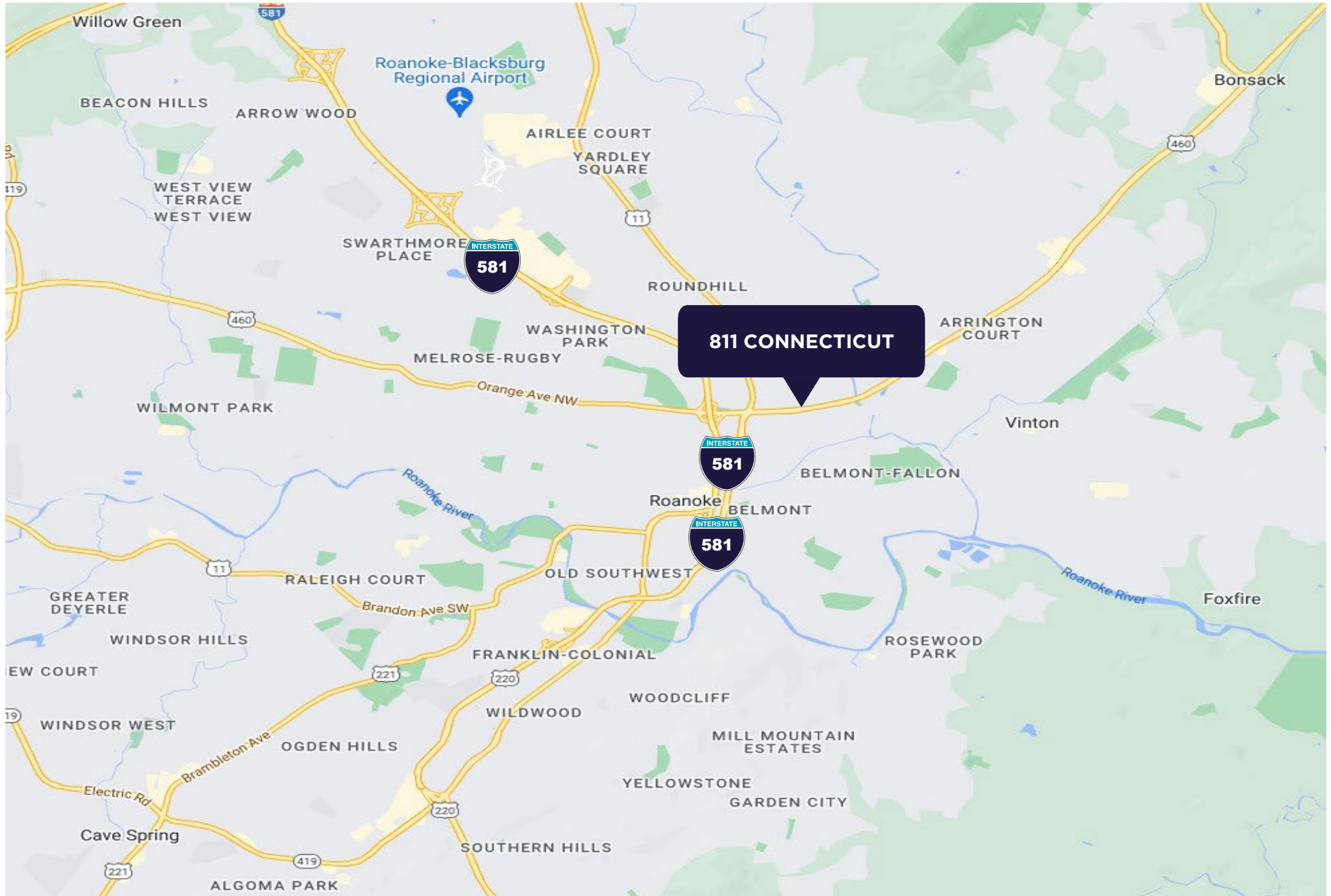





**THALHIMER**

## CONTACT

DAVIS STONEBURNER

Vice President

540 767 3006

[davis.stoneburner@thalhimer.com](mailto:davis.stoneburner@thalhimer.com)

PRICE GUTSHALL

Vice President

540 767 3011

[price.gutshall@thalhimer.com](mailto:price.gutshall@thalhimer.com)

Thalhimer

310 First Street, Suite 300

Roanoke, VA 24011

[thalhimer.com](http://thalhimer.com)

Independently Owned and Operated / A Member of the Cushman & Wakefield Alliance

Cushman & Wakefield | Thalhimer © 2025. No warranty or representation, express or implied, is made to the accuracy or completeness of the information contained herein, and same is submitted subject to errors, omissions, change of price, rental or other conditions, withdrawal without notice, and to any special listing conditions imposed by the property owner(s). As applicable, we make no representation as to the condition of the property (or properties) in question.