

NEW RETAIL IN KEETOWN LOOP DISTRICT

2856 GRAND
PRAIRIE PKWY

WAUKEE, IOWA



KEETOWN
loop

CBRE



PROPERTY SUMMARY

Newly built retail/office space located within the KeeTown Loop District in one of Des Moines metros fastest growing suburbs. The property offers modern and versatile spaces that can be customized to fit your business needs. It is located in a thriving community ensuring high visibility and foot traffic.

PROPERTY OVERVIEW

Available Space:	Suite 120* - 2,478 SF Suite 140* - 1,499 SF *Can be combined for 3,977 SF
Lease Rate:	\$30.00/SF
Lease Type:	NNN
Tenant Improvement Allowance:	Negotiable
Bay Width:	Suite 120 - 38' Suite 140 - 23' 6"
Location:	Neighbors Aloft Hotel, Starbucks, McDonalds & Live Nation's Vibrant Music Hall in Waukee's KeeTown Loop District



42,349
HOUSEHOLDS &
\$156,092
AVERAGE HOUSEHOLD
INCOME WITHIN 5 MILES



106,192 RESIDENTS
WITHIN 5 MILES
2.39%
ESTIMATED POPULATION
GROWTH RATE
2024 - 2028

PROPERTY PHOTOS



PROPERTY FLOOR PLAN

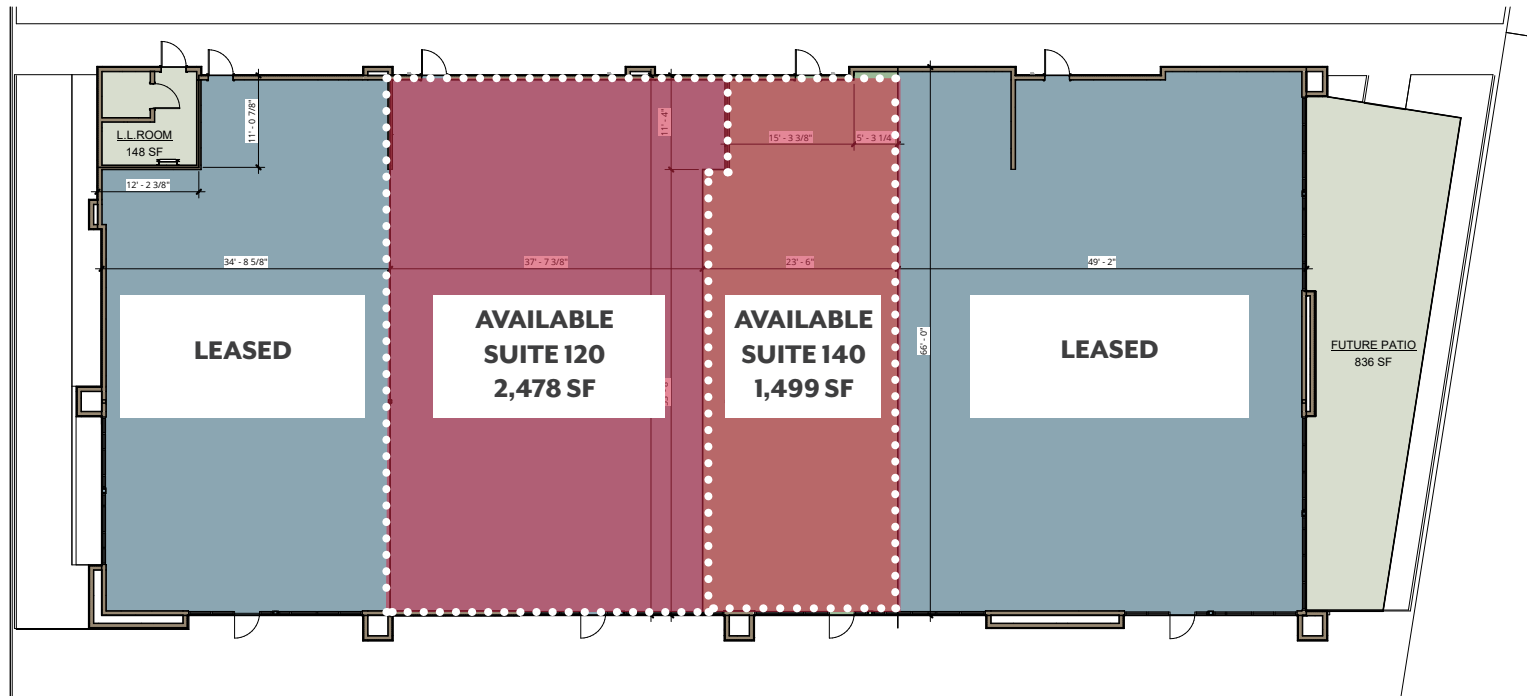

2856 GRAND PRAIRIE PKWY

WAUKEE, IOWA

CONTACT US

AJDIN NADAREVIC

Senior Vice President

+1 515 415 6114

ajdin.nadarevic@cbre.com

Licensed in the State of Iowa

BEN PROBST

Senior Associate

+1 515 415 6108

ben.probst@cbre.com

Licensed in the State of Iowa

© 2024 CBRE, Inc. All rights reserved. This information has been obtained from sources believed reliable, but has not been verified for accuracy or completeness. You should conduct a careful, independent investigation of the property and verify all information. Any reliance on this information is solely at your own risk. CBRE and the CBRE logo are service marks of CBRE, Inc. All other marks displayed on this document are the property of their respective owners, and the use of such logos does not imply any affiliation with or endorsement of CBRE. Photos herein are the property of their respective owners. Use of these images without the express written consent of the owner is prohibited.

