

8060 NORTH GLADE AVENUE

OKLAHOMA CITY, OK 73132



±3,000 RSF

\$2,340 / month (Total Includes NNN's)

PROPERTY HIGHLIGHTS

- 3,000/SF available (south half)
- 400 SF office (2 offices, reception and restroom)
- Building sits on the end of a quiet Cul-de-sac
- Central HVAC in office
- No columns providing clear span usable warehouse space
- 12'x14' overhead door (12' wide x 14' high)
- 21' height in center of building
- 7 total building on the cul-de-sac
- Three phase electric
- Concrete drive and concrete parking lot
- Skylights in the warehouse provide ample, free light
- Local, responsive ownership
- Zoning: I-2
- New LED lights in warehouse
- Owner agent

LOCATION DESCRIPTION

Located south of NW Expressway & Rockwell Ave. and north of Wilshire. About 5 minutes east of John Kilpatrick Turnpike.

Wiley Post Airport is a few blocks south of the property

OFFERING SUMMARY

Available SF:	±3,000 RSF
----------------------	------------

Lease Rate:	\$7.50 / SF + \$1.86 / SF NNN (\$2,340 / total monthly)
--------------------	--

TOM FIELDS

tfields@priceedwards.com

O: 405.239.1205 C: 405.641.0598

8060 NORTH GLADE AVENUE

OKLAHOMA CITY, OK 73132

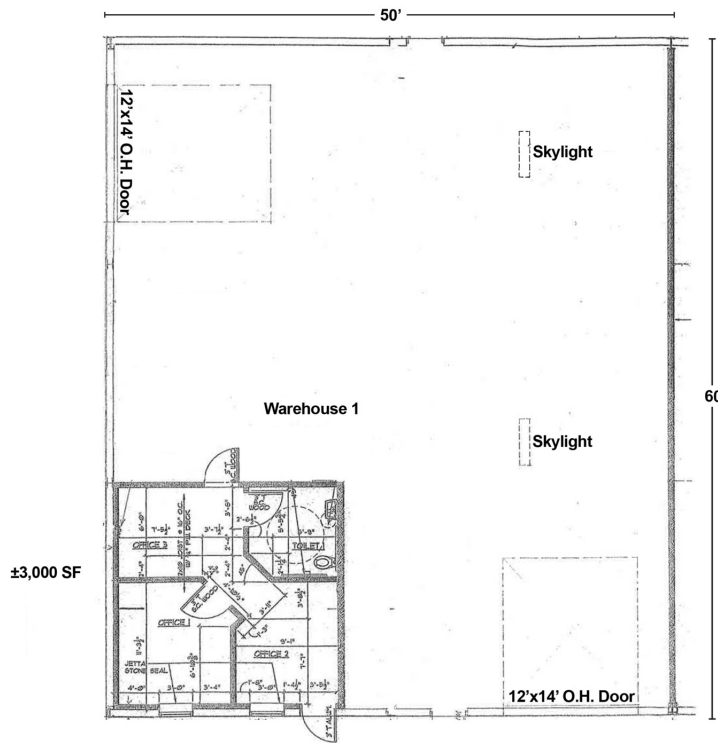

TOM FIELDS

tfields@priceedwards.com

O: 405.239.1205 C: 405.641.0598