

PROPERTY FEATURES

FOR LEASE

1255 E. HIGHLAND AVE. SUITE 101 SAN BERNARDINO, CA 92404



SUITE SIZE:
±2,524 sq.ft.



PARCELS
APN'S: 0147-251-15



ZONING
General Commercial (CG-1) per
the City of San Bernardino, CA

PROPERTY HIGHLIGHTS

- ±2,524 sq.ft. Office Space
- 3 Private Offices
- Breakroom
- 4/1,000 SF Parking Ratio
- Available Monument Signage
- Traditional Office & Medical Uses Allowed (verify)
- Frontage on Highland Ave. (±22,000 Vehicles Daily)
- Close Proximity with Great Access to 210 Freeway from Del Rosa Ave. On/Off Ramps, and Minutes to I-215 Freeway



**INLAND
EMPIRE**

CAL DRE # 02120868

KW COMMERCIAL
3595-1 Inland Empire
Blvd. Suite 1250
Ontario, CA 91764
909.980.6868

Rene Ramos, Jr.
909.980.6868
Rene.Ramos@kwcommercial.com
CalDRE Lic. #01836872

Jacob Bernardy
909.935.0935
Jacob.Bernardy@kwcommercial.com
CalDRE Lic. #02039512

Robert D. Bagley III
909.935.0938
Robert.Bagley@kwcommercial.com
CalDRE Lic. #02228061

WE OBTAINED THE INFORMATION ABOVE FROM SOURCES WE BELIEVE TO BE RELIABLE. HOWEVER, WE HAVE NOT VERIFIED ITS ACCURACY AND MAKE NO GUARANTEE, WARRANTY, OR REPRESENTATION ABOUT IT. IT IS SUBMITTED SUBJECT TO THE POSSIBILITY OF ERRORS, OMISSIONS, CHANGE OF PRICE, RENTAL OR OTHER CONDITIONS, PRIOR SALE, LEASE OR FINANCING, OR WITHDRAWAL WITHOUT NOTICE. WE INCLUDE PROJECTIONS, OPINIONS, ASSUMPTIONS OR ESTIMATES FOR EXAMPLE ONLY, AND THEY MAY NOT REPRESENT CURRENT OR FUTURE PERFORMANCE OF THE PROPERTY. YOU AND YOUR TAX AND LEGAL ADVISORS SHOULD CONDUCT YOUR OWN INVESTIGATION OF THE PROPERTY AND TRANSACTION.

AERIAL MAP



LOCAL MAP

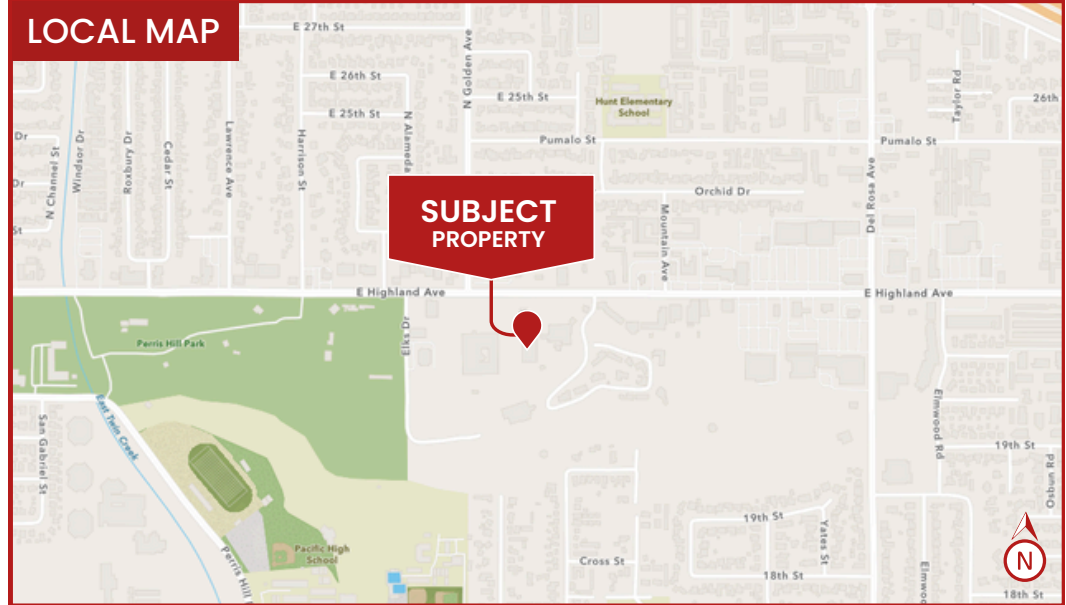

REGIONAL MAP

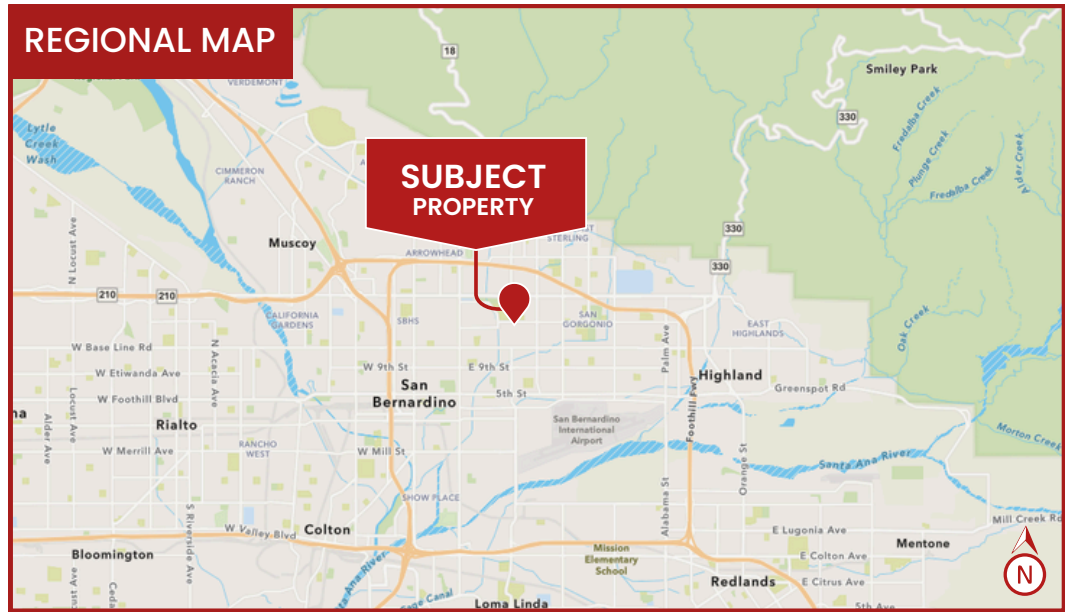

Rene Ramos, Jr.
909.980.6868
Rene.Ramos@kwcommercial.com
CalDRE Lic. #01836872

Jacob B. Bernardy
909.935.0935
Jacob.Bernardy@kwcommercial.com
CalDRE Lic. #02039512

Robert D. Bagley III
909.935.0938
Robert.Bagley@kwcommercial.com
CalDRE Lic. #02131874



CAL DRE # 02120868



Rene Ramos, Jr.
909.980.6868
Rene.Ramos@kwcommercial.com
CalDRE Lic. #01836872

Jacob B. Bernardy
909.935.0935
Jacob.Bernardy@kwcommercial.com
CalDRE Lic. #02039512

Robert D. Bagley III
909.935.0938
Robert.Bagley@kwcommercial.com
CalDRE Lic. #02131874



INLAND
EMPIRE

CAL DRE # 02120868



Rene Ramos, Jr.
909.980.6868
Rene.Ramos@kwcommercial.com
CalDRE Lic. #01836872

Jacob B. Bernardy
909.935.0935
Jacob.Bernardy@kwcommercial.com
CalDRE Lic. #02039512

Robert D. Bagley III
909.935.0938
Robert.Bagley@kwcommercial.com
CalDRE Lic. #02131874



**INLAND
EMPIRE**

CAL DRE # 02120868