



# 1610 MOFFETT STREET

SALINAS, CA

**FOR LEASE**

**6,000 SF - 18,546 SF WAREHOUSE**



# 1610 MOFFETT STREET

Salinas, CA

## PROPERTY HIGHLIGHTS

- Convenient location on the South end of Salinas immediately across from the Salinas Municipal Airport
- Great curb appeal
- Concrete Tilt-up construction
- Easy access to Highway 101 both North & South
- Tenant Improvements negotiable
- Available April 1, 2026

**ASKING : \$1.30 PSF, GROSS**

### PROPERTY FEATURES

Address:	1610 Moffett Street Salinas, Monterey County, CA
AP#:	003-863-022
Year Built:	1995
Lot Size:	2.07 Acres
Zoning:	Industrial Business Park ("IBP")
Fire sprinklers:	Yes
Gross Building Area:	±37,347 SF
Available to Lease:	±6,000 - 18,546 SF
Office:	None
Clear Height:	23 Feet
Parking:	2.14 Spaces per 1,000 SF
Condition:	Excellent
Power:	277V, 3 Phase, 250 amps
Roll Up Doors:	Two roll up doors (12' x 14', 18' x 16')
Warehouse has drop down gas heaters	



**1610 MOFFETT STREET**  
Salinas, CA

**FLOOR  
PLAN**

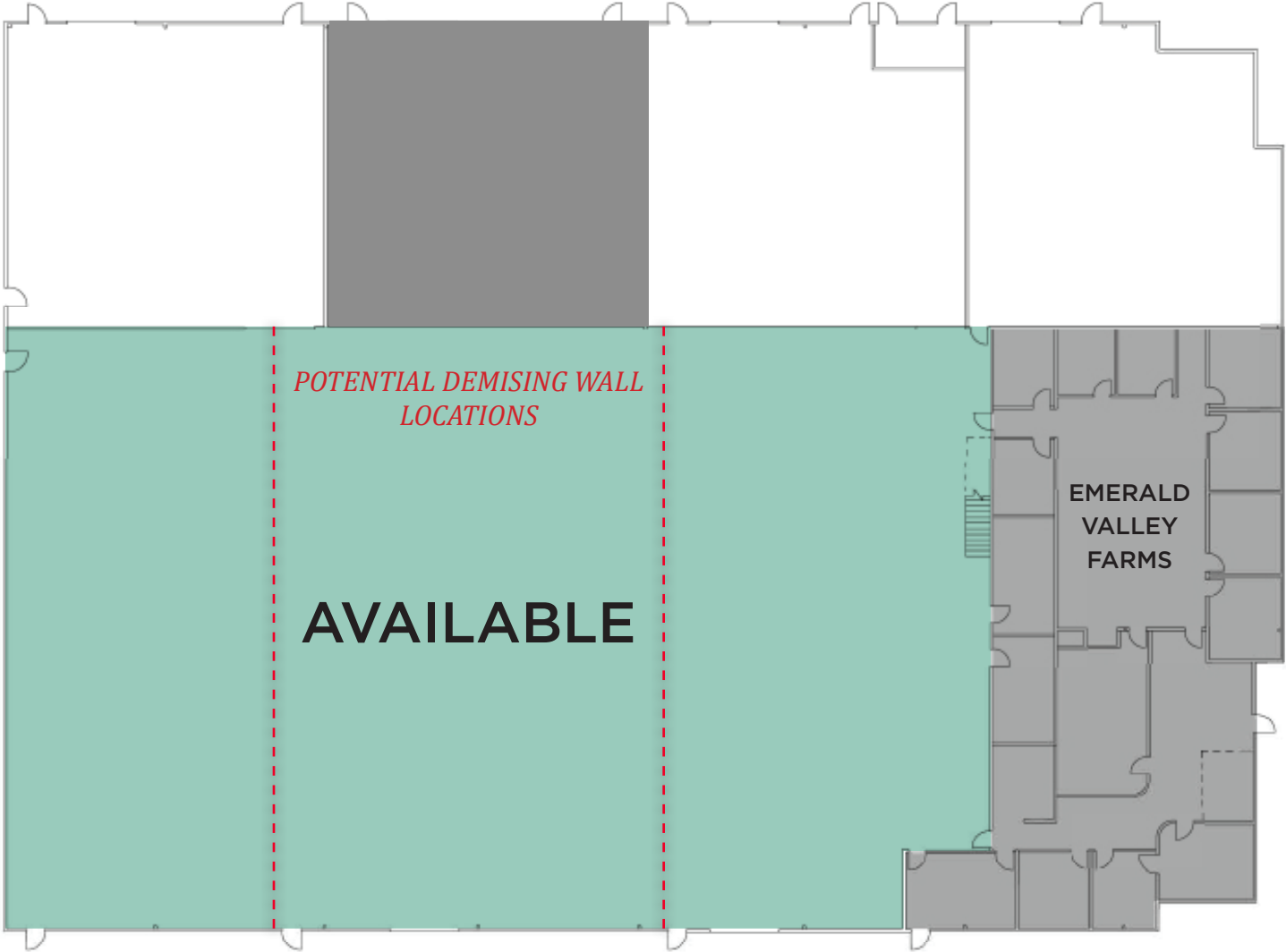



1610 MOFFETT STREET  
Salinas, CA







**FOR MORE INFORMATION, PLEASE CONTACT:**

**GREG FINDLEY**

+1 831 755 1639

[greg.findley@cushwake.com](mailto:greg.findley@cushwake.com)

Lic. #11700453

**MICHAEL BASSETTI**

+1 831 262 1925

[michael.bassetti@cushwake.com](mailto:michael.bassetti@cushwake.com)

Lic. #01422049

**WOODY FENLEY**

+1 831 320 8060

[richard.fenley@cushwake.com](mailto:richard.fenley@cushwake.com)

Lic. #02253434

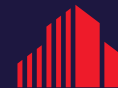

**CUSHMAN &  
WAKEFIELD**

©2025 Cushman & Wakefield. All rights reserved. The information contained in this communication is strictly confidential. This information has been obtained from sources believed to be reliable but has not been verified. NO WARRANTY OR REPRESENTATION, EXPRESS OR IMPLIED, IS MADE AS TO THE CONDITION OF THE PROPERTY (OR PROPERTIES) REFERENCED HEREIN OR AS TO THE ACCURACY OR COMPLETENESS OF THE INFORMATION CONTAINED HEREIN, AND SAME IS SUBMITTED SUBJECT TO ERRORS, OMISSIONS, CHANGE OF PRICE, RENTAL OR OTHER CONDITIONS, WITHDRAWAL WITHOUT NOTICE, AND TO ANY SPECIAL LISTING CONDITIONS IMPOSED BY THE PROPERTY OWNER(S). ANY PROJECTIONS, OPINIONS OR ESTIMATES ARE SUBJECT TO UNCERTAINTY AND DO NOT SIGNIFY CURRENT OR FUTURE PROPERTY PERFORMANCE.