

For Sale

CBRE

# 900 Grier Drive

Las Vegas, NV 89119  
[www.cbre.com/lasvegas](http://www.cbre.com/lasvegas)

Freestanding office building on 0.63 Acres - Minutes from Harry Reid Airport!



**Mike Willmore**  
Senior Associate  
+1 702 369 4823  
[mike.willmore@cbre.com](mailto:mike.willmore@cbre.com)  
Lic. # S.0183520

**Lauren Willmore**  
Senior Associate  
+1 702 369 4825  
[lauren.willmore@cbre.com](mailto:lauren.willmore@cbre.com)  
Lic. # S.0188698

**Kyle Kirchmeier**  
Senior Associate  
+1 702 369 4862  
[kyle.kirchmeier@cbre.com](mailto:kyle.kirchmeier@cbre.com)  
Lic. # S.0197013

**Alex Stanisic, SIOR**  
First Vice President  
+1 702 369 4874  
[alex.stanisic@cbre.com](mailto:alex.stanisic@cbre.com)  
Lic. # S.0179950

## The Offering

Located within Hughes Airport Center, this 11,167 SF single-tenant office building on 0.63 acres at the intersection of Grier Drive and Kelly Johnson Drive offers easy access to ample retail and service amenities, including Town Square, McCarran Marketplace and the Las Vegas South Premium Outlets. Site offers excellent access to Harry Reid International Airport, the I-215/I-15 Interchange and the Las Vegas Strip.

### PROPERTY OVERVIEW

Address	900 Grier Drive, Las Vegas, NV 89119
Market/Submarket	Las Vegas/Airport
Square Footage	11,167 SF
Lot Size	0.63 Acres
Year Built	1988
Occupancy	0%
Annual Operating Expenses	\$187,945.20 (estimated)
Taxes	\$13,976.29

**Sale Price: \$2,900,000.00**

**Price/SF: \$259.69**

## Building Highlights

- + Fully built-out office space with a mix of private offices and open area
- + Twenty-three (23) Private Offices
- + Three (3) Conference Rooms
- + Located next to MGM Resorts Offices and US Post Office
- + Professional monument signage
- + Building has over 55 tons of HVAC
- + Abundant storage space
- + Fully fire sprinklered
- + Two (2) multi-stall restrooms
- + Twenty (20) free covered parking spaces
- + Very secure facility & location
- + Lush, mature landscaping
- + Concrete Tilt-Up Construction
- + Zoned: Industrial Light (IL), Clark County
- + Prime Airport Location
- + APN: 177-03-510-006

**Mike Willmore**  
Senior Associate  
+1 702 369 4823  
mike.willmore@cbre.com  
Lic. # S.0183520

**Lauren Willmore**  
Senior Associate  
+1 702 369 4825  
lauren.willmore@cbre.com  
Lic. # S.0188698

**Kyle Kirchmeier**  
Senior Associate  
+1 702 369 4862  
kyle.kirchmeier@cbre.com  
Lic. # S.0197013

**Alex Stanisic, SIOR**  
First Vice President  
+1 702 369 4874  
alex.stanisic@cbre.com  
Lic. # S.0179950



## SITE PLAN

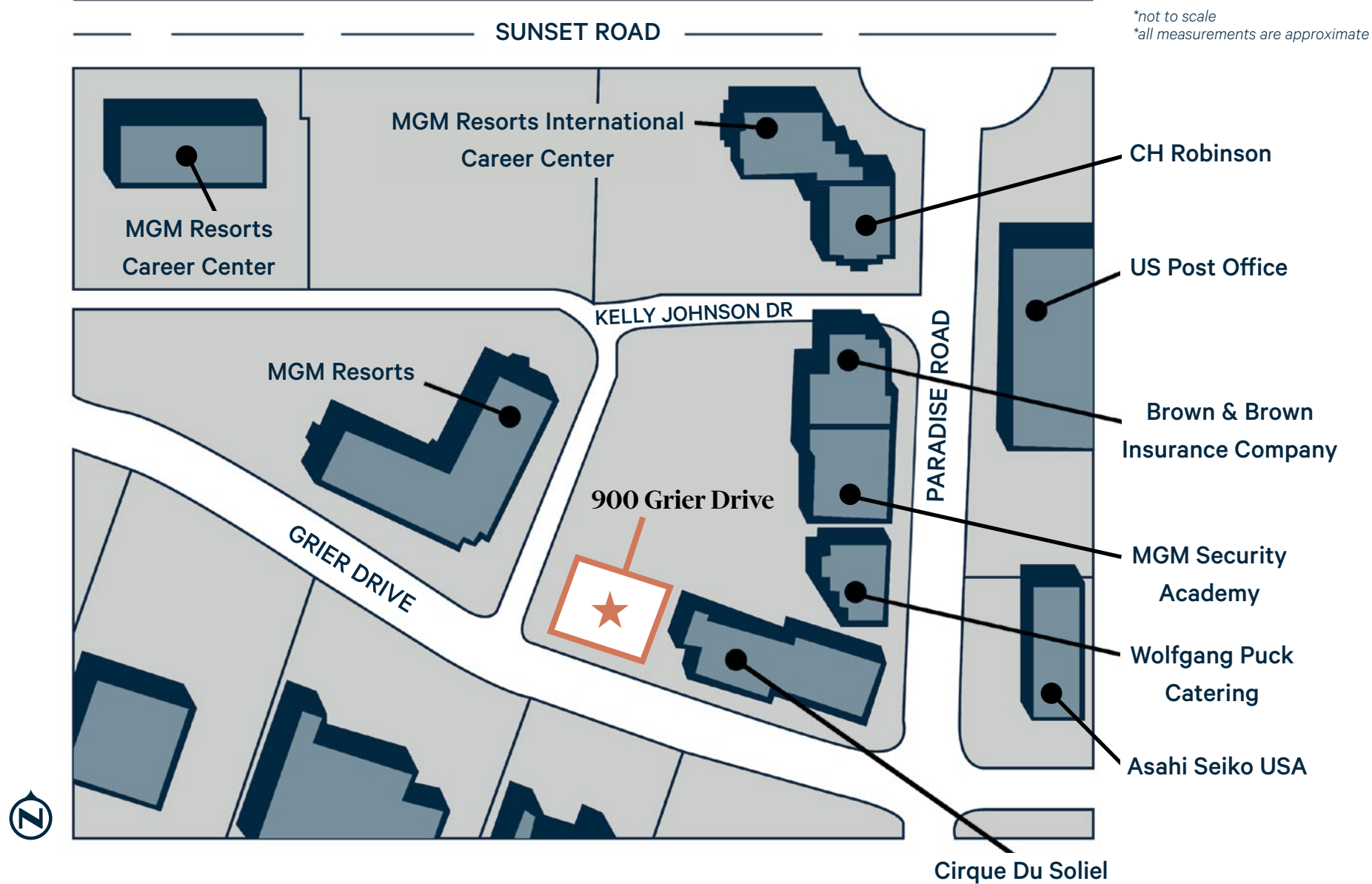

## FLOORPLAN

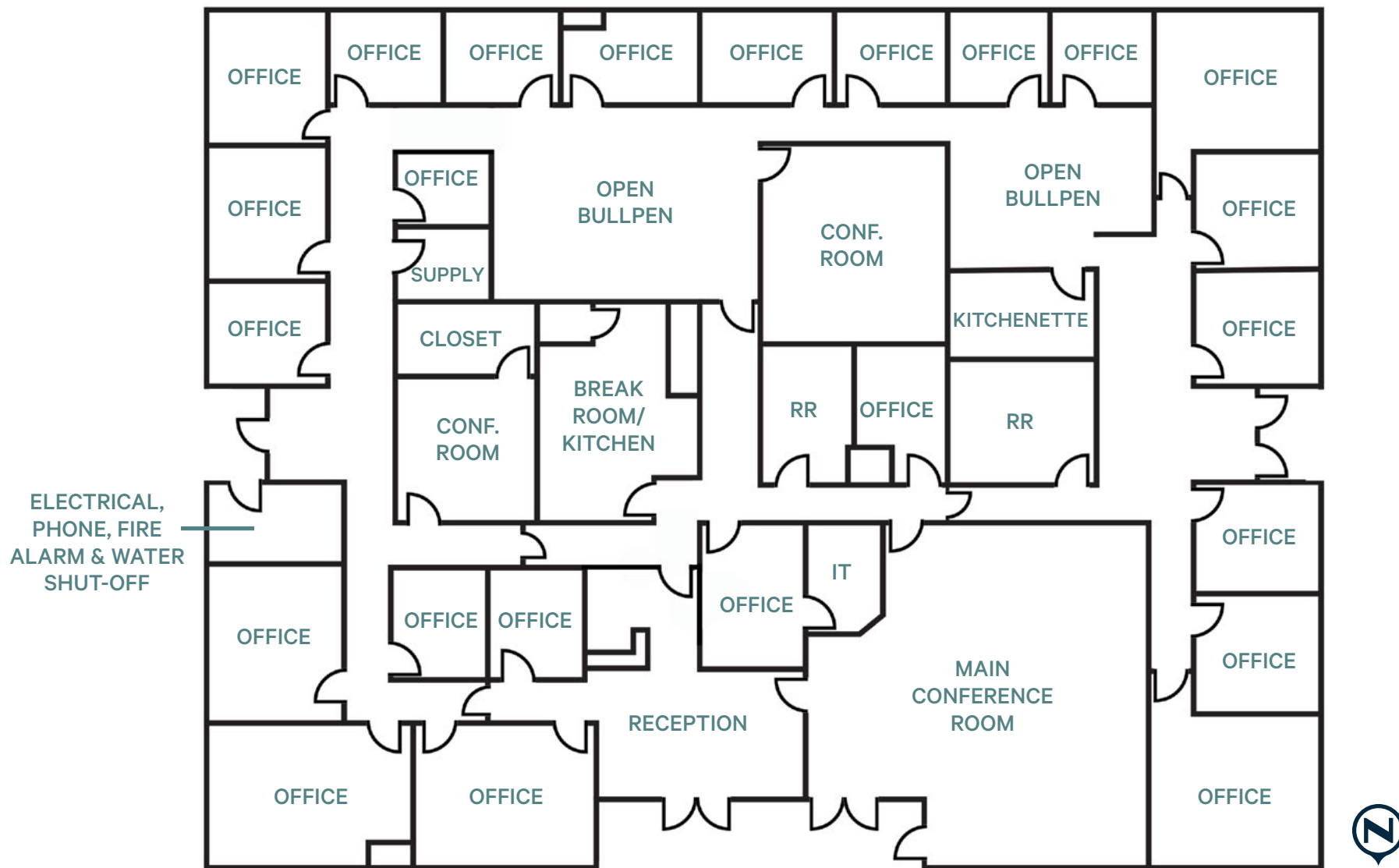

\*not to scale

\*all measurements are approximate

900 Grier Drive  
Las Vegas, NV 89119

For Sale

## PROPERTY PHOTOS



## AERIAL MAP



AERIAL MAP - Low Altitude



**900 Grier Drive**  
Las Vegas, NV 89119

**For Sale**



## Contact Us

**Mike Willmore**  
Senior Associate  
+1 702 369 4823  
mike.willmore@cbre.com  
Lic. # S.0183520

**Lauren Willmore**  
Senior Associate  
+1 702 369 4825  
lauren.willmore@cbre.com  
Lic. # S.0188698

**Kyle Kirchmeier**  
Senior Associate  
+1 702 369 4862  
kyle.kirchmeier@cbre.com  
Lic. # S.0197013

**Alex Stanisic, SIOR**  
First Vice President  
+1 702 369 4874  
alex.stanisic@cbre.com  
Lic. # S.0179950

© 2025 CBRE, Inc. All rights reserved. This information has been obtained from sources believed reliable, but has not been verified for accuracy or completeness. You should conduct a careful, independent investigation of the property and verify all information. Any reliance on this information is solely at your own risk. CBRE and the CBRE logo are service marks of CBRE, Inc. All other marks displayed on this document are the property of their respective owners, and the use of such logos does not imply any affiliation with or endorsement of CBRE. Photos herein are the property of their respective owners. Use of these images without the express written consent of the owner is prohibited.

**CBRE**