

BLDG.
300

FOR LEASE

FREEMPORT CROSSING - BUILDING 3

921 W Bethel Road, Suite 310
Coppell, Texas 75019

±36,870 SF

PROPERTY FEATURES

- 1,220 SF Office Space
- 30' Clear Height
- 8 - Overhead Dock Doors
- 8 - Dock Levelers
- 1 Drive-In Ramp Door
- ESFR Sprinkler System

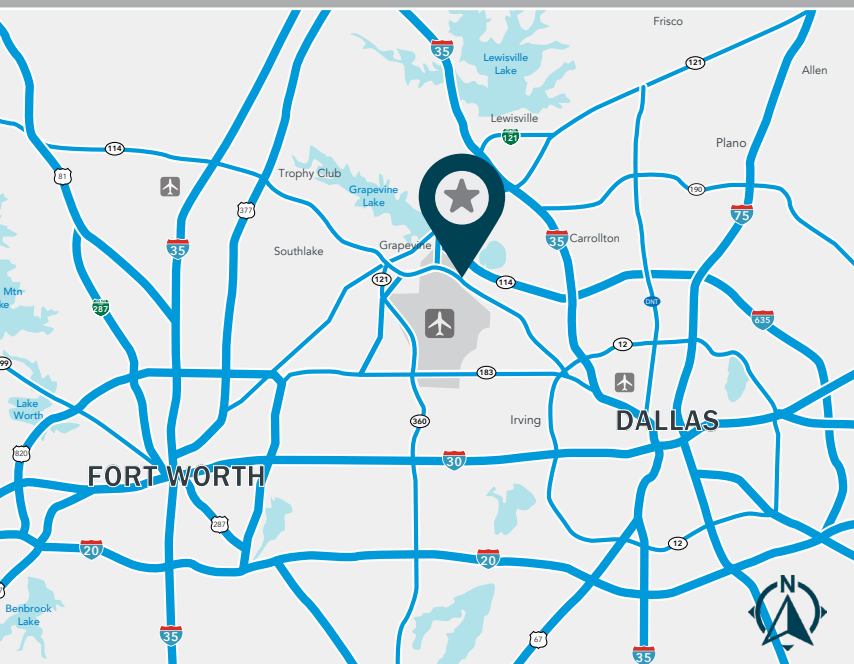

All information furnished regarding property for sale, rental or financing is from sources deemed reliable, but no warranty or representation is made to the accuracy thereof and same is submitted to errors, omissions, change of price, rental or other conditions prior to sale, lease or financing or withdrawal without notice. No liability of any kind is to be imposed on the broker herein.

FOR MORE INFORMATION:

OWNED BY:



KEN WESSON, SIOR, CCIM
469.855.5222
kwesson@lee-associates.com

MARK GRAYBILL, SIOR, CCIM
214.914.5537
mgraybill@lee-associates.com

nuveen
REAL ESTATE

FLOORPLAN

AVAILABLE SPACE

36,870 SF Total
±1,220 SF Office
35,650 Warehouse

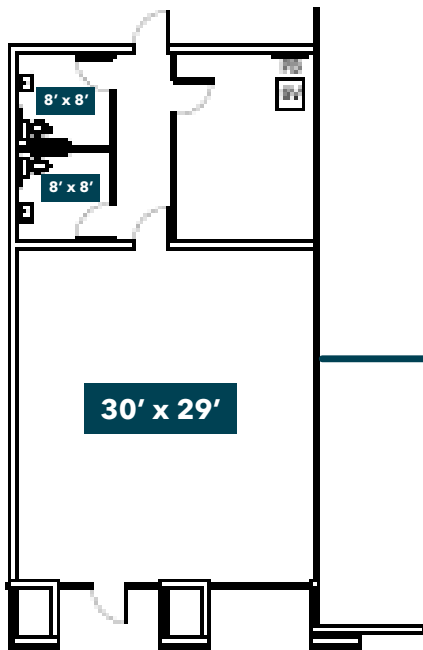

OFFICE SPACE
±1,220 SF

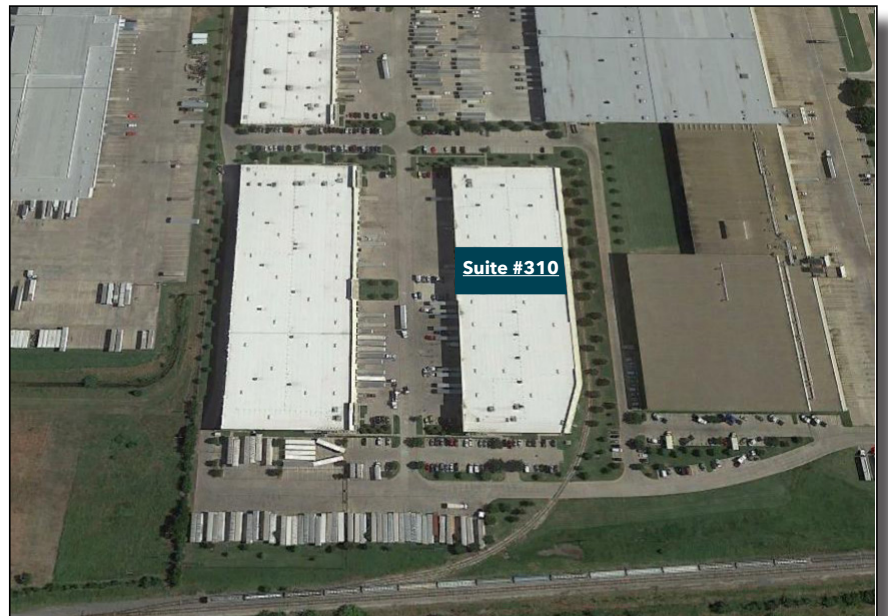
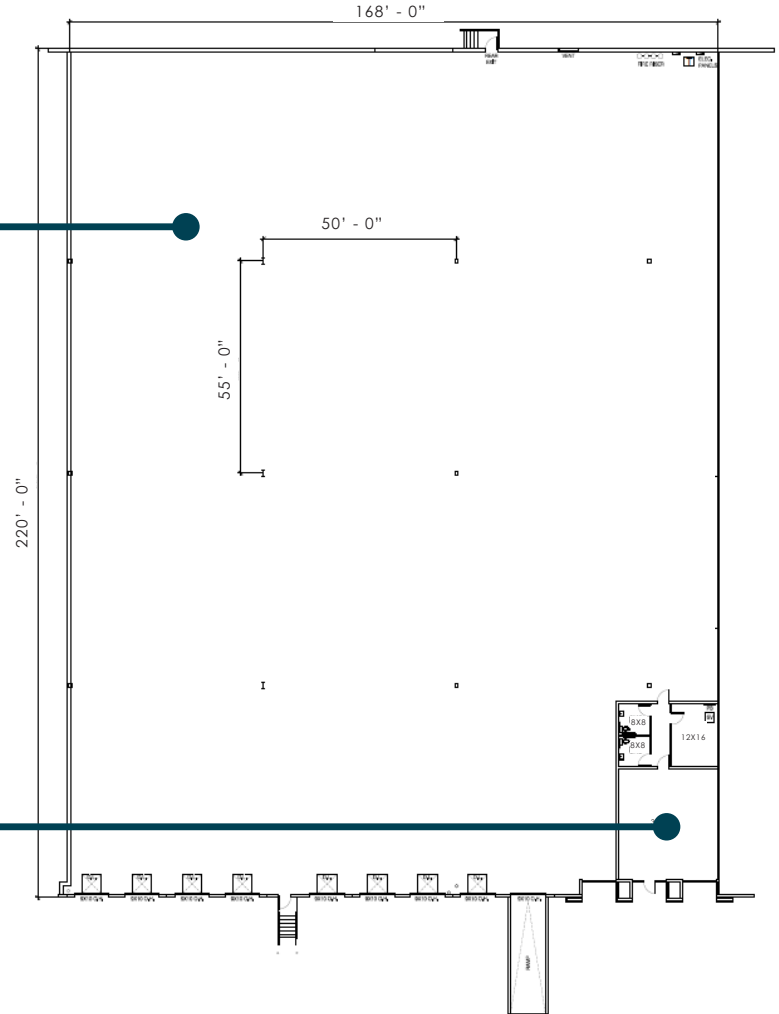

FOR MORE INFORMATION:

OWNED BY: