

# WARREN DRIVE FLEX PARK

## NORCROSS, GA 30093



**3,472 - 7,308 SF**  
**AVAILABLE NOW**

### CONTACT



**Trey Weghorst**  
Senior VP, Partner  
770.264.9420  
tweghorst@apexindustrialre.com



**Morgan McMenamy**  
Director  
404.806.6631  
mmcmenamy@apexindustrialre.com



**APEX INDUSTRIAL**  
REAL ESTATE ADVISORS, LLC



## SUITE 6438

<b>Total Size</b>	3,836 SF
<b>Office</b>	872 SF
<b>Warehouse</b>	2,964 SF
<b>Clear Height</b>	18'
<b>Dock High Door</b>	One (1)

KEY PLAN

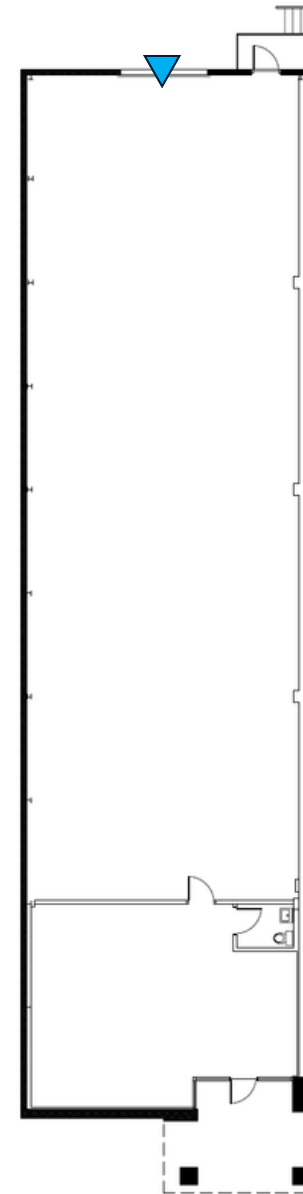

▼ DOCK HIGH DOOR

▼ DRIVE-IN DOOR



## SUITE 6442

**Total Size** 3,472 SF  
*Suite can be combined for total of 7,308 SF*

**Office** 650 SF

**Warehouse** 2,822 SF

**Clear Height** 18'

**Dock High Door** One (1)

KEY PLAN

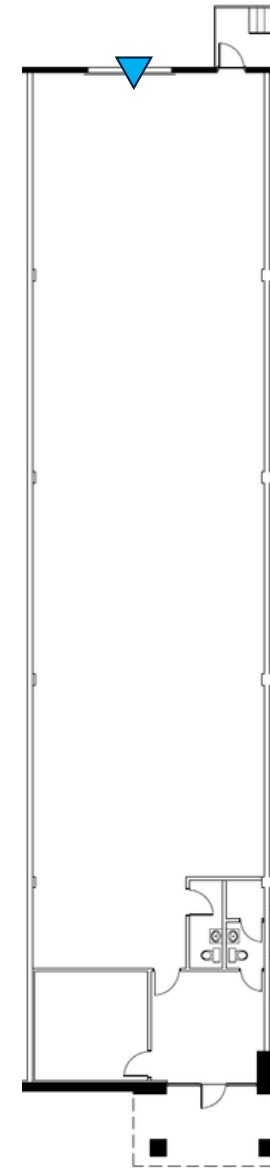

▼ DOCK HIGH DOOR

▼ DRIVE-IN DOOR



# SUITE 6444

**Total Size** 3,856 SF  
*Suite can be combined for total of 7,308 SF*

**Office** 850 SF

**Warehouse** 3,006 SF

**Clear Height** 18'

**Dock High Door** One (1)

KEY PLAN

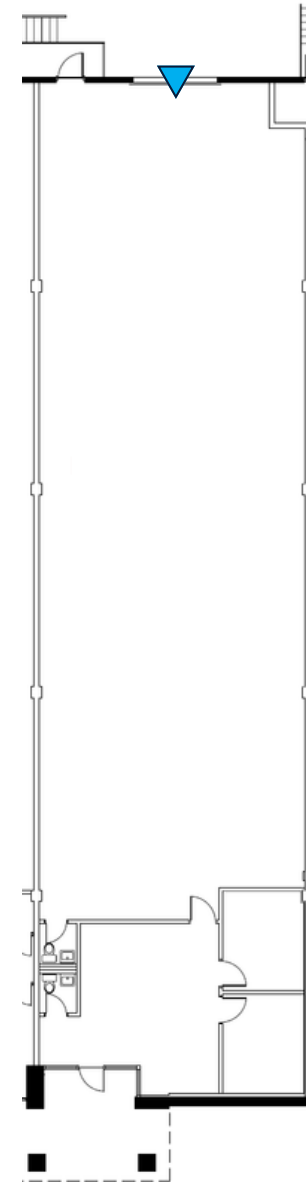

▼ DOCK HIGH DOOR      ▼ DRIVE-IN DOOR



## SUITE 6448

<b>Total Size</b>	8,059 SF
<b>Office</b>	1,015 SF
<b>Warehouse</b>	7,044 SF
<b>Clear Height</b>	18'
<b>Dock High Door</b>	Two (2)

KEY PLAN

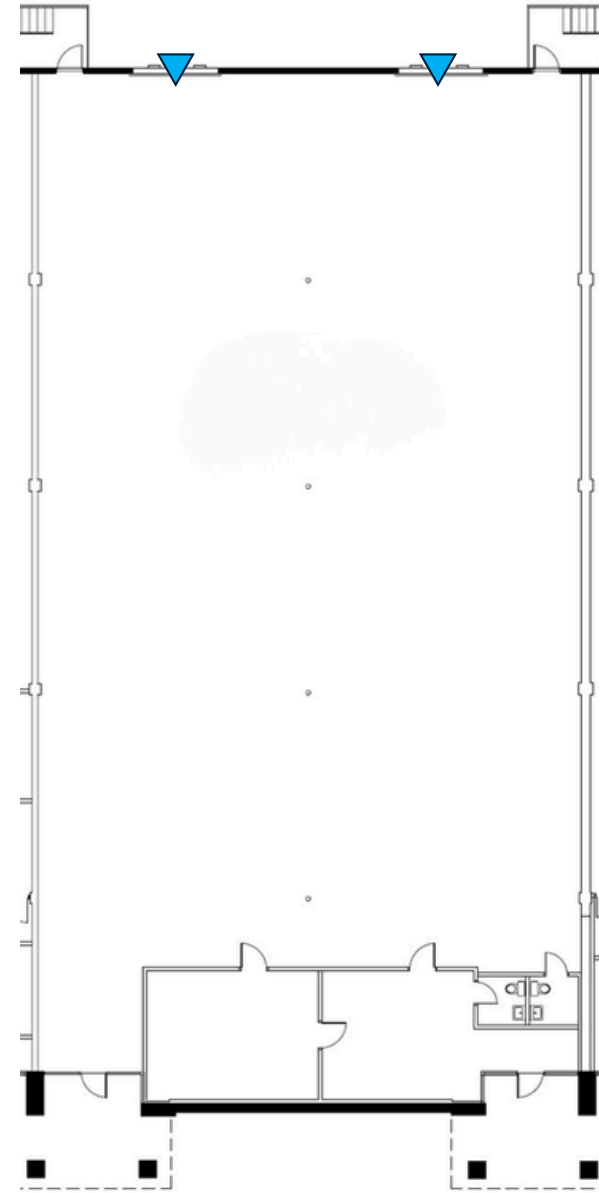

▼ DOCK HIGH DOOR

▼ DRIVE-IN DOOR



## CONTACT



**Trey Weghorst**  
Senior VP, Partner  
770.264.9420  
[tweghorst@apexindustrialre.com](mailto:tweghorst@apexindustrialre.com)



**Morgan McMenamy**  
Director  
404.806.6631  
[mmcmenamy@apexindustrialre.com](mailto:mmcmenamy@apexindustrialre.com)



**Apex Industrial Real Estate Advisors**

[www.apexindustrialre.com](http://www.apexindustrialre.com)