



M E R I D I A N

147 S. CHERRY STREET, SUITE 200 | WINSTON-SALEM, NC 27101 | P 336.722.1986 | F 336.723.3173 | MERIDIANREALTY.COM

Freestanding Restaurant with Drive-thru

# 7815 North Point Blvd

Winston-Salem, NC 27106



3,664± SF, 2nd generation restaurant space available with drive thru. Current equipment includes hood system, walk in cooler/freezer, grease trap. Located near the intersection of University Parkway & North Point Blvd (70,000±VPD), this site provides great visibility and access. Nearby users include Bank of America, McDonald's, Popeyes, Food Lion and Tropical Smoothie Café.

For more information:

**William T. Bartholomew, Jr., CCIM**

William@meridianrealty.com

336.480.2335

**FOR LEASE: \$26.50 PSF/NNN**

WWW.MERIDIANREALTY.COM

7815 North Point Blvd. | Winston-Salem, NC 27106

### Floorplan

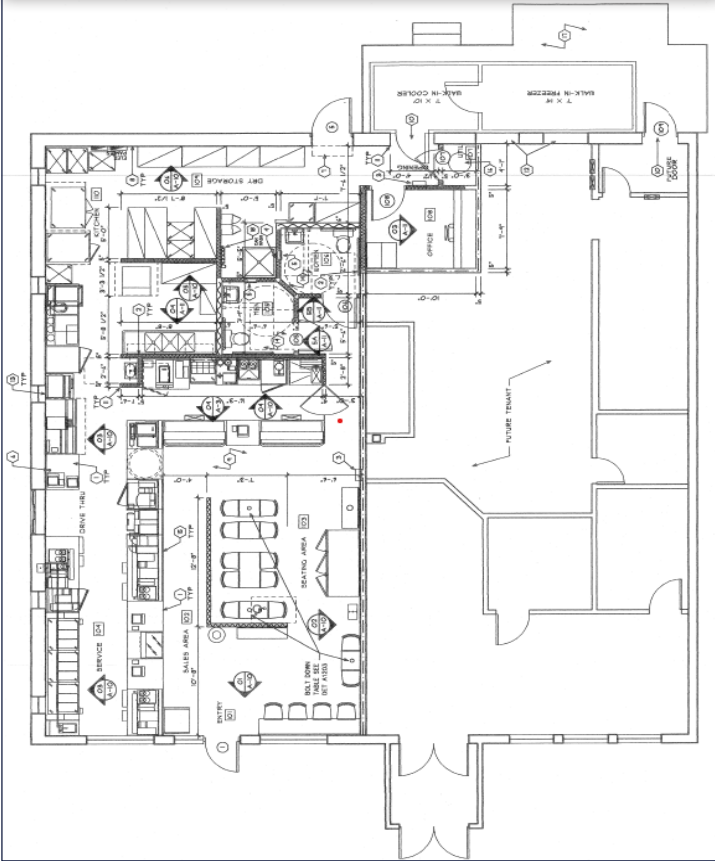

### Aerial

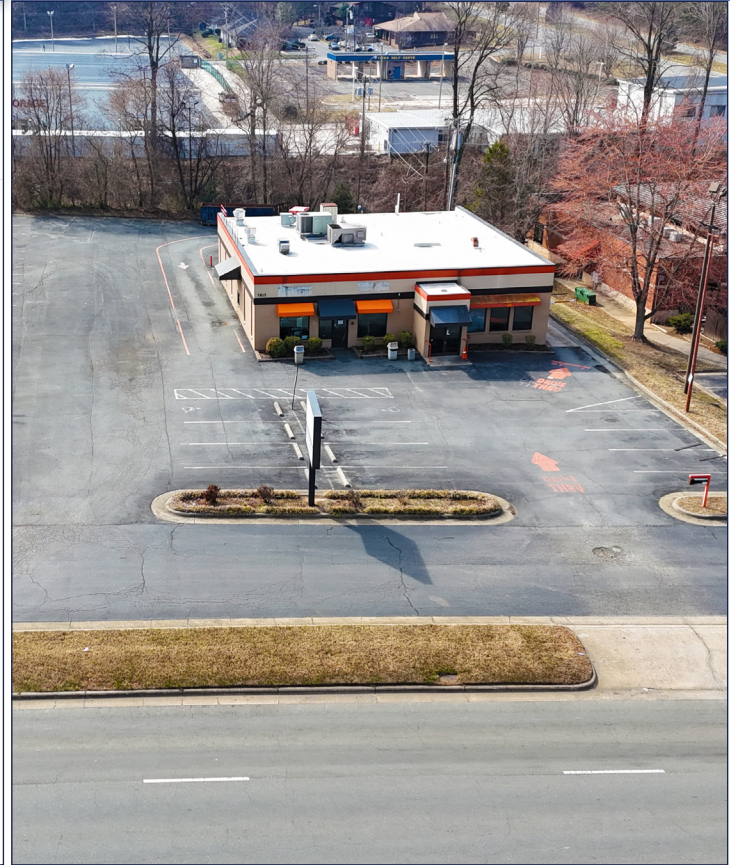

No warranty or representation (express or implied) is made as to the accuracy or completeness of the information set forth herein. All information is submitted subject to errors, omissions, change of price, prior lease or sale, and withdrawal without notice. All marketing material produced by the Meridian Realty Group is proprietary. Any reproduction is expressly prohibited.



THE MERIDIAN REALTY GROUP | 147 S. CHERRY STREET, SUITE 200 | WINSTON-SALEM, NC 27101

P 336.722.1986 | F 336.723.3173

WWW.MERIDIANREALTY.COM