

GARDEN CITY TOWN CENTER

5838-5940 Middlebelt Road / Garden City, MI



MID-AMERICA®
Real Estate-Michigan, Inc.

FOR LEASE



RETAIL OPPORTUNITY

GARDEN CITY TOWN CENTER



Address

5838-5940 Middlebelt Road
Garden City, MI 48135

Availability

2,311 SF
8,973 SF

Co-Tenants



Features

The Garden City Town Center is located on the busy corner of Ford and Middlebelt Roads in the heart of Garden City, Michigan. This prime location has a large parking field, high traffic counts and is located just outside the busy downtown district.

Join Planet Fitness, O'Reilly Auto Parts, Dollar Tree, and Cato Fashions at the Garden City Town Center which boasts a mix of national, and local tenants.

The 8,973 SF space is currently leased on a month-to-month basis. The Landlord has the option to subdivide the space, subject to the Tenant's qualifications.

Demographics (2024)

	1 MILE	3 MILES	5 MILES
POPULATION	14,012	135,426	310,639
HOUSEHOLDS	6,063	54,473	126,890
AVG HOUSEHOLD INCOME	\$80,696	\$85,550	\$86,445
DAYTIME POPULATION	11,199	99,478	281,089

GARDEN CITY TOWN CENTER

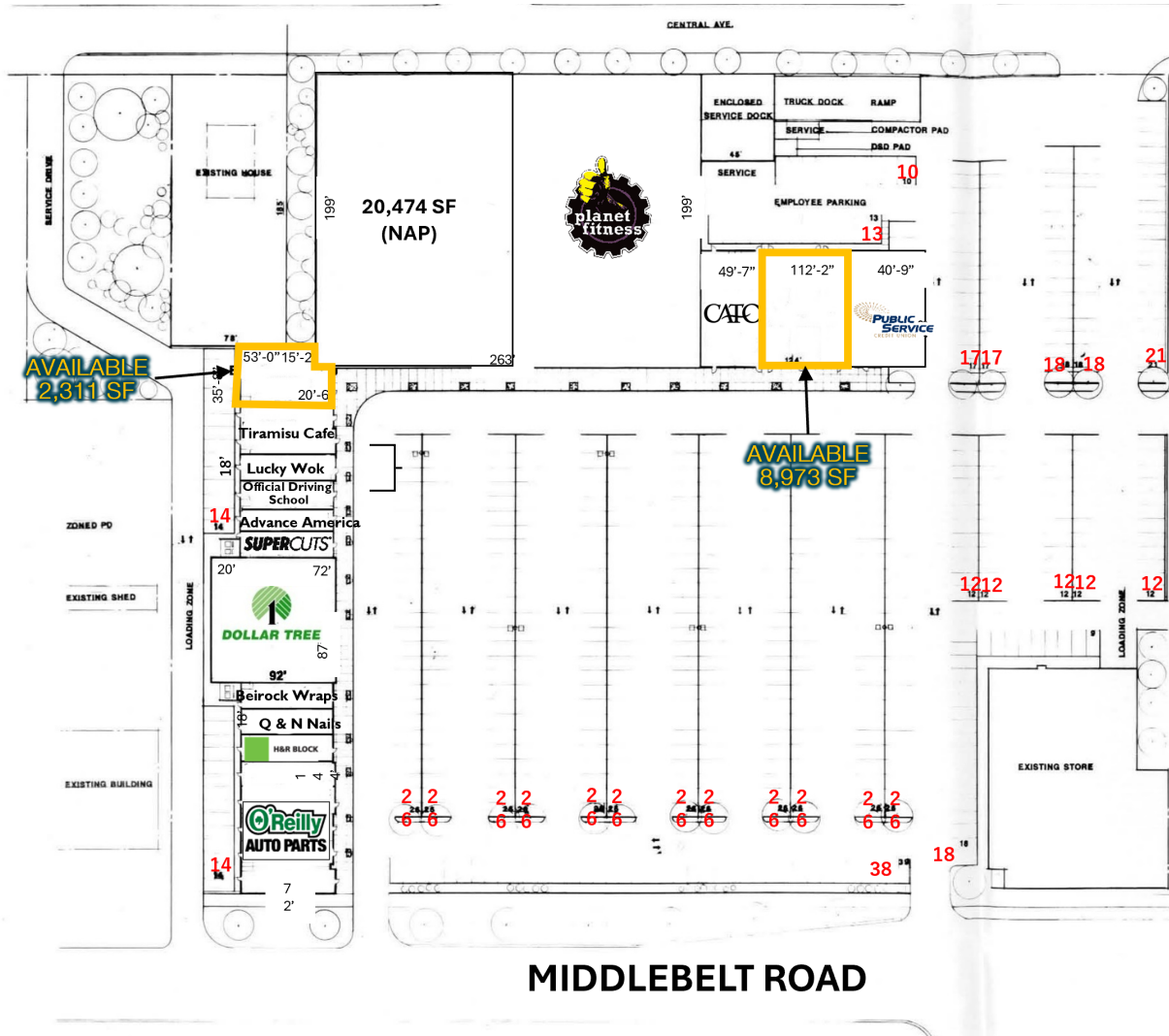

FORD ROAD

Tenant	Size
O'Reilly Auto	6,840 SF
H&R Block	904 SF
Q & N Nails	1,296 SF
Beirock Wraps	1,344 SF
Dollar Tree	8,004 SF
Supercuts	1,296 SF
Advance America	1,296 SF
Official Driving School	1,296 SF
Lucky Wok	1,296 SF
Tiramisu Cafe	2,592 SF
AVAILABLE	2,311 SF
Planet Fitness	30,000 SF
NAP	20,474 SF
CATO	4,000 SF
AVAILABLE	8,973 SF
Public Service Credit Union	3,251 SF
Parking Provided on Site-556 cars	
Municipal Parking Lot-255 cars	

SITE PLAN

GARDEN CITY TOWN CENTER

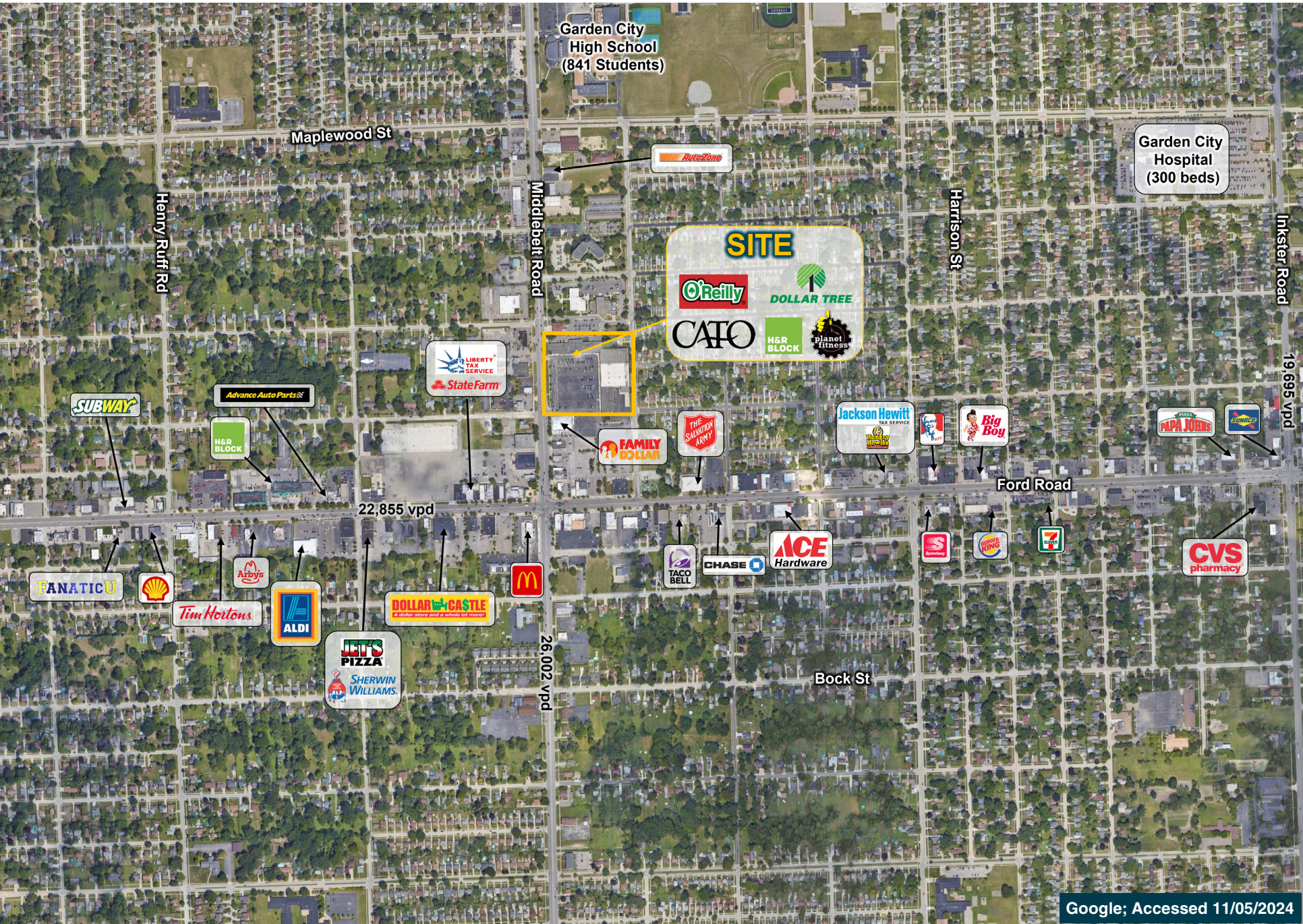

GARDEN CITY TOWN CENTER



Lindsey
Shaw

Mid-America Real Estate -
Michigan, Inc.

T: 248.855.6800

LShaw@MidAmericaGrp.com

Karen
Gargaro

Mid-America Real Estate -
Michigan, Inc.

T: 248.855.6800

KGargaro@MidAmericaGrp.com



38500 Woodward Ave, Suite 100
Bloomfield Hills, Michigan 48304
248.855.6800

MidAmericaGrp.com

CONTACT