



R&D Space for Sublease/Direct Deal Prologis Park Bayside

47428 Fremont Boulevard, Fremont, CA



NEW REDUCED RATE!



Property Highlights

- Plug and Play
- ±6,000 SF
- Corner unit/extensive glassline
- 200 Amps @ 277/480V 3 Phase
- Sublease term through 5/31/29
- Call to show
- Rate: \$1.85 NNN

±6,000 SF

Corner Unit with
Extensive Glassline

Close Proximity to
I-880 & I-680

Brian Mason, SIOR | Founder & Principal | 1-408-472-9498 | brian@ebmasoncre.com | Lic. 01229363

Scott Borgia, SIOR | Executive Vice President | 1-408-221-4499 | scott.borgia@outlook.com | Lic. 00903600



R&D Space for Sublease/Direct Deal Prologis Park Bayside

47428 Fremont Boulevard, Fremont, CA

Floor Plan

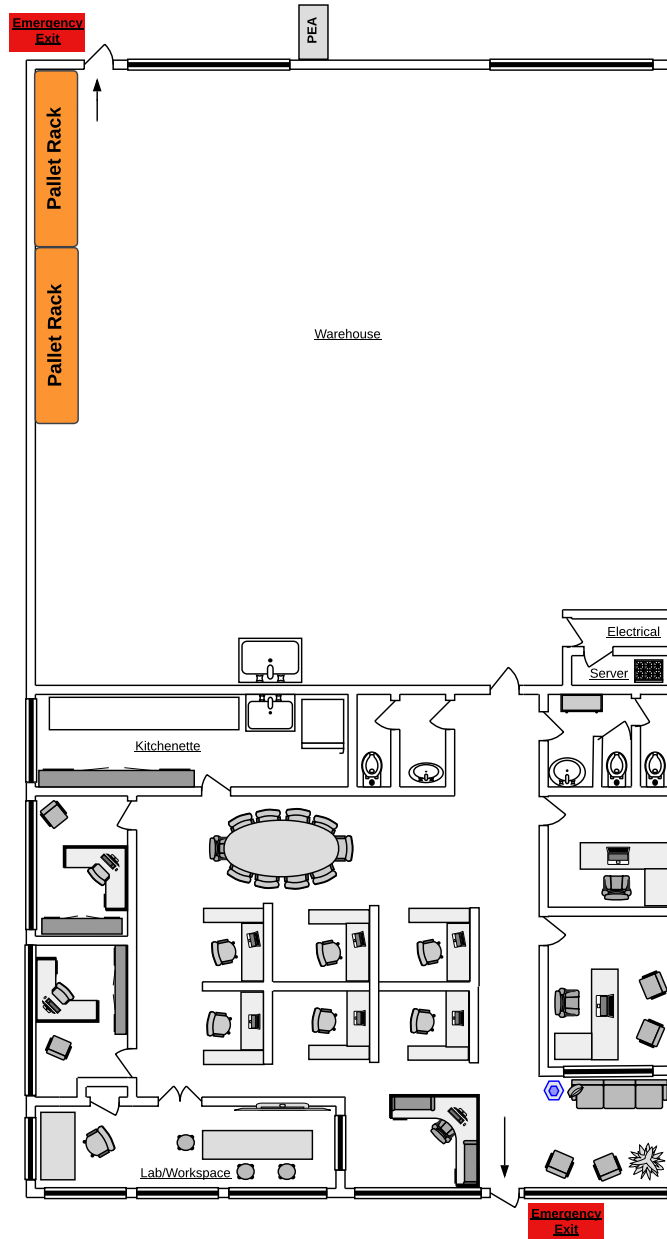

Brian Mason, SIOR | Founder & Principal | 1-408-472-9498 | brian@ebmasoncre.com | Lic. 01229363
Scott Borgia, SIOR | Executive Vice President | 1-408-221-4499 | scott.borgia@outlook.com | Lic. 00903600



R&D Space for Sublease/Direct Deal Prologis Park Bayside

47428 Fremont Boulevard, Fremont, CA

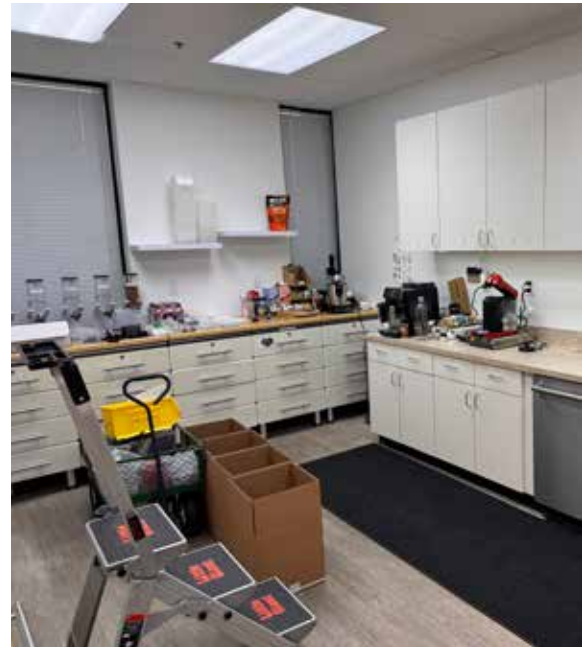

Brian Mason, SIOR | Founder & Principal | 1-408-472-9498 | brian@ebmasoncre.com | Lic. 01229363
Scott Borgia, SIOR | Executive Vice President | 1-408-221-4499 | scott.borgia@outlook.com | Lic. 00903600



R&D Space for Sublease/Direct Deal Prologis Park Bayside

47428 Fremont Boulevard, Fremont, CA



Brian Mason, SIOR | Founder & Principal | 1-408-472-9498 | brian@ebmasoncre.com | Lic. 01229363
Scott Borgia, SIOR | Executive Vice President | 1-408-221-4499 | scott.borgia@outlook.com | Lic. 00903600