

FOR LEASE

KPA
COMMERCIAL

Project Summary:

- Size: +10,000 to 60,000 SF warehouse space
- Zoning: AP with a M1 overlay AG productive Light industrial district* to be verified
- Multi tenant industrial building
- Power: 1,200 amps of heavy 240v-480v, 3-phase power
- Yard space available +2 acres of divisible yard space either paved, gravel rock, or dirt with the option for private secured fencing
- Warehouse clear height of 20', fully sprinklered, equipped with new LED light fixtures.
- Five (5) grade level roll up doors each approximately 12' x 14', two (2) loading docks
- Easy access to Highway 156/152
- Please call to tour
- Rate: \$1 per SF, nnn

1400 ORCHARD ROAD
HOLLISTER, CA

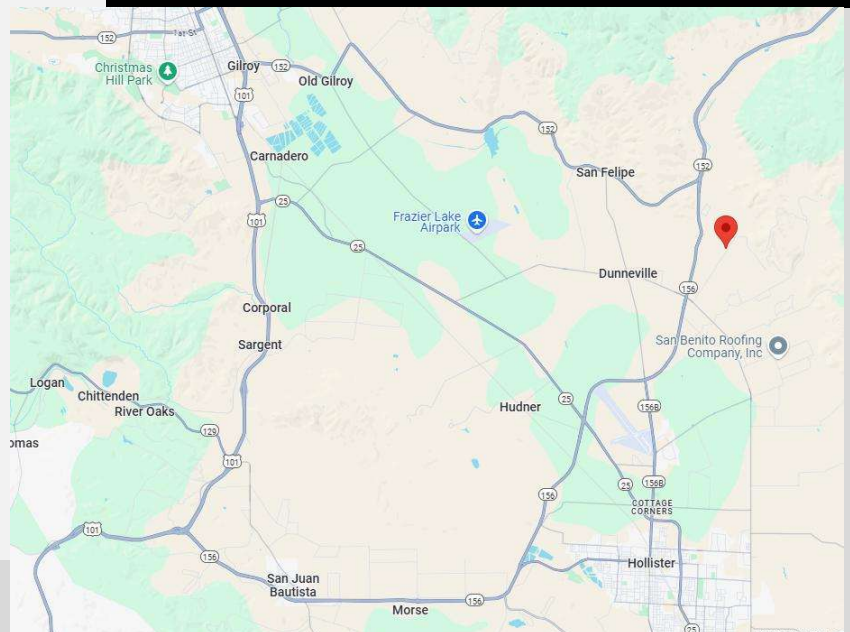

For more information, please contact:

KEVIN PEIXOTO

kevin@kpacommercial.com

408.557.0167

CalDRE Lic. No. 01411086 / CalDRE Corp. Lic. No. 02035384

www.kpacommercial.com

The information contained herein was obtained from sources believed reliable; however, KPA Commercial, Inc. and its agents make no guarantee, warranty or representation, either expressed or implied, as to the completeness or accuracy thereof. The presentation of this property is submitted subject to errors, omissions, change of prices or conditions prior to sale or lease, or withdrawal without notice.

SITE PLAN & PHOTOS

KPA
COMMERCIAL

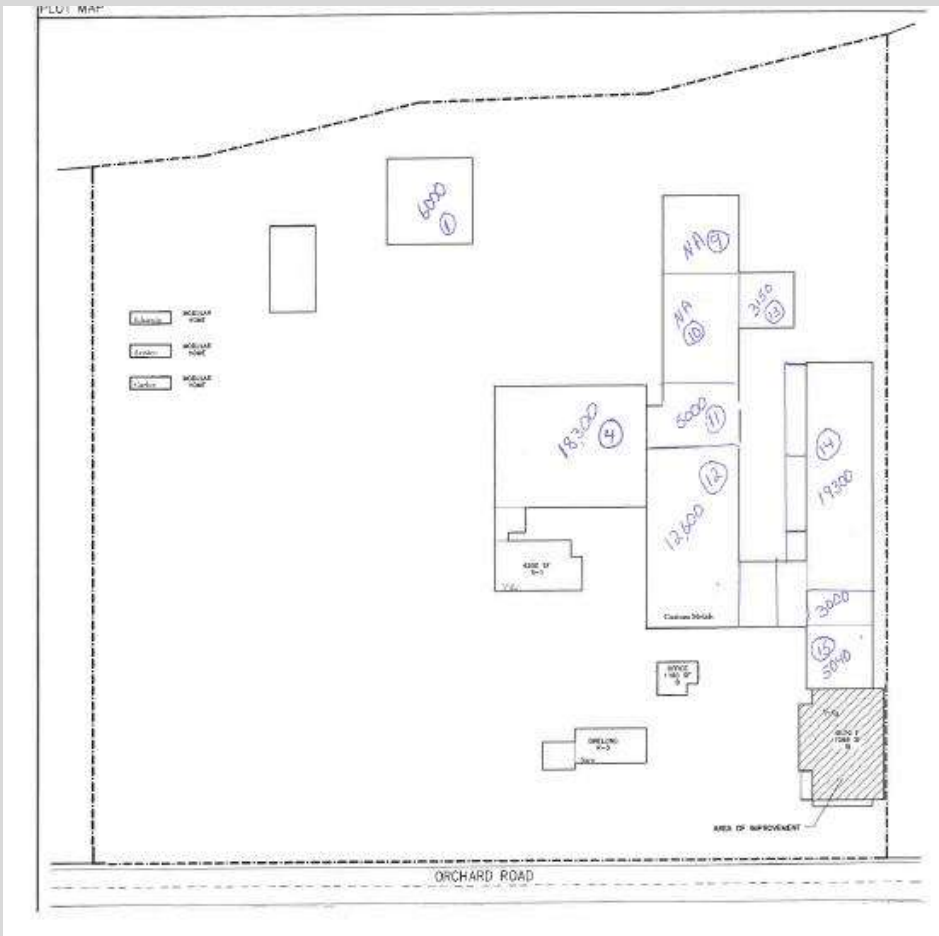

*DRAWINGS NOT TO SCALE/NOT EXACT



For more information, please contact:

KEVIN PEIXOTO

kevin@kpacommercial.com

408.557.0167

CalDRE Lic. No. 01411086 / CalDRE Corp. Lic. No. 02035384

www.kpacommercial.com

The information contained herein was obtained from sources believed reliable; however, KPA Commercial, Inc. and its agents make no guarantee, warranty or representation, either expressed or implied, as to the completeness or accuracy thereof. The presentation of this property is submitted subject to errors, omissions, change of price or conditions prior to sale or lease, or