

1 ASI Way

St. Petersburg, FL 33702

Up to 123,752 SF Available



123,752 SF - 3 Floors Available - Can be divided

Property Highlights

- Class “A” office building
- 20,755 RSF to 123,752 RSF of office space available
- Beautiful “Plug-and-Play” opportunity
- 4.20/1,000 RSF parking ratio
- Large parking deck with covered walkways
- Features modern tilt-wall construction with Category 5 resistant, double-pane window systems
- Best-in-class on-site amenities, including fitness center, outdoor basketball and volleyball courts, outdoor seating, nature paths, and so much more
- Gandy Boulevard frontage provides visibility to nearly 60,000 daily commuters
- Signature signage available

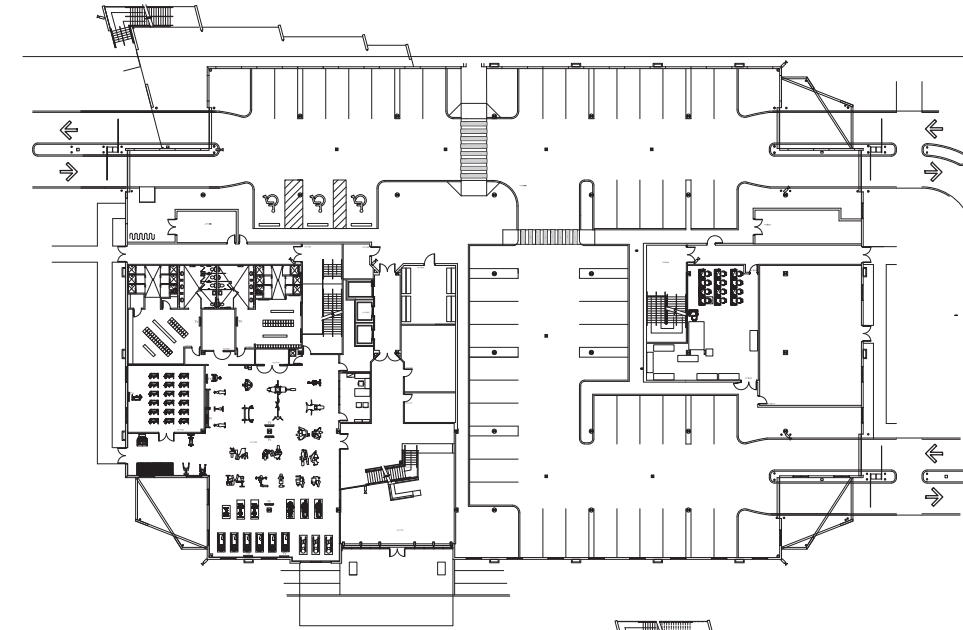
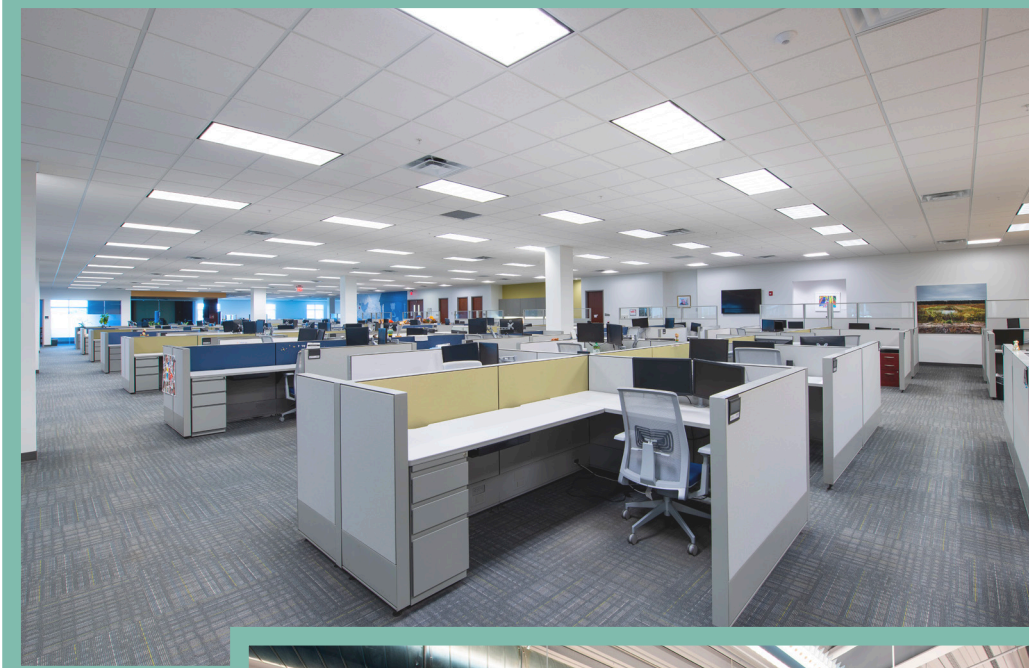

Floor 1
20,755 RSF

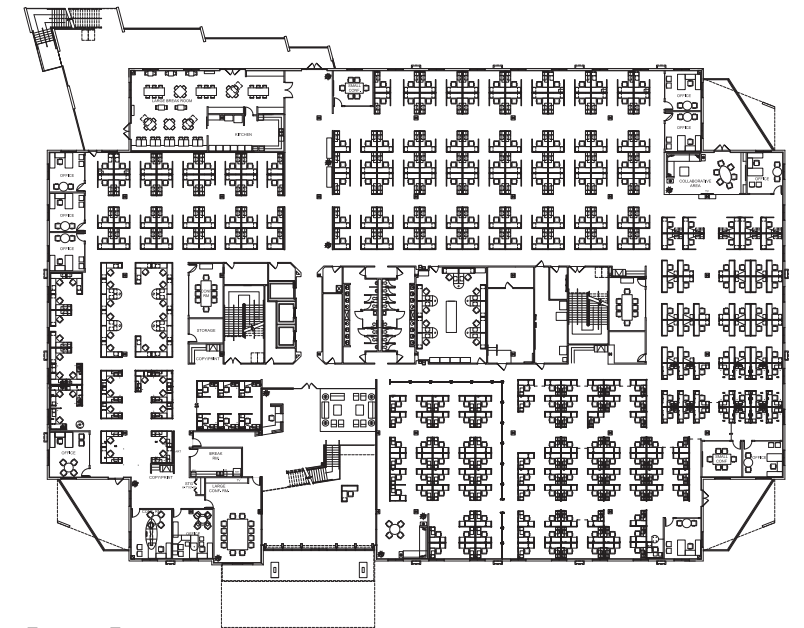

Floor 2
51,543 RSF

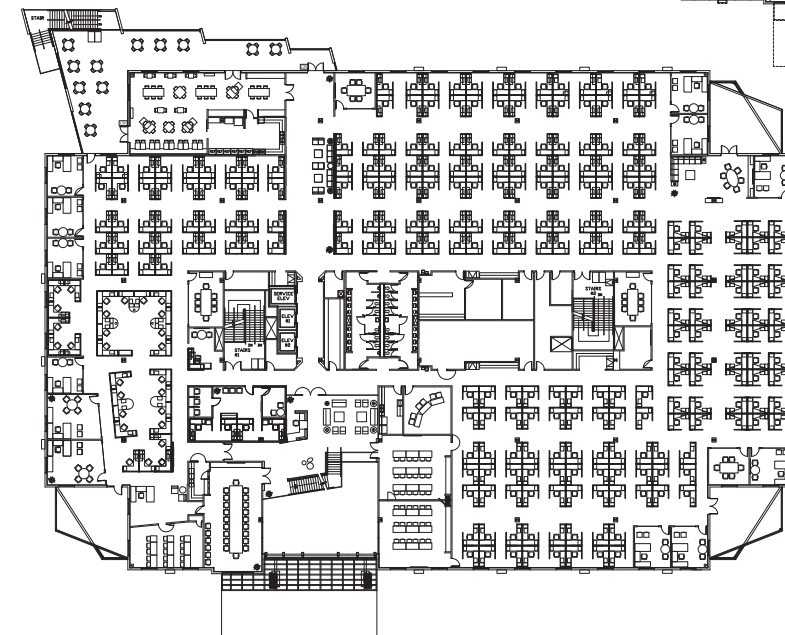

Floor 3
51,454 RSF

1 ASI WAY

St. Petersburg, Florida 33702

For Lease

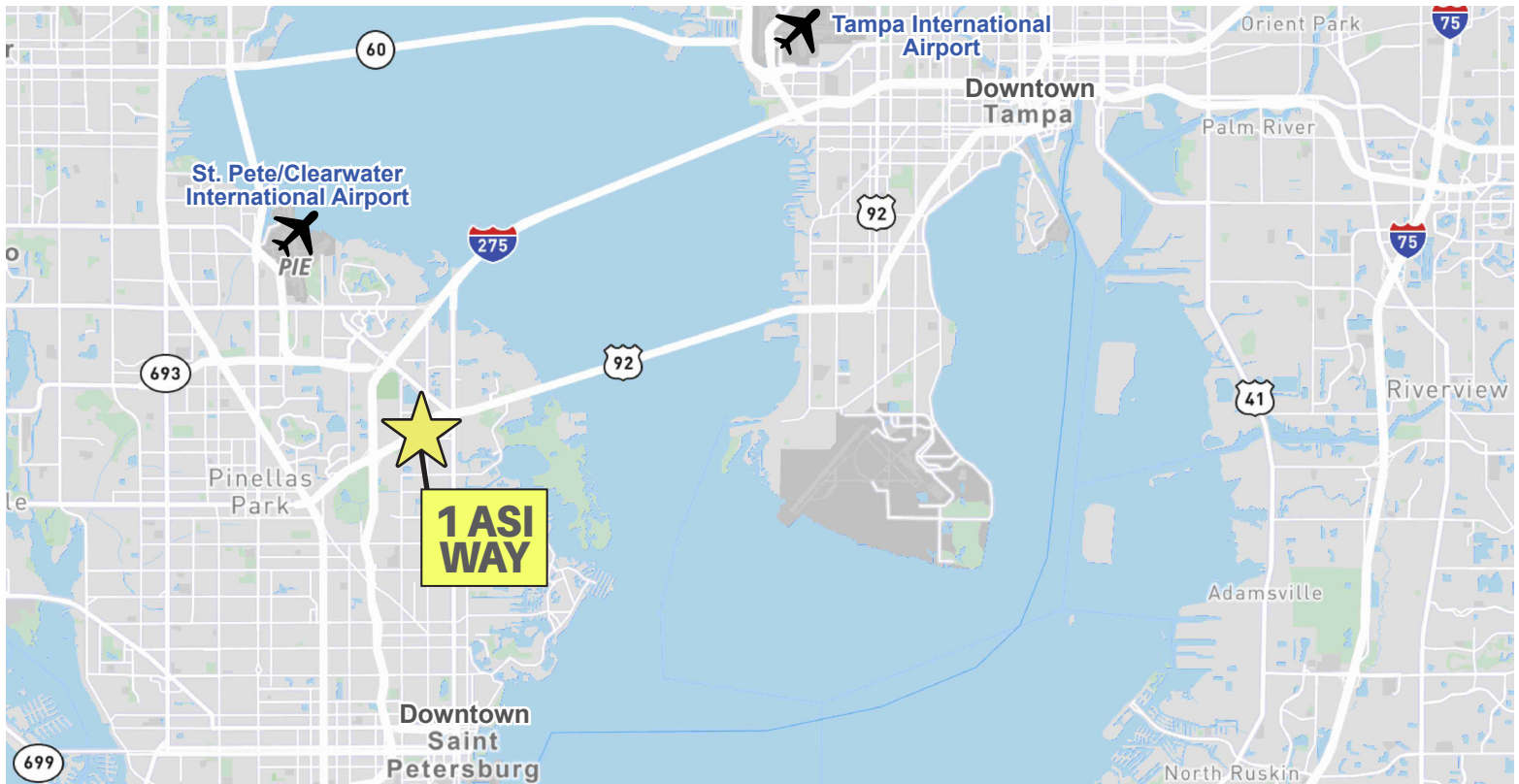

Location Highlights

- Strategically positioned within the Gateway submarket
- Easy access to I-275, Howard Frankland Bridge, Gandy Blvd, and Roosevelt Blvd
- Minutes from St Petersburg/Clearwater Airport and Tampa International Airport
- Close to jogging trails and other outdoor amenities
- Equidistant to Downtown Tampa and Downtown St. Pete



Contact Us

Kelley Matheson

+1 813 273 8489

kelley.matheson@cbre.com

Jackie Martinez

+1 813 273 8460

jackie.martinez@cbre.com

© 2024 CBRE, Inc. All rights reserved. This information has been obtained from sources believed reliable, but has not been verified for accuracy or completeness. You should conduct a careful, independent investigation of the property and verify all information. Any reliance on this information is solely at your own risk. CBRE and the CBRE logo are service marks of CBRE, Inc. All other marks displayed on this document are the property of their respective owners, and the use of such logos does not imply any affiliation with or endorsement of CBRE. Photos herein are the property of their respective owners. Use of these images without the express written consent of the owner is prohibited.

CBRE