

9152 Rosecrans Avenue

Bellflower, California



For Lease

±3,200 SF OFFICE BUILDING +

CONTRACTOR'S YARD

NEWMARK



PROPERTY SUMMARY

Perfect for a service company with a need for ample fleet parking—9152 Rosecrans Avenue sits on a high-visibility commercial corridor in Southeast Los Angeles, drawing daily-needs traffic from established residential neighborhoods and nearby businesses.

Office Highlights (±3,200 SF)

- Renovation in process
- Functional layout
- 2 private offices
- Large open work area
- ±1,000 SF of storage
- Storage room has double door entry and exit
- Lots of windows, abundant natural light
- Floor-to-ceiling reception glass store front with atrium entry

Yard Highlights (±15,320 SF)

- New modern landscape design—palm trees, drought tolerant plants
- New mechanical gate
- 8 ft. tall security fencing
- Flexible M1 zoning
- 14 parking spaces with additional parking available

9152 Rosecrans Avenue

Bellflower, California



LARGE OPEN
WORK AREA



± 15,320 SF CONTRACTOR'S YARD



± 1,000 SF
STORAGE



FLOOR PLAN

9152 Rosecrans Avenue
Bellflower, California

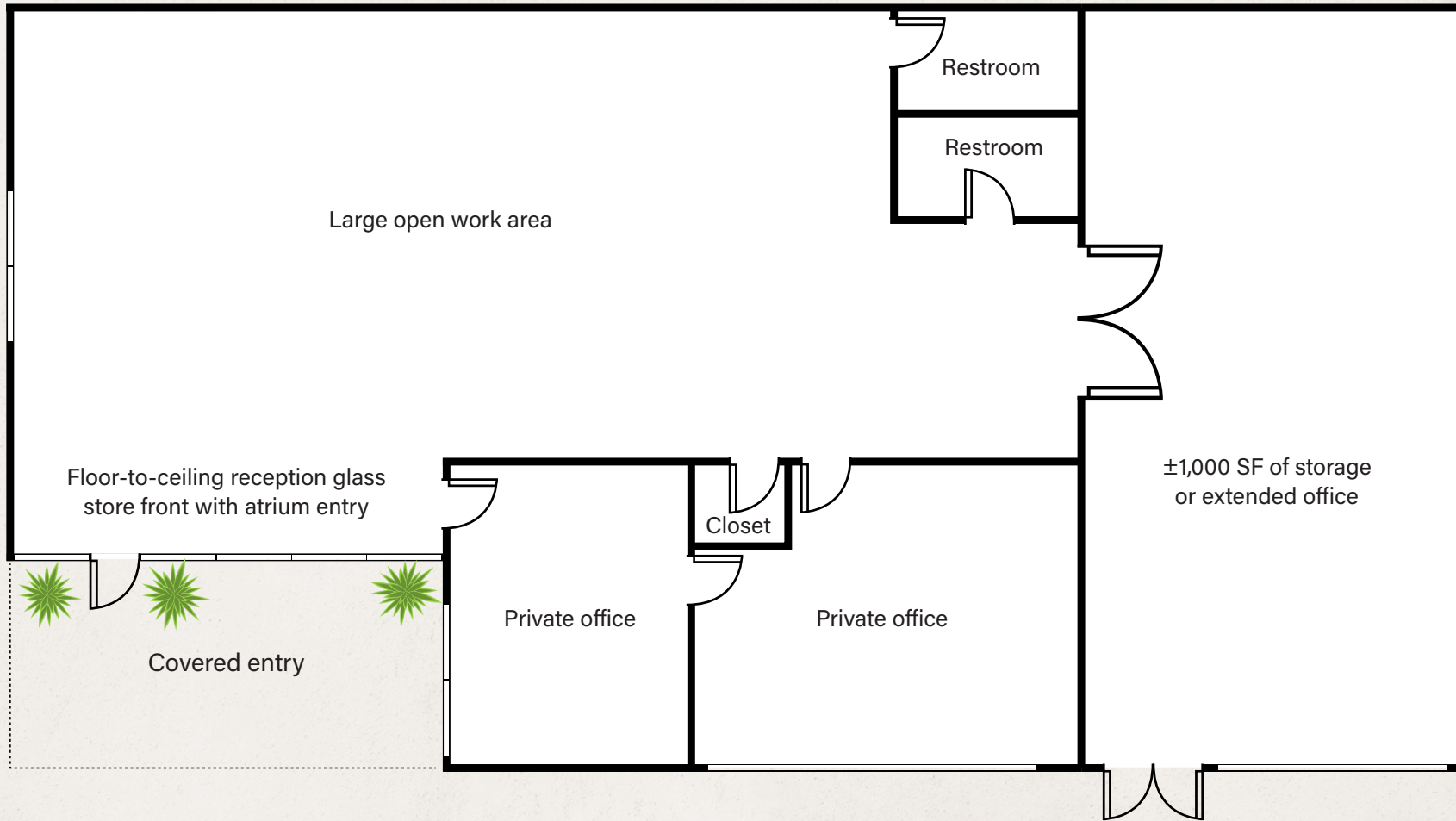

NEWMARK

- ±3,200 SF OFFICE BUILDING
- RENOVATION IN PROCESS
- LOTS OF WINDOWS/NATURAL LIGHT



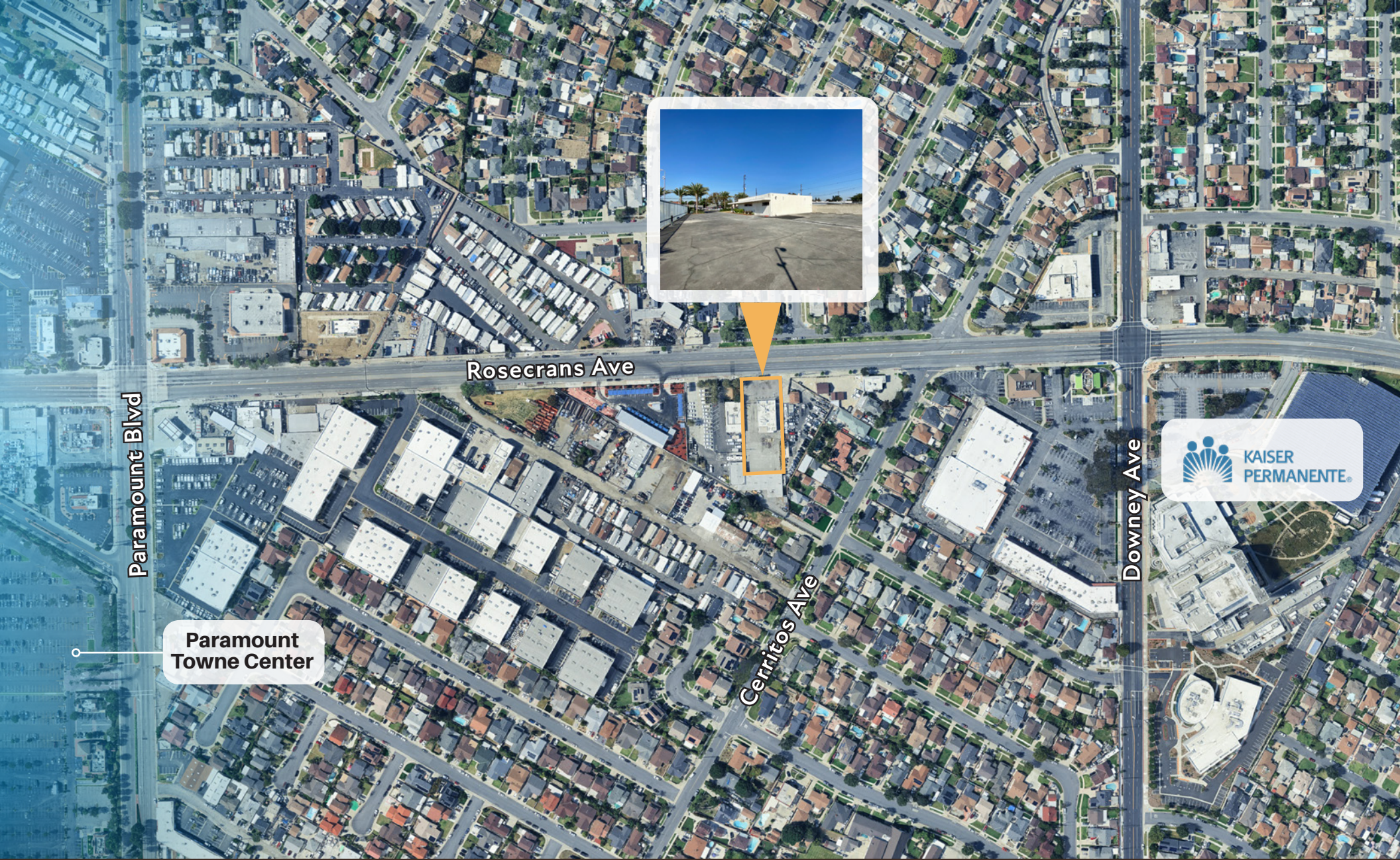

Paramount Blvd

Rosecrans Ave

Cerritos Ave

Downey Ave

Paramount Towne Center

9152 Rosecrans Avenue
Bellflower, California

Close to the **105, 605, 91,** and **710** freeways, with transit options from LA Metro and local bus lines.

9152 Rosecrans Avenue

Bellflower, California

Contacts:



TROY WOOTON

Senior Managing Director
CA RE Lic. #01377431
t 949-608-2020
troy.wooton@nmrk.com



ZAC FIELDER

Director
CA RE Lic. #01989549
t 949-608-2121
zac.fielder@nmrk.com

Corporate License #01355491

The information contained herein has been obtained from sources deemed reliable but has not been verified and no guarantee, warranty or representation, either express or implied, is made with respect to such information. Terms of sale or lease and availability are subject to change or withdrawal without notice.

NEWMARK