

Stand-Alone Warehouse With Paved / Fenced Yard

2640 Kirby Circle NE, Palm Bay, FL 32905

Centrally Located / Available Immediately / Close to US1 & I-95



OFFERING SUMMARY

Available SF: 13,900 SF

Lease Rate: \$10.95 SF/yr (NNN)

Acreage: 1.66 Acres

Zoning: City of Palm Bay Light
Industrial (LI)

PROPERTY OVERVIEW

Dimensions est. 50' Deep x 278' Wide
Interior Includes est. 624 SF Office and 1 Restroom. 100% Fire Sprinklered
Concrete Flooring Throughout. Clear Height Ranges 14' – 16' +/-
Four 18' Wide x 14' Tall +/- Grade Level Doors
One Deep Well Dock with a 12' Wide x 10' Tall +/- Door
Gated/Paved/Cleared/Fenced Yard
City Water/Sewer, 1-Phase FPL Electric
Remaining Racking is Negotiable

LOCATION OVERVIEW

Located in the heart of Palm Bay, just off of Robert J. Conlan Boulevard. Close proximity to US1, Palm Bay Road & Interstate 95 which makes this property easily accessible to the surrounding Restaurants, Childcare, Residential & Beaches that the area has to offer. Surrounding neighbors include L3Harris, Raytheon, Leonardo DRS & UPS to name a few. The Melbourne International Airport is approximately 15-minutes away. Make this the future home for your business today!



Michael S. Ullian, President, CCIM, SIOR Zach Ullian, SIOR

Licensed Real Estate Broker
Cell: 321.258.7556
mike@ullianrealty.com

Broker Associate
Cell: 321.750.3439
zach@ullianrealty.com



Stand-Alone Warehouse With Paved / Fenced Yard

2640 Kirby Circle NE, Palm Bay, FL 32905

Aerial & Floorplan

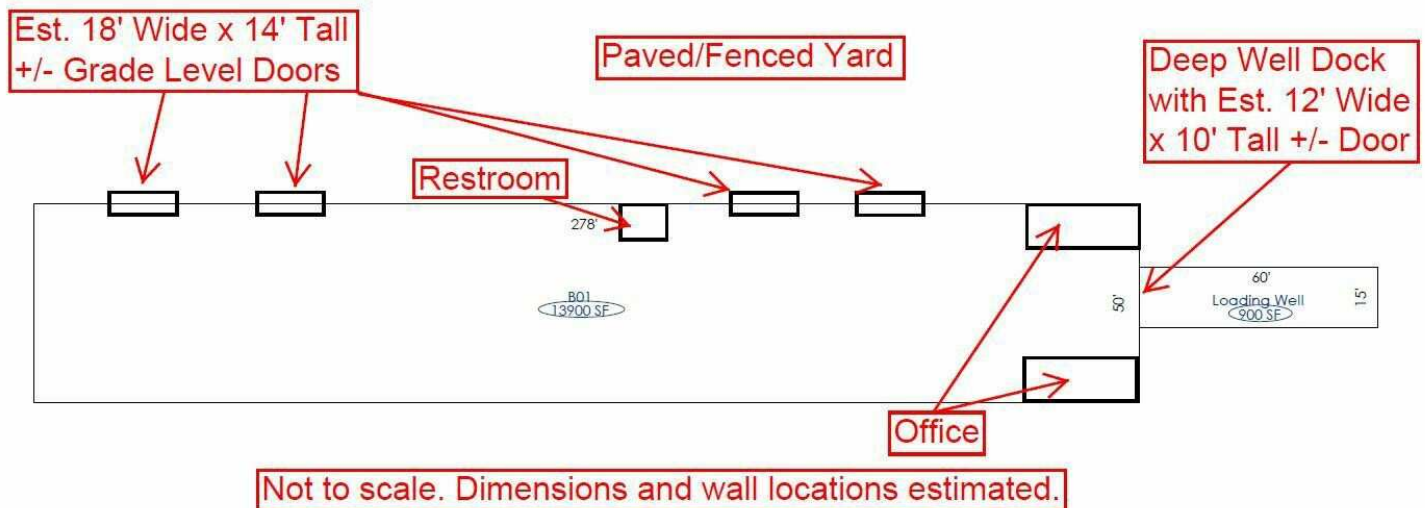

Michael S. Ullian, President, CCIM, SIOR Zach Ullian, SIOR

Licensed Real Estate Broker
Cell: 321.258.7556
mike@ullianrealty.com

Broker Associate
Cell: 321.750.3439
zach@ullianrealty.com



Stand-Alone Warehouse With Paved / Fenced Yard

2640 Kirby Circle NE, Palm Bay, FL 32905

Additional Photos



Michael S. Ullian, President, CCIM, SIOR Zach Ullian, SIOR

Licensed Real Estate Broker
Cell: 321.258.7556
mike@ullianrealty.com

Broker Associate
Cell: 321.750.3439
zach@ullianrealty.com



The Ullian Realty Corporation 1800 Penn Street Melbourne, FL 32901 321.729.9900 ullianrealty.com

The information provided is subject to change without notice. The Ullian Realty Corporation assumes no responsibility for any errors, omissions, or changes.

Stand-Alone Warehouse With Paved / Fenced Yard

2640 Kirby Circle NE, Palm Bay, FL 32905

Surrounding Businesses



Map
data
©2025
Google



Michael S. Ullian, President, CCIM, SIOR Zach Ullian, SIOR

Licensed Real Estate Broker
Cell: 321.258.7556
mike@ullianrealty.com

Broker Associate
Cell: 321.750.3439
zach@ullianrealty.com



SIOR
Individual Members
Michael S. Ullian
Zachary M. Ullian

The Ullian Realty Corporation 1800 Penn Street Melbourne, FL 32901 321.729.9900 ullianrealty.com

The information provided is subject to change without notice. The Ullian Realty Corporation assumes no responsibility for any errors, omissions, or changes.