

HERITAGE SQUARE PUD

MULTIFAMILY RENTAL DEVELOPMENT

MASON & BURKHARD RDs. | HOWELL, MI

GREAA

MIDWEST



LOCATION

- North of Mason Rd., West of Burkhart Rd.
- Just South of I-96

LISTING HIGHLIGHTS

- 378 Multifamily Units
- Residential Portion to Break Ground in 2024

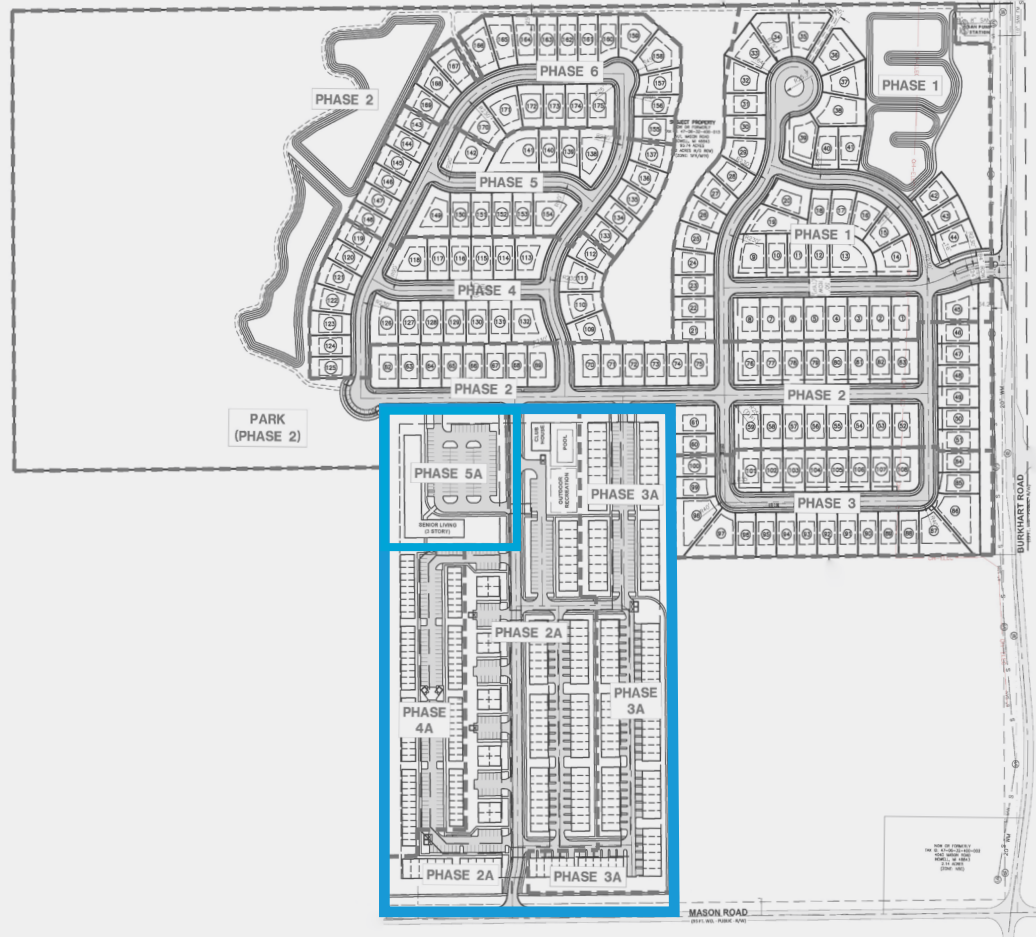

LIST PRICE

\$3,780,000

[Click Here To View More Information On This Listing At GREAA.com](#)

Nick Kirby
Managing Director
248.800.0152
nick.kirby@grea.com

Cary Belovicz
Founding Partner
248.800.0149
cary.belovicz@grea.com

GREAA

7035 Orchard Lake Road, Suite 150
West Bloomfield, MI 48322
248.394.0000 | GREA.com