



www.sanjosebiocube.com



FLEXIBLE LAB SPACE FOR DYNAMIC INNOVATION

Move-In Ready Labs



Contacts

PETER CONTE

CA DRE # 01840209

peter.conte@transwestern.com

415.489.1844

ANDREW WHEELER

CA DRE # 02048909

andrew.wheeler@transwestern.com

415.489.1831

5941 Optical Ct.
San Jose, CA

LAB & OFFICE SPACE

Available Now

Contacts

PETER CONTE

CA DRE # 01840209
peter.conte@transwestern.com
415.489.1844

ANDREW WHEELER

CA DRE # 02048909
andrew.wheeler@transwestern.com
415.489.1831

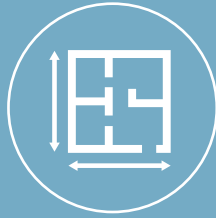

Wet Lab spaces range from 100 SF bench space in Concept Lab to 500-1,300 SF individual lab suites



Includes central DI water & vacuum, fume hoods, emergency showers & eye washing stations, HazMat storage cabinets, individual suite HVAC zoning



Includes on-site support & best practices



5941 Optical Ct.
San Jose, CA



FLOOR PLAN

Now Available:
[Lab #1](#)
[Office #125](#)

Future Flex Space
Available Sept 1st

*Links will navigate to lease opportunity



5941 Optical Ct.
San Jose, CA



 ACCESS VIRTUAL TOUR HERE

LAB SPACE #1

- 6 Benches
- 1 Sink w/ DI Water
- Optional Fume Hood
- CDA
- VAC
- Emergency Power
- Dedicated Wireless Access



Full Floor Plan

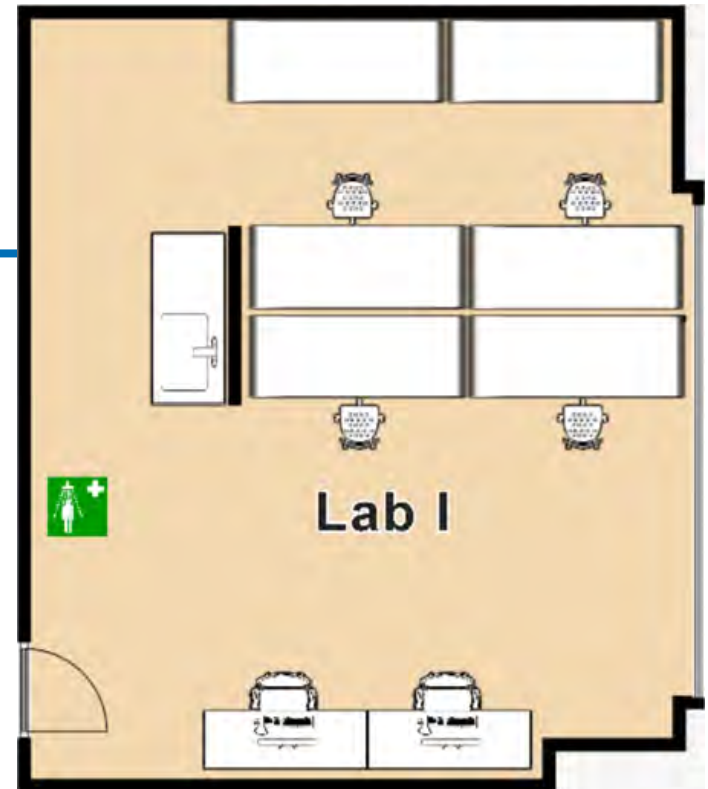

Contacts

PETER CONTE

CA DRE # 01840209
peter.conte@transwestern.com
415.489.1844

ANDREW WHEELER

CA DRE # 02048909
andrew.wheeler@transwestern.com
415.489.1831



5941 Optical Ct.
San Jose, CA



CLEAN ROOM ADAPTABLE

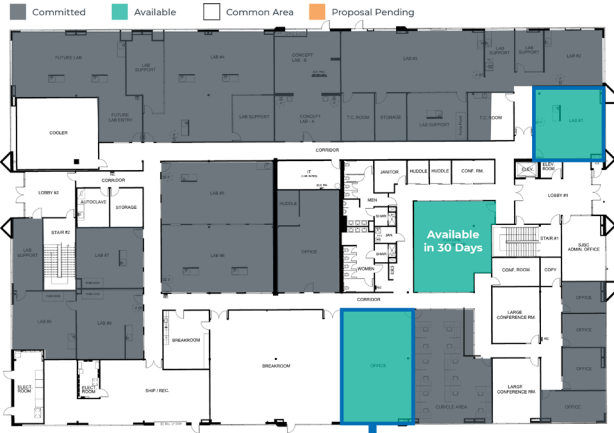

Full Floor Plan

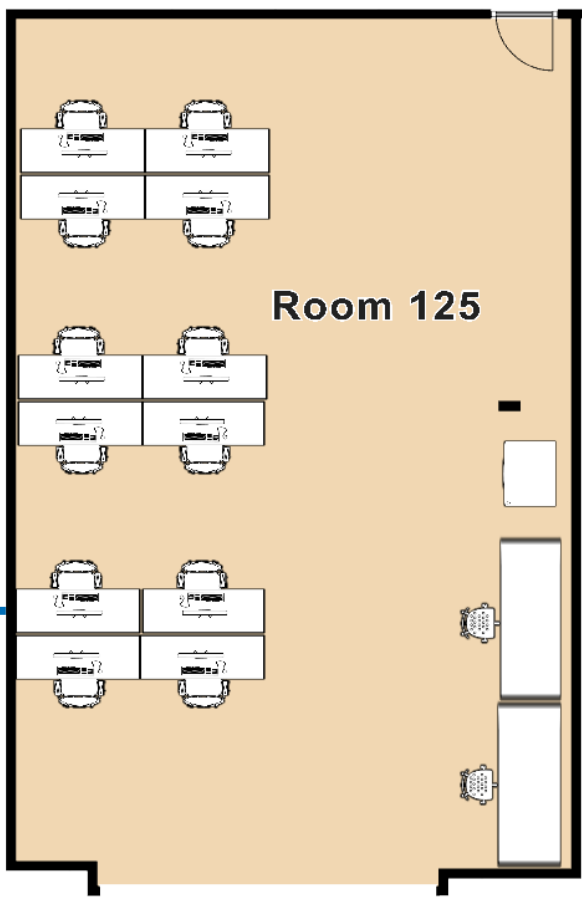

Room 125

Contacts

PETER CONTE
CA DRE # 01840209
peter.conte@transwestern.com
415.489.1844

ANDREW WHEELER
CA DRE # 02048909
andrew.wheeler@transwestern.com
415.489.1831



www.sanjosebiocube.com



FLEXIBLE LAB SPACE FOR DYNAMIC INNOVATION

Move-In Ready Labs



Contacts

PETER CONTE

CA DRE # 01840209
peter.conte@transwestern.com
415.489.1844

ANDREW WHEELER

CA DRE # 02048909
andrew.wheeler@transwestern.com
415.489.1831

COPYRIGHT © 2021 TRANSWESTERN, CALIFORNIA
BROKERAGE LIC #01263636. ALL DATA IS DERIVED
FROM SOURCES DEEMED TO BE RELIABLE BUT IS
NOT GUARANTEED.