



Industrial Space

Alika Cosner (S)
Senior Vice President
Industrial and Investment
Services Division
Lic# RS-69441
808 292 4599
alika.cosner@colliers.com

Patrick McGranahan (S)
Senior Associate
Industrial Services Division
Lic# RS-83939
808 754 8535
patrick.mcgranahan@colliers.com

3116 Hoolako Street Lihue, HI 96766

Great opportunity for an industrial user to be situated minutes from Lihue Airport as well as Lihue Harbor. Three available spaces ranging in size from 1,148 SF to 8,429 with the possibility of combining all three at for a total of roughly 9,500 SF. Parking fronting each space leading to two at grade roll up doors for Unit E/F and one at grade roll up door for unit G. With frontage along Hoolako Street, this is a great option for any quasi-retail/industrial user.

Features & Benefits

- 1 mile to Lihue Airport
- Close proximity to Lihue Harbor
- Parking in front of at-grade roll up door
- 20' clear height

220 S. King Street, Suite 1800
Honolulu, Hawaii 96813
808 524 2666
colliers.com

Copyright © 2024 Colliers International. Information herein has been obtained from sources deemed reliable, however its accuracy cannot be guaranteed. The user is required to conduct their own due diligence and verification.

For Lease

Contact us:

Alika Cosner (S)
Senior Vice President
Industrial and Investment
Services Division
Lic# RS-69441
808 292 4599
alika.cosner@colliers.com

Patrick McGranahan (S)
Senior Associate
Industrial Services Division
Lic# RS-83939
808 754 8535
patrick.mcgranahan@colliers.com

| | |
|---------------------|--|
| TMK Number: | 4-3-6-12-10 (portion of) |
| Address: | 3116 Hoolako Street Lihue, HI 96766 |
| Area: | Lihue |
| Zoning: | I-L (Limited Industrial) |
| Base Rent: | \$1.55 PSF/Mo |
| Operating Expenses: | \$0.30 PSF/Mo |
| Term: | 3 - 5 Years |

Available Space:

| | | |
|--|----------|-----------------------------------|
| Unit E/F (Avail. 30 day notice) | 8,429 SF | Two (2) grade level roll-up doors |
| Unit G (Avail. 30 day notice) | 1,148 SF | One (1) grade level roll-up doors |

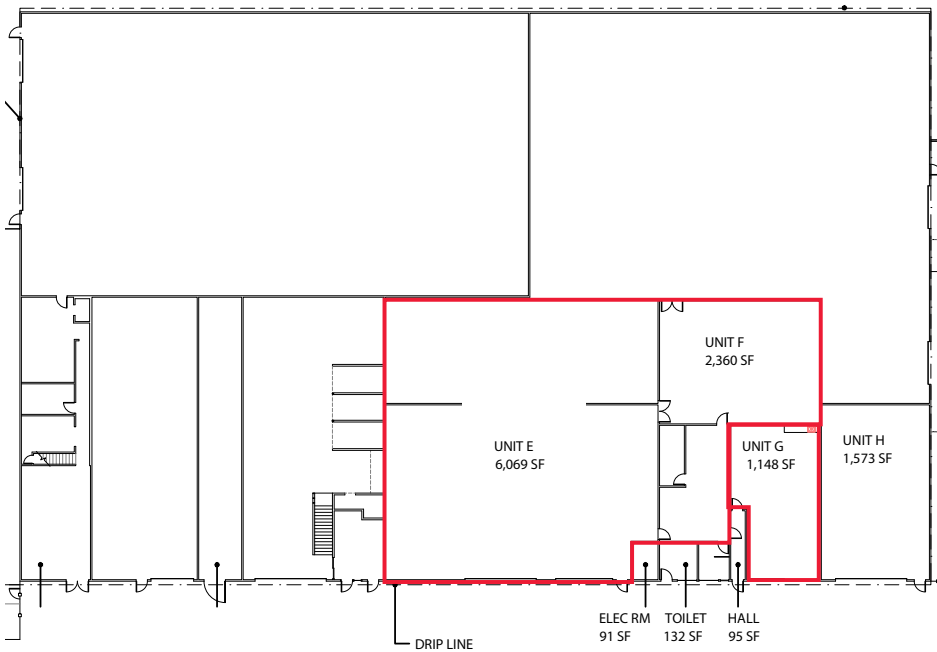

220 S. King Street, Suite 1800
Honolulu, Hawaii 96813
808 524 2666
colliers.com

