

FOR LEASE - FORMER BOTTLING FACILITY / 100% CLIMATE CONTROLLED W/ FLOOR DRAINS

UNIT #21 IN WAREHOUSE #1 - 63,259± SF

2612 CROWS LANDING ROAD, MODESTO, CA



## WAREHOUSE #1 FEATURES:

- Square Feet: 63,259± (200' X 300')
- Entire unit is drop ceiling to 16' with HVAC to 75± degrees
- Floor drains in approximately 1/4 of unit
- 800 amp, 480 volt distributed power, more possible
- 6,840± SF office, breakroom, conference room, laboratory and restrooms
- One (1) dock door (more possible)
- Four (4) oversized grade level doors
- ESFR Fire Sprinklers
- Adjacent expansion space available
- 10,000± SF adjacent freestanding metal building also available in large yard area



## G3 DISTRIBUTION CENTER

- Serviced by Union Pacific Rail Service (2 parallel spurs) providing Indoor service with capacity for approximately eight (8) cars per side (16 total)
- Low electrical rates provided by Turlock Irrigation District (TID)
- Secure campus with 24/7 guard house
- Parking/yard space available
- Part of five buildings, 2,800,000± square foot G3 Distribution Center Main Campus.

IMMEDIATELY AVAILABLE!



**Mark J. Reckers, SIOR**  
BRE #00938704  
mreckers@lee-associates.com  
C 209.471.4884  
D 209.983.6838



FOR LEASE - FORMER BOTTLING FACILITY / 100% CLIMATE CONTROLLED W/ FLOOR DRAINS

UNIT #21 IN WAREHOUSE #1 - 63,259± SF

2612 CROWS LANDING ROAD, MODESTO, CA

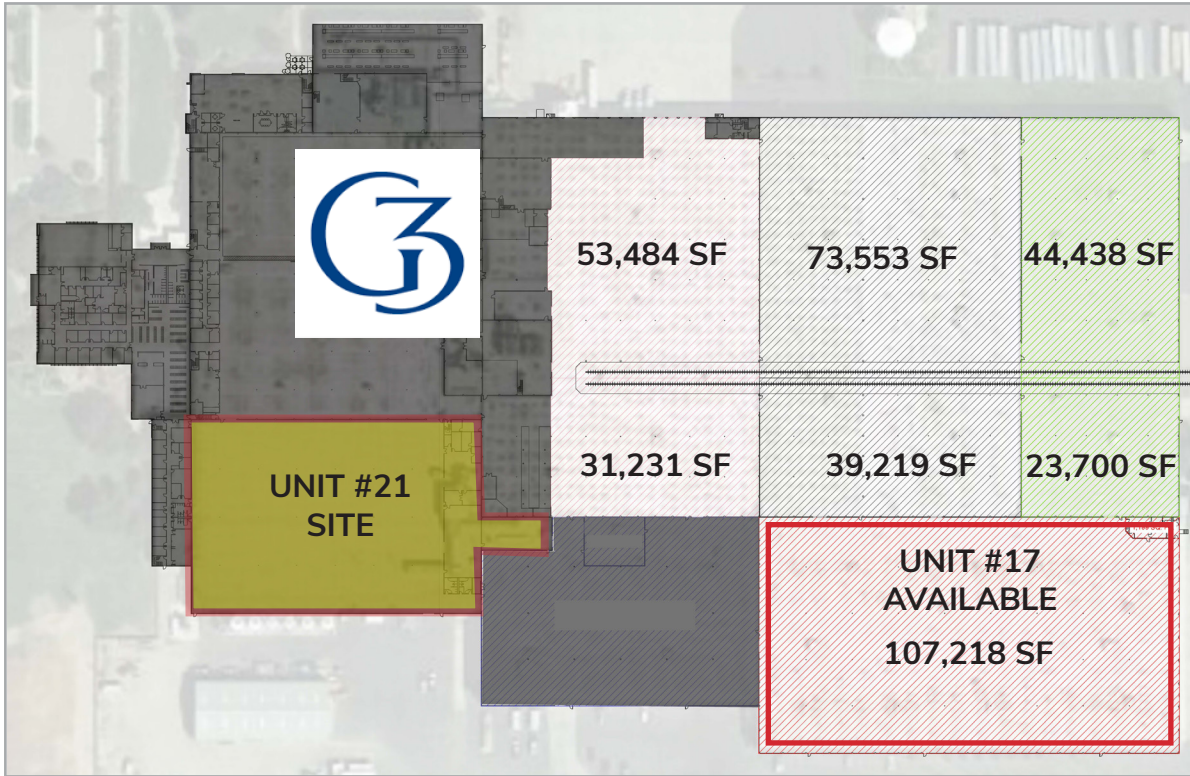

Unit	Available SF	Office SF	Column Spacing	Dock Doors	Grade Doors
21	63,259	6,840	40' x 50'	1	4
17	107,218	1,200	42'X36'	17	possible



**Mark J. Reckers, SIOR**

BRE #00938704

mreckers@lee-associates.com

C 209.471.4884

D 209.983.6838



FOR LEASE - FORMER BOTTLING FACILITY / 100% CLIMATE CONTROLLED W/ FLOOR DRAINS

UNIT #21 IN WAREHOUSE #1 - 63,259± SF

2612 CROWS LANDING ROAD, MODESTO, CA

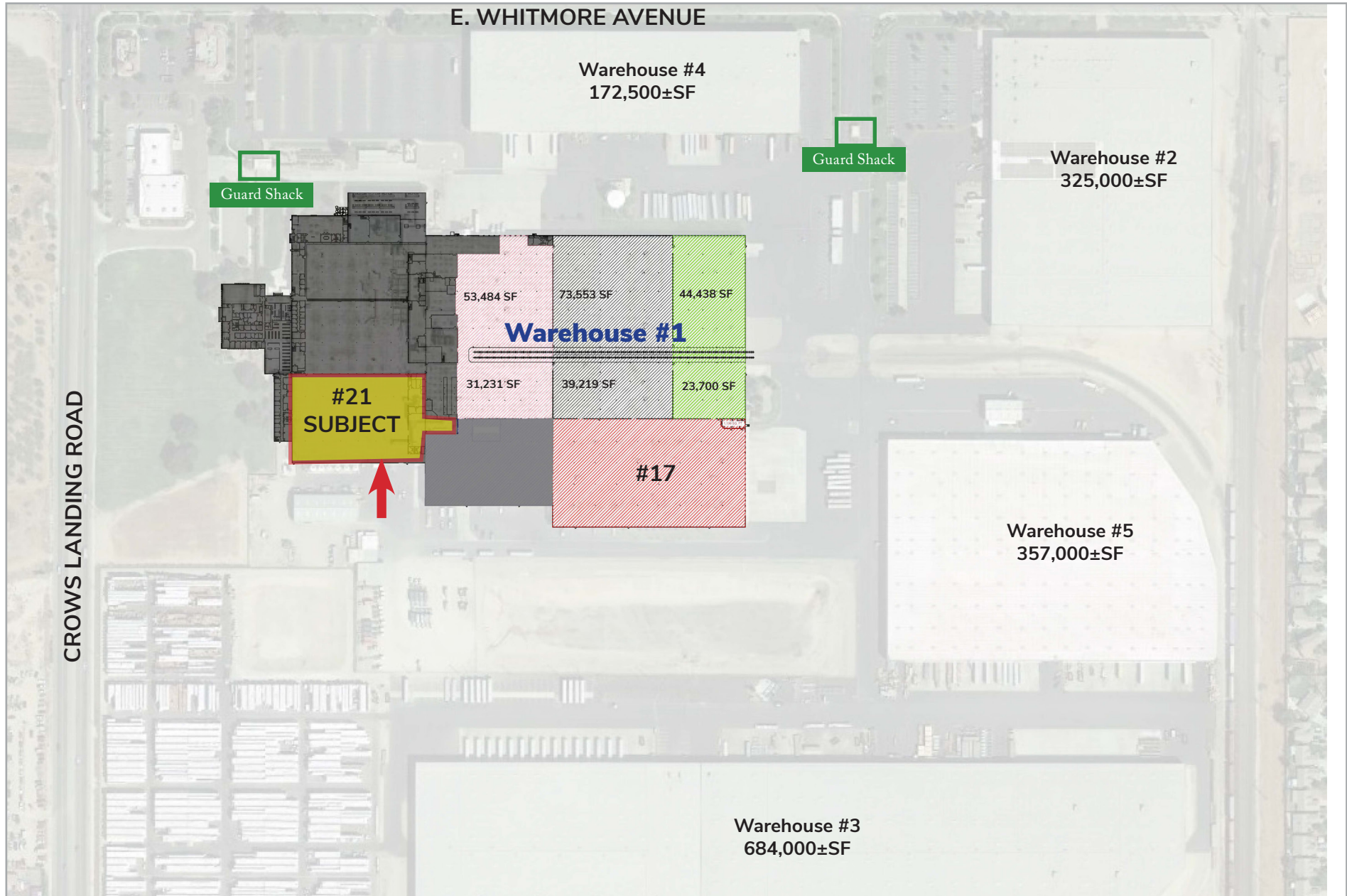

FOR LEASE - FORMER BOTTLING FACILITY / 100% CLIMATE CONTROLLED W/ FLOOR DRAINS

UNIT #21 IN WAREHOUSE #1 - 63,259± SF

2612 CROWS LANDING ROAD, MODESTO, CA



COMMERCIAL REAL ESTATE SERVICES

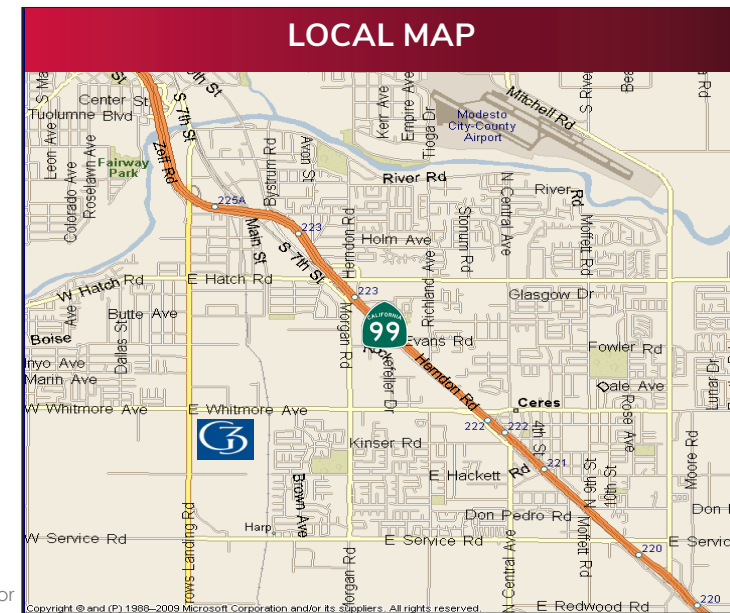
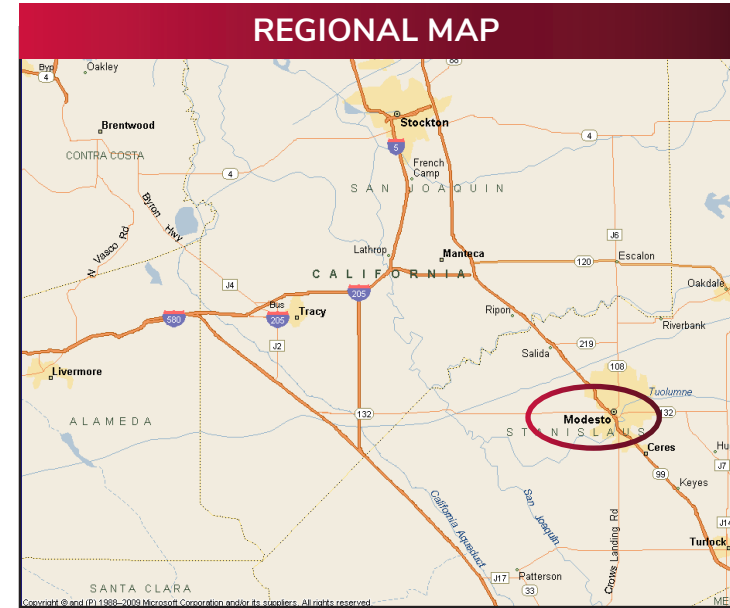
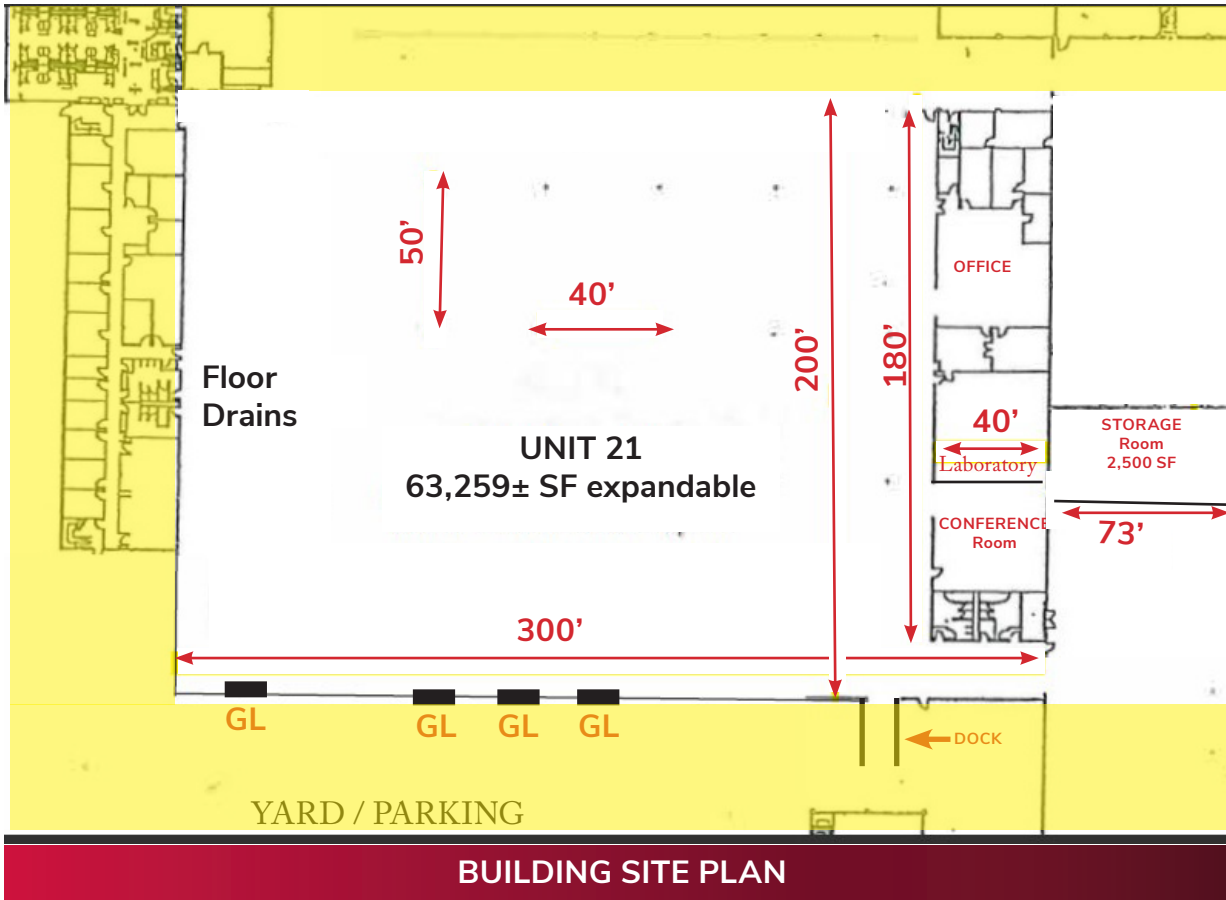

**Mark J. Reckers, SIOR**

BRE #00938704

mreckers@lee-associates.com

C 209.471.4884

D 209.983.6838

All information furnished regarding property for sale, rental or financing is from sources deemed reliable, but no warranty or representation is made to the accuracy thereof and same is submitted to errors, omissions, change of price, rental or other conditions prior to sale, lease or financing or withdrawal without notice. No liability of any kind is to be imposed on the broker herein.



FOR LEASE - FORMER BOTTLING FACILITY / 100% CLIMATE CONTROLLED W/ FLOOR DRAINS

UNIT #21 IN WAREHOUSE #1 - 63,259± SF

2612 CROWS LANDING ROAD, MODESTO, CA

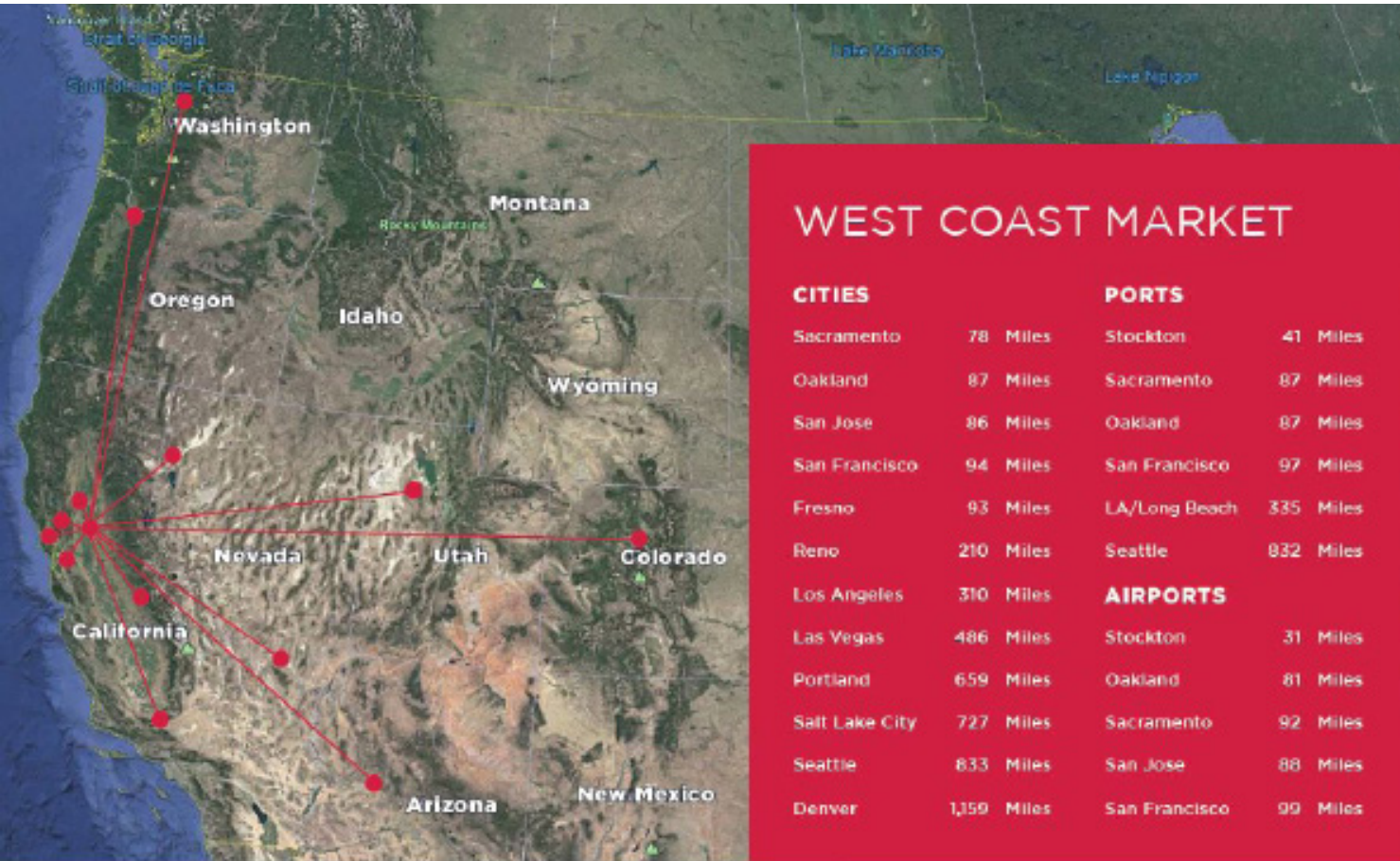

**Mark J. Reckers, SIOR**  
BRE #00938704  
mreckers@lee-associates.com  
C 209.471.4884  
D 209.983.6838

All information furnished regarding property for sale, rental or financing is from sources deemed reliable, but no warranty or representation is made to the accuracy thereof and same is submitted to errors, omissions, change of price, rental or other conditions prior to sale, lease or financing or withdrawal without notice. No liability of any kind is to be imposed on the broker herein.