

# 555 TULLY RD SAN JOSE, CA

Warehouse, Yard & Office for Sublease - PRIME LOCATION



**SCOTT MASON, President**  
scott@calcosf.com, 415.215.1937  
Calco Commercial, Inc. | Lic. 01036610

 **CALCO**  
COMMERCIAL, INC.

**REMINGTON HEATLEY**  
remington.heatley@kidder.com, 650.430.1562  
Kidder Matthews | Lic. 01907186

 **Kidder  
Matthews**

# 555 TULLY RD

## PROPERTY DETAILS:

- 8,602+/- Building
  - 3,782+/- sf clearspan warehouse
  - 4,820+/- sf office; divided over two floors & recently renovated (includes private, conference & open areas)
- 21,700+/- sf paved & fenced yard w/ drainage
- Clear span warehouse with drive-in access
- Additional private front parking lot
- \$15,500 / month, NNN
- NNNs estimated at \$2,180/month
- Available Now

[www.calcosf.com](http://www.calcosf.com)



The information contained herein has been obtained from sources we deem reliable, however we make no representations or warranties as to the accuracy of the information. References to square footage measurements are approximate.

3,782+/- sf clearspan warehouse



2,448+/- sf office



Pass-through drive-in loading doors



17,400+/- sf paved yard area





**SUBJECT PROPERTY**

**555 TULLY RD | SAN JOSE, CA**

**CLOSE PROXIMITY**

- US-101 ±1.8 Miles
- I-280 ±2.3 Miles
- SJC ±6.5 Miles

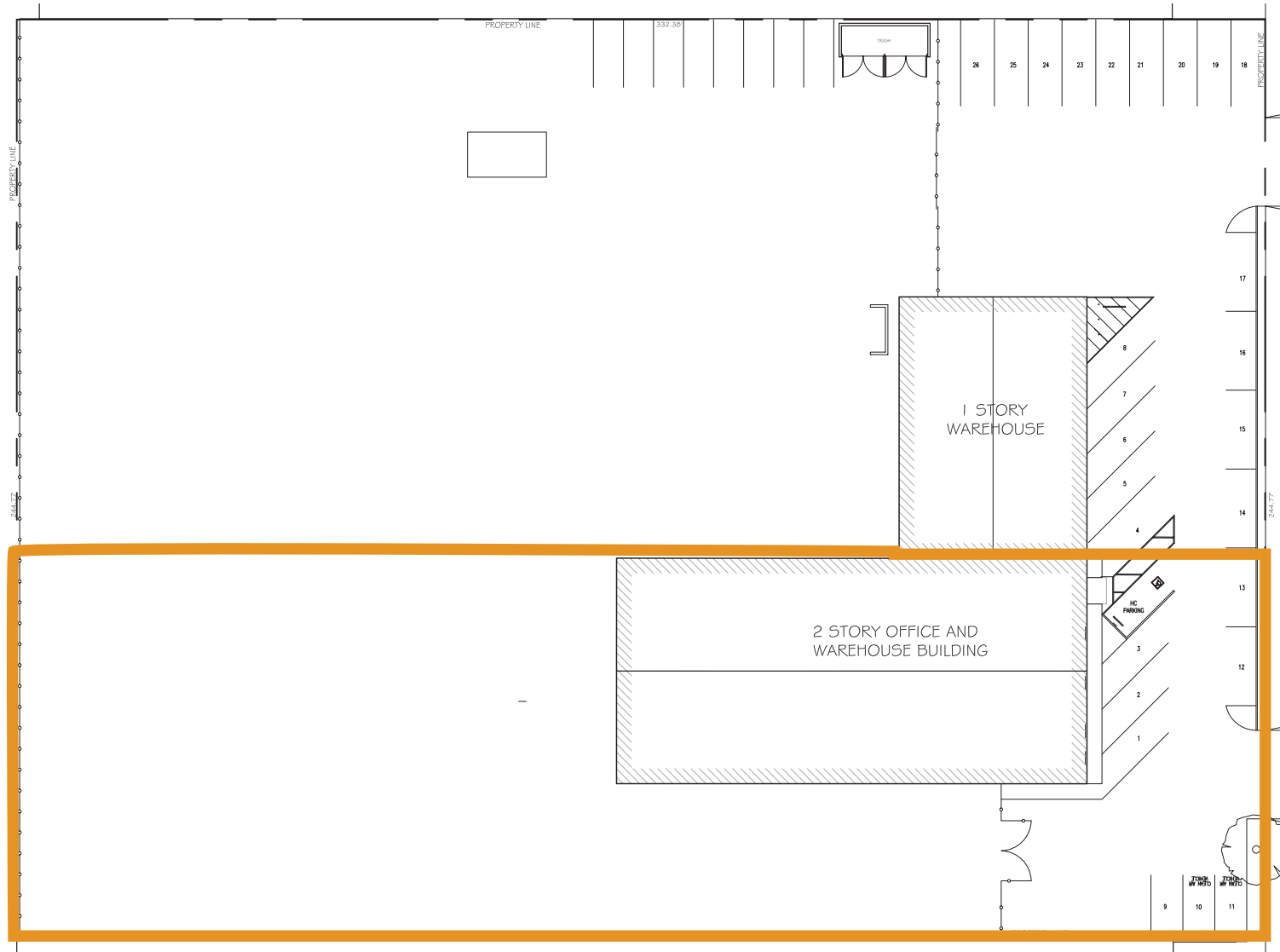

**SCOTT MASON, President**  
scott@calcosf.com, 415.215.1937  
Calco Commercial, Inc. | Lic. 01036610

 **CALCO**  
COMMERCIAL, INC.

**REMINGTON HEATLEY**  
remington.heatley@kidder.com, 650.430.1562  
Kidder Matthews | Lic. 01907186

 **Kidder  
Mathews**