



348 north
beverly
drive

BEVERLY HILLS
high street retail



property features

Now leasing **348 N Beverly Drive**, a high visibility retail opportunity on the famous luxury high street of North Beverly Drive, adjacent to the renown Rodeo Drive and Santa Monica Boulevard. **This second-generation salon offers great natural light, grand storefront signage and is strategically located across the street from a public parking garage. Click [here](#) for the virtual tour.**

size:	6,617 RSF (Total)	3,983 RSF (1st Level)	2,634 RSF (Mezzanine)
rent:	Available upon request		
availability:	October 2023		



your new
floorplan

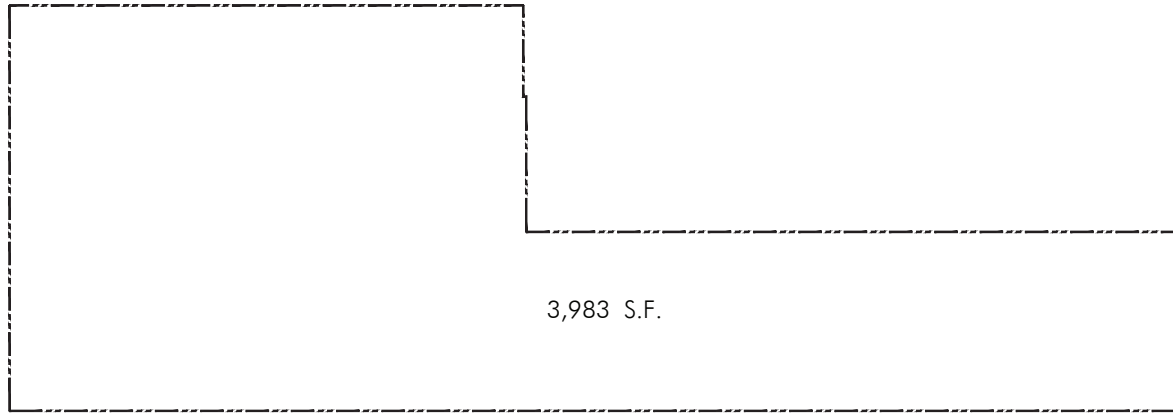

A GROUND FLOOR

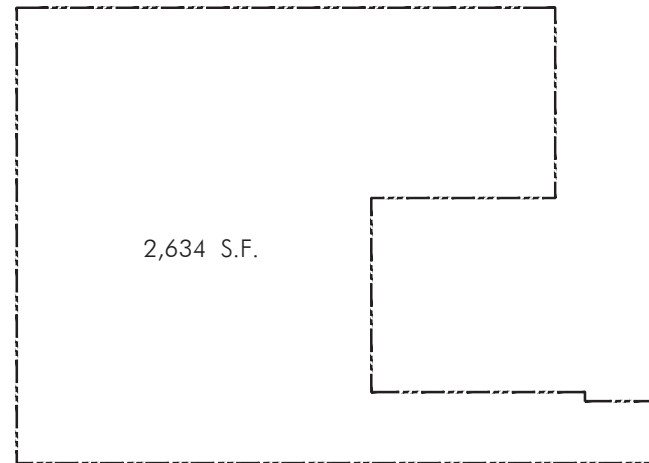

B MEZZANINE



\$2.03B
consumer spending

\$2.08M
avg. hh. net worth

1,237
local businesses

33,599
total population

welcome in NORTH BEVERLY DRIVE

348 N Beverly Dr. is situated in an enviable position on a coveted block of the famed shopping street, directly across from Erewhon's recently opened Beverly Hills location. The strength of the real estate in Beverly Hills and it's draw of the world's most affluent consumers ensures that 348 N Beverly Drive will meet the expectations of the highest quality retail professional and related occupiers.

neighboring tenants



NESPRESSO



HUBLOT

Crate & Barrel

CREED

EQUINOX

kreation
ORGANIC



STUART WEITZMAN

ZADIG & VOLTAIRE

ba&sh

JAMES PERSE

CRUSTACEAN



GUCCI

teuscher
Chocolates of Switzerland

diptyque
paris

& Other Stories

MaxMara



CÉLINE

sandro



INTERMIX



GOYARD

PRADA

ISAIA
NAPOLI

VHERNIER
MILANO

La COLOMBE
COFFEE ROASTERS

Berluti

ALEXANDER
MQUEEN



SCOTCH & SODA

RALPH LAUREN

bijan



a look at n. beverly

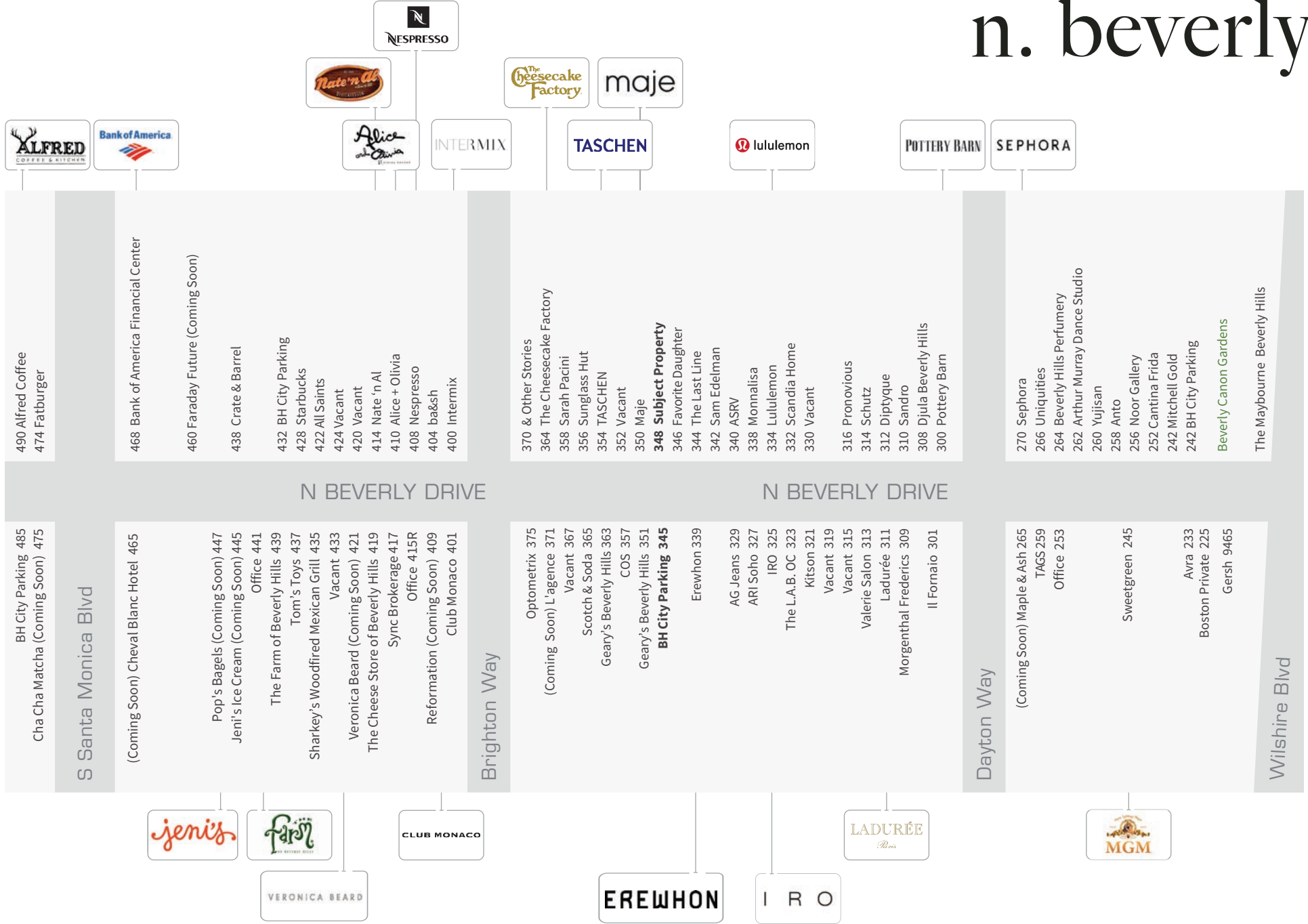



for leasing information,
contact us at:

Marisa Renfro
+1 949 922 7278
Associate
Marisa.Renfro@jll.com
Lic #02178774

Greg Briest
+1 310 595 3623
Senior Vice President
Greg.Briest@jll.com
Lic #01949565

Houman Mahboubi
+1 310 595 3621
Managing Director
Houman.Mahboubi@jll.com
Lic #01450237

Although information has been obtained from sources deemed reliable, neither Owner nor JLL makes any guarantees, warranties or representations, express or implied, as to the completeness or accuracy as to the information contained herein. Any projections, opinions, assumptions or estimates used are for example only. There may be differences between projected and actual results, and those differences may be material. The Property may be withdrawn without notice. Neither Owner nor JLL accepts any liability for any loss or damage suffered by any party resulting from reliance on this information. If the recipient of this information has signed a confidentiality agreement regarding this matter, this information is subject to the terms of that agreement. © 2023 Jones Lang LaSalle IP, Inc. All rights reserved.