

5

MAKEPEACE
ROAD

WESTFORD, MA

INDUSTRIAL
LAND



COMMERCIAL
O'BRIEN
PROPERTIES, INC

PROPERTY SUMMARY/SPECIFICATIONS

SUMMARY

5 Makepeace Road consists of 3.67 acres of industrially zoned land and an existing home located directly off of Route 3. There are permitted plans in place to build a 25,865 SF multi building, industrial-bay complex. An excellent opportunity for a contractor/business-owner or investor looking for an industrial land site in Westford.

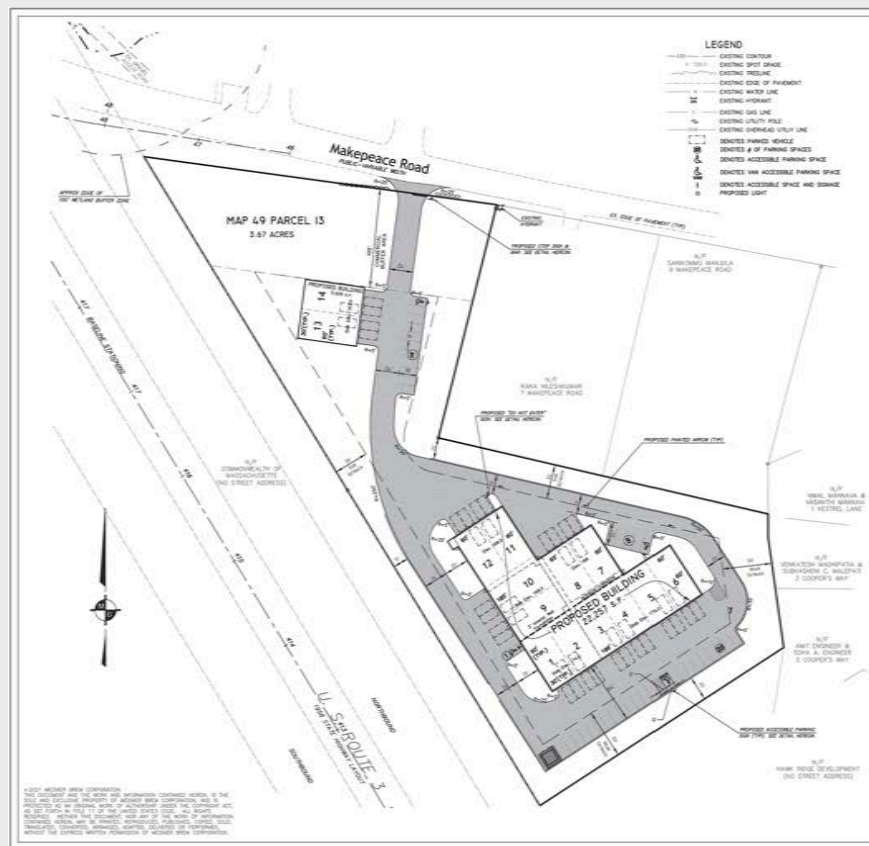

SPECIFICATIONS

- 3.67 Acres
- IC (Industrial) Zone
- Two (2) buildings permitted, totaling 25,865 SF
- Single family home
- Private Septic/Water
- 3 minutes to Route 3 on ramp
- Uses Allowed by right: research/office park, removal of sand/gravel, quarrying/mining, light manufacturing and wholesale trade.

THE PROPERTY/LOCATION

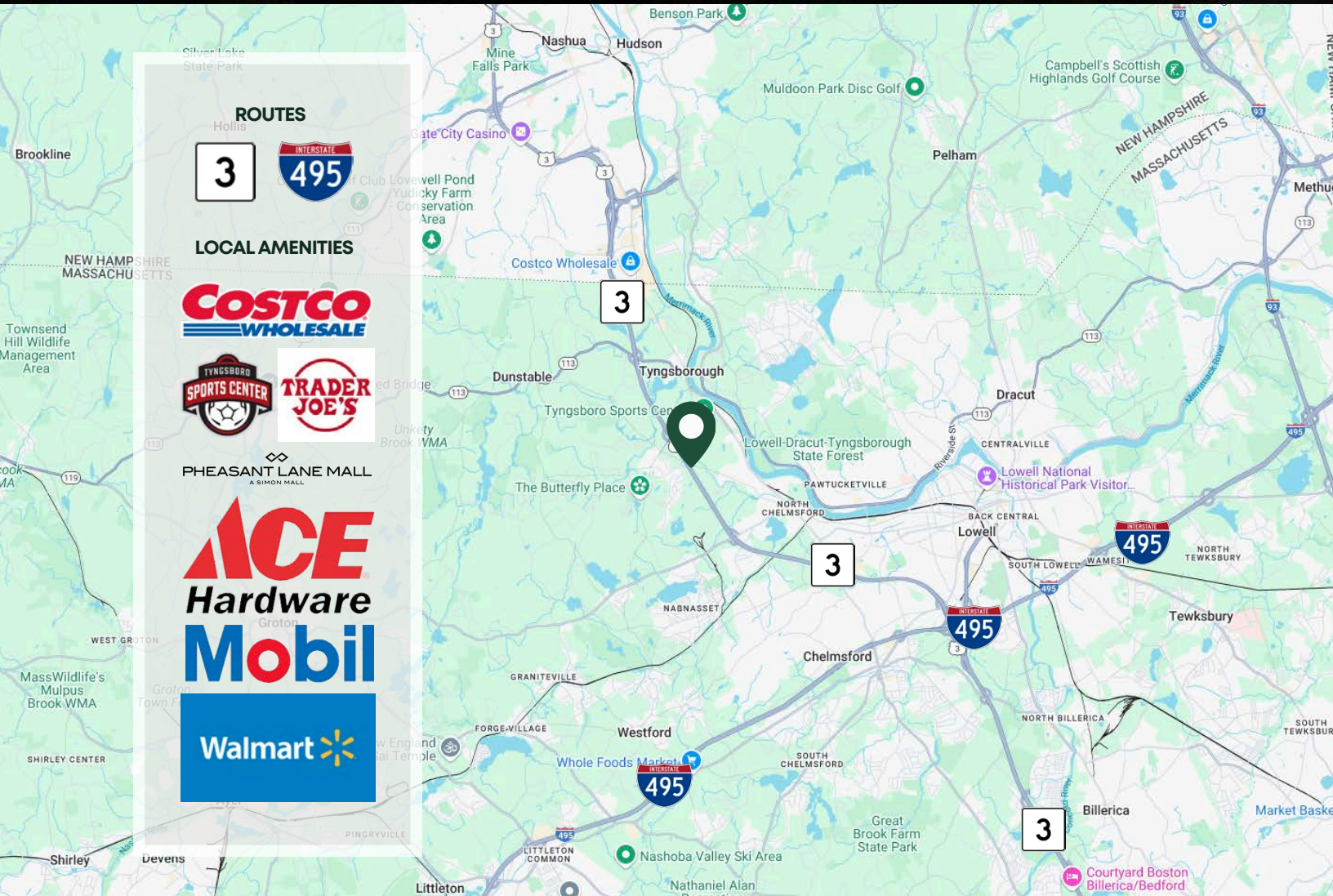

3.67 ACRES OF INDUSTRIAL LAND

5

MAKEPEACE ROAD

WESTFORD, MA

INDUSTRIAL LAND



COMMERCIAL
O'BRIEN
PROPERTIES, INC

ERIC O'BRIEN
PRESIDENT

978.369.5501
eric@obriencommercial.com

ROB MCGARRY
SENIOR ASSOCIATE

978.209.3211
rob@obriencommercial.com