

SOUTHWEST CROSSING

4615 W. LOOP 289
LUBBOCK, TX 79414

OFFICE SPACE FOR LEASE



DETAILED SUMMARY

LEASE RATE	\$11.00/SF NNN
EST. NNN's	\$2.10/SF annual
SF AVAILABLE	1,774 SF
RESTROOMS	2 private (1 ADA)
PRIVATE OFFICES	6
CONFERENCE ROOM	1 (250 SF)
DAILY TRAFFIC	15,648
PARKING	312 car parks



PROPERTY COMMENTS

Turnkey high visibility office space for lease. Recently renovated with nice finishes throughout space. Landlord will provide paint touch up or new paint throughout. Large conference room could be split into a reception area and additional private office. Two updated private restrooms and a break room. Alley access with dumpster.

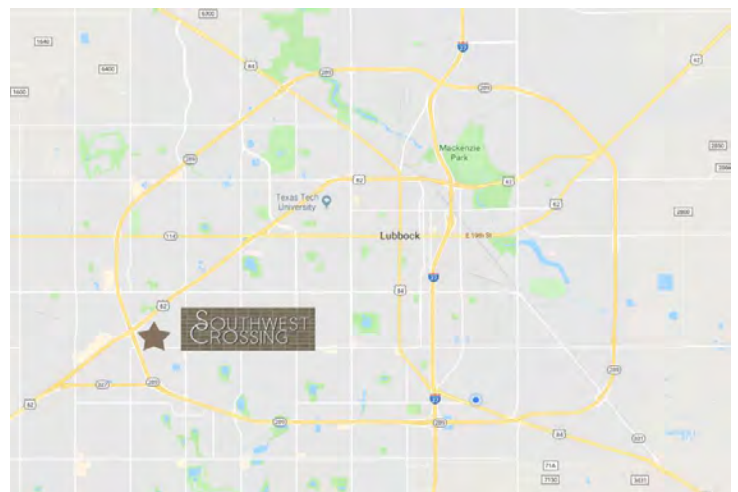

Wilkerson

PROPERTIES INC.

Commercial & Industrial Real Estate Services

Will Wilkerson 214.843.8221

will@wilkersonproperties.com

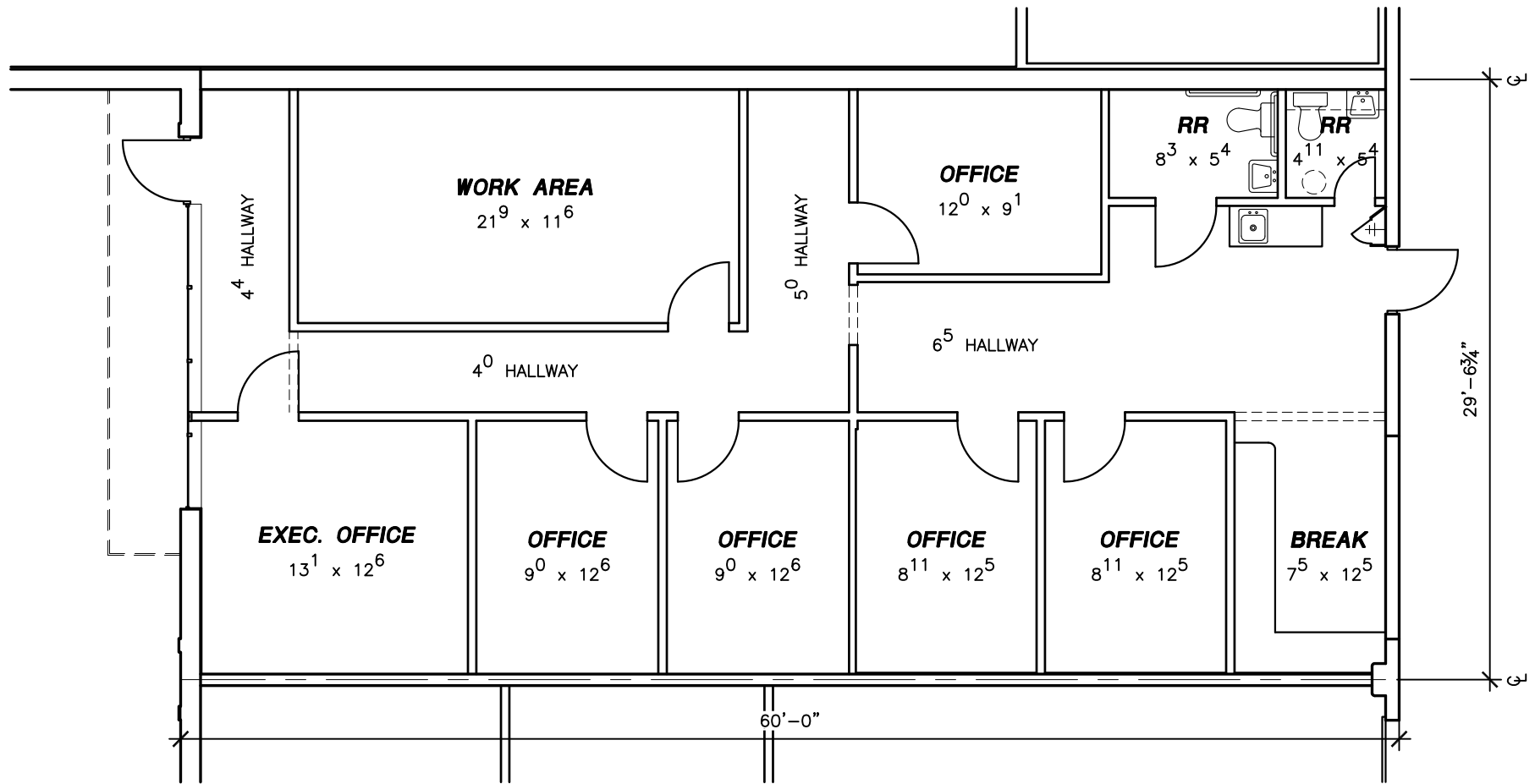

EXIST. FLOOR PLAN

SCALE: 1/8" = 1'-0"

AREA = 1,774 S.F.



Commercial & Industrial
Development, Management & Brokerage
Phone: (806) 474-2223
Fax: (806) 474-2216
501 E. 66th Street
Lubbock, Texas 79404

Southwest Crossing	Date: 01/10/2019	Rev:
4615 W. Loop 289	Drawn by: JWT	
Lubbock, Texas 79414	Checked by:	
G:\SWC\SWC-FLOOR.dwg, 4615-FLOOR, 1/10/2019 1:44:48 PM		

A2

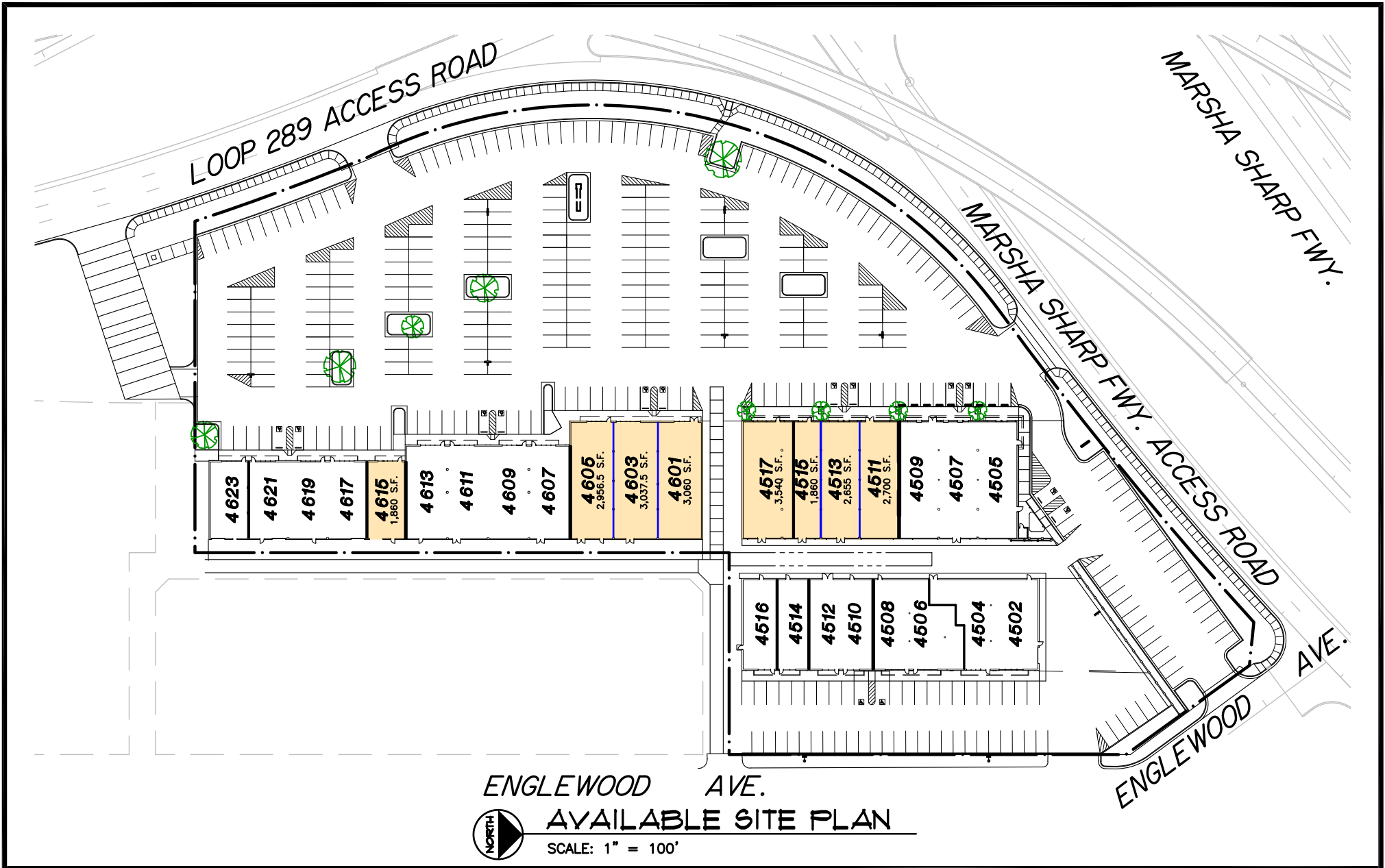

Wilkerson
PROPERTIES INC.

Commercial & Industrial
Development, Management & Brokerage
Phone: (806) 474-2223
Fax: (806) 474-2216
501 E. 66th Street
Lubbock, Texas 79404

Southwest Crossing

Date: 07/10/2020

Rev:

Lubbock, Texas 79414

Checked by:

A1

G:\SWC\SWC-SITE.dwg, 85x11-H-T, 7/10/2020 11:40:41 AM