

**DISTRIBUTION/WAREHOUSE  
FACILITY FOR LEASE**

**209,000 SF AVAILABLE  
IMMEDIATELY**

**SUPERIOR LOCATION  
IN ORANGEBURG**

# 225 WOODBINE DR

ORANGEBURG, SOUTH CAROLINA 29115

**HAGOOD MORRISON** SIOR, MBA, CRE  
Executive Vice President  
+1 843 270 5219  
hagood.morrison@bridge-commercial.com

**JOHN BEAM**  
Associate Vice President  
+1 843 810 6868  
john.beam@bridge-commercial.com

**HAGOOD S. MORRISON (HAGOOD II)** SIOR  
Vice President  
+1 843 830 9108  
hs.morrison@bridge-commercial.com

**BROOKS COURTNEY**  
Senior Associate  
+1 859 327 8749  
brooks.courtney@bridge-commercial.com



# 225 WOODBINE DR SITE PLAN & SPECS

■ = DOCK HIGH DOOR

■ = DRIVE IN DOOR

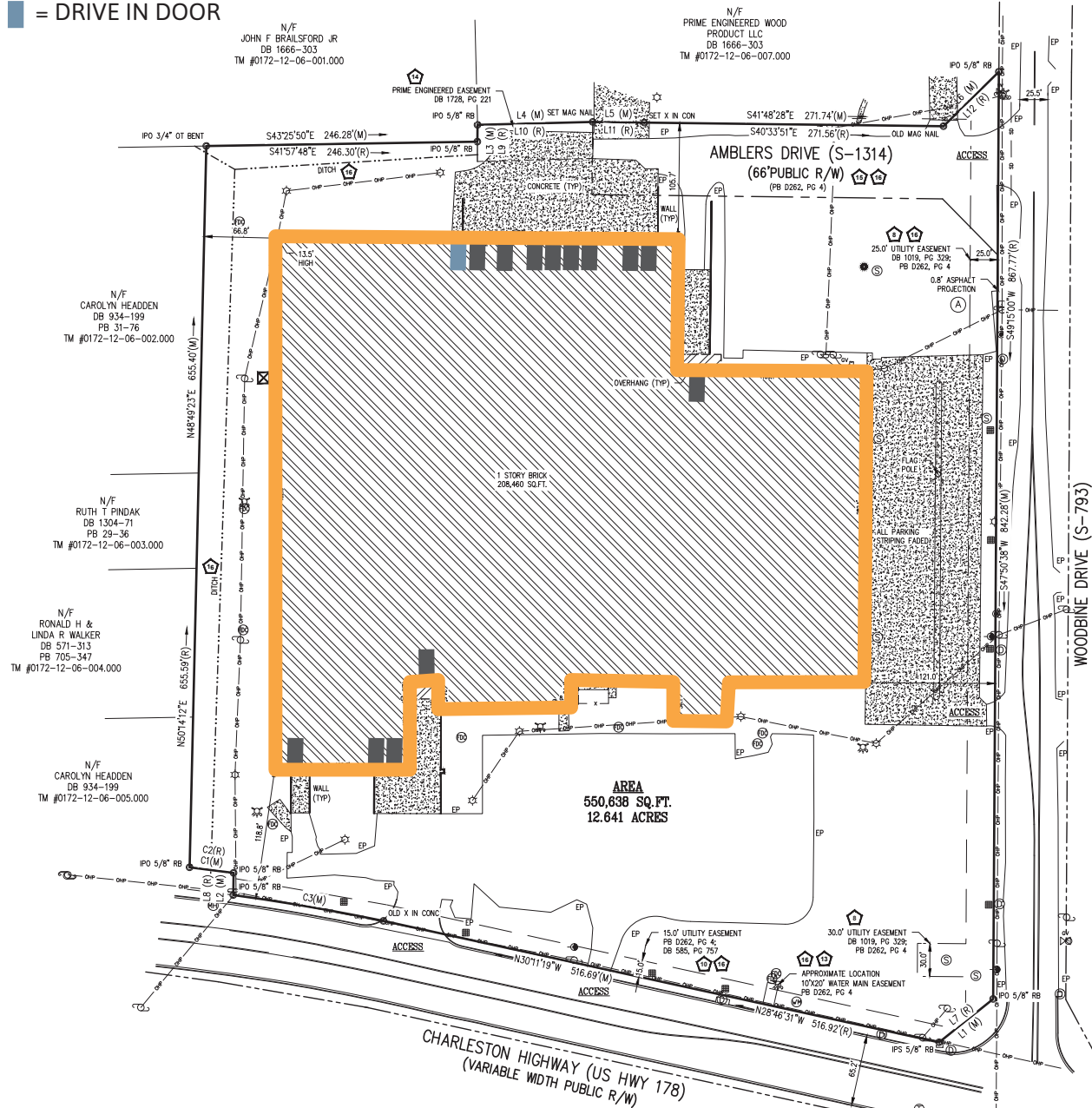

## BUILDING SPECIFICATIONS

<b>BUILDING SIZE:</b>	209,000 SF
<b>DIVISIBILITY:</b>	50,000 SF
<b>AVAILABLE:</b>	Immediately
<b>TMS:</b>	172-12-06-006
<b>COUNTY:</b>	Orangeburg County
<b>CLEAR HEIGHT:</b>	12' - 14'
<b>DOCK HIGH DOORS:</b>	14
<b>DRIVE-IN DOORS:</b>	1
<b>BUILDING DIMENSIONS:</b>	864' x 310'
<b>EMPLOYEE PARKING:</b>	125 Spaces
<b>TRAILER PARKING:</b>	62 Stalls
<b>FLOOR THICKNESS:</b>	4" - 6" Reinforced Concrete
<b>ELECTRIC PROVIDER:</b>	Orangeburg City Public Utility
<b>SPRINKLER:</b>	Wet, 100%
<b>LOADING BAY SPACING:</b>	60' x 50'
<b>INTERIOR BAY SPACING:</b>	30' x 40'
<b>TRUCK COURT DEPTH:</b>	190'
<b>LIGHTING:</b>	Fluorescent Metal Halide
<b>TRUCKERS OFFICE:</b>	Yes
<b>MAIN OFFICE:</b>	5,000 SF
<b>CONSTRUCTION:</b>	Block
<b>ROOF:</b>	Rubber Membrane TPO



# PHOTOS

225 WOODBINE DR



225 WOODBINE DR

# INTERIOR PHOTOS





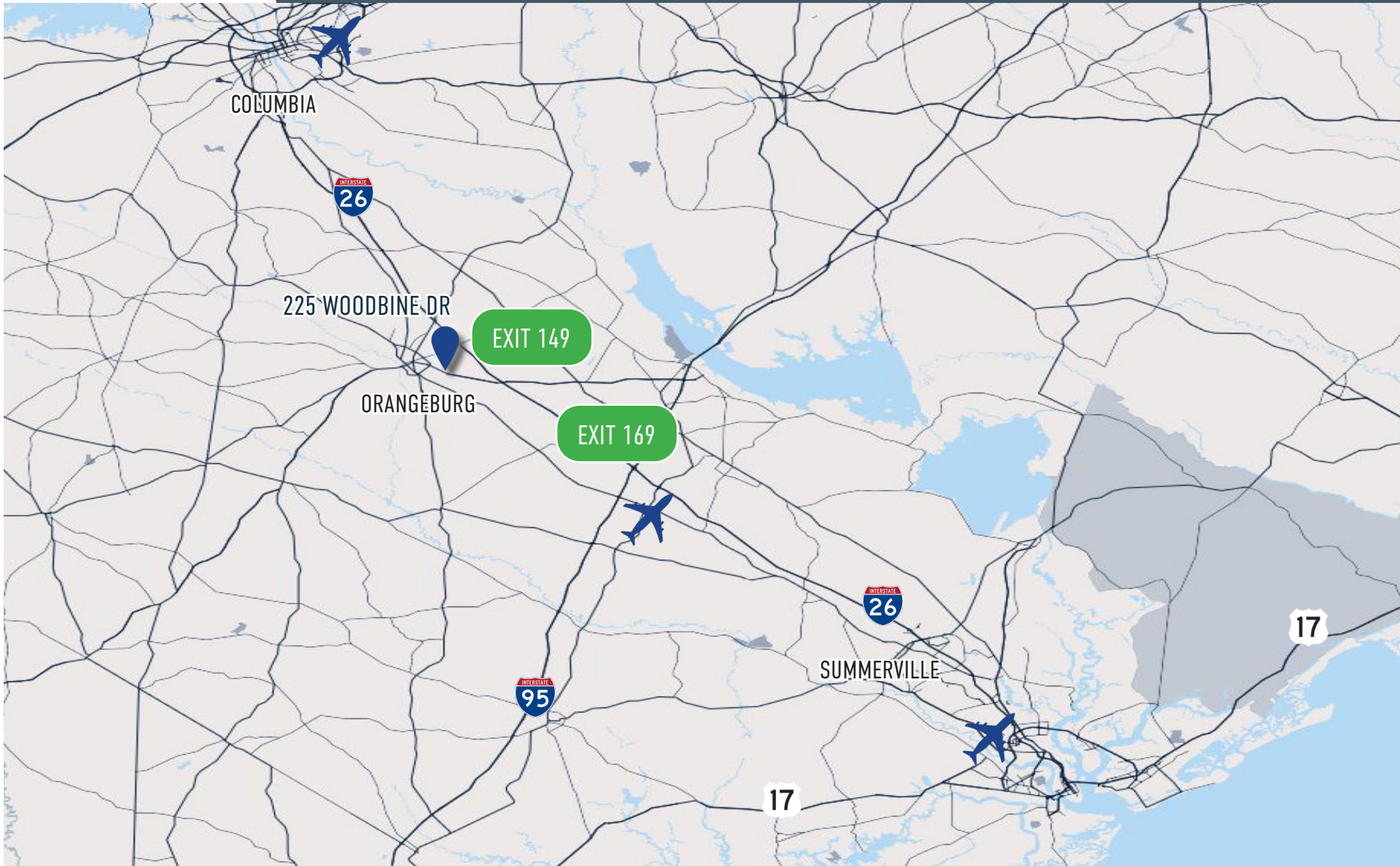

225 WOODBINE DR

# LOCATION MAP

## DRIVE TIME ANALYSIS:

TO I-26 EXIT 149:	10 Minutes	6.5 Miles
TO I-26 EXIT 169:	20 Minutes	21.4 Miles
TO I-26 :	10 Minutes	6.5 Miles

# ORANGEBURG EMPLOYERS MAP

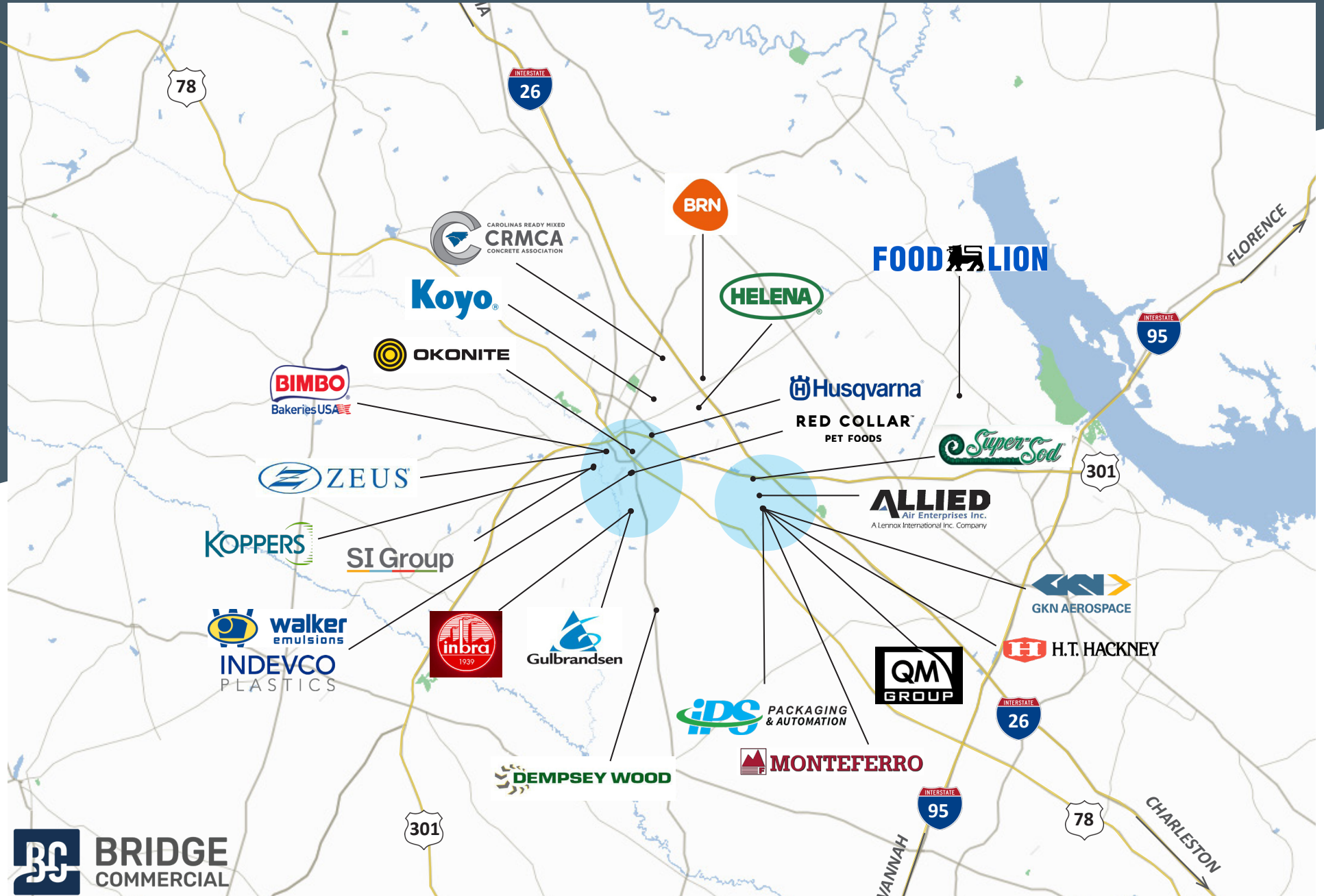

Bridge Commercial makes no guarantees, representations or warranties of any kind, expressed or implied, including warranties of content, accuracy and reliability. Any interested party should do their own research as to the accuracy of the information. Bridge Commercial excludes warranties arising out of this document and excludes all liability for loss and damages arising out of this document.