

GENERAL NOTES

1.

THE GENERAL CONTRACTOR SHALL ALLOCATE 24 MAN HOURS TO BE USED IN HANGING PHOTO ART WITH APPROVED FASTENERS, BOLTING DOWN EQUIPMENT AS NEEDED TO FLOORS AND WALLS, I.E. DRESSERS, CROCK POTS, REFRIGERATORS, ETC. AND MISC. ITEMS WHICH THE CENTER DIRECTORS NEED TO HAVE PERMANENTLY ATTACHED TO WALLS FOR FLAT SURFACES.

2.

SEE INTERIOR ELEVATIONS FOR ANY ADDITIONAL CASEWORK OR EQUIPMENT NOT SHOWN ON THIS PLAN.

3.

SEE 15/A-6.0 FOR ADDITIONAL DIMENSIONING OF CASEWORK.

4.

CONTRACTOR SHALL COORDINATE ALL TRADES TO ENSURE THERE ARE NO OUTLETS, INTERCOMS, SWITCHES, THERMOSTATS, ETC. LOCATED IN ANY DISPLAY BOARD (P).

5.

PROVIDE WOOD BLOCKING FOR ALL WALL MOUNTED FIXTURES, AND EQUIPMENT.

6.

ALL WORK TABLES, SINKS, TILE, MILLWORK, ETC. TO BE CONTINUOUSLY CAULKED AT EDGES.

SYMBOL LEGEND

I

WARMING PANTRY DESIGNATION - REFER TO SHEET A-1.3

A

CASEWORK DESIGNATION - REFER TO THIS SHEET

◇

EQUIPMENT DESIGNATION - REFER TO THIS SHEET

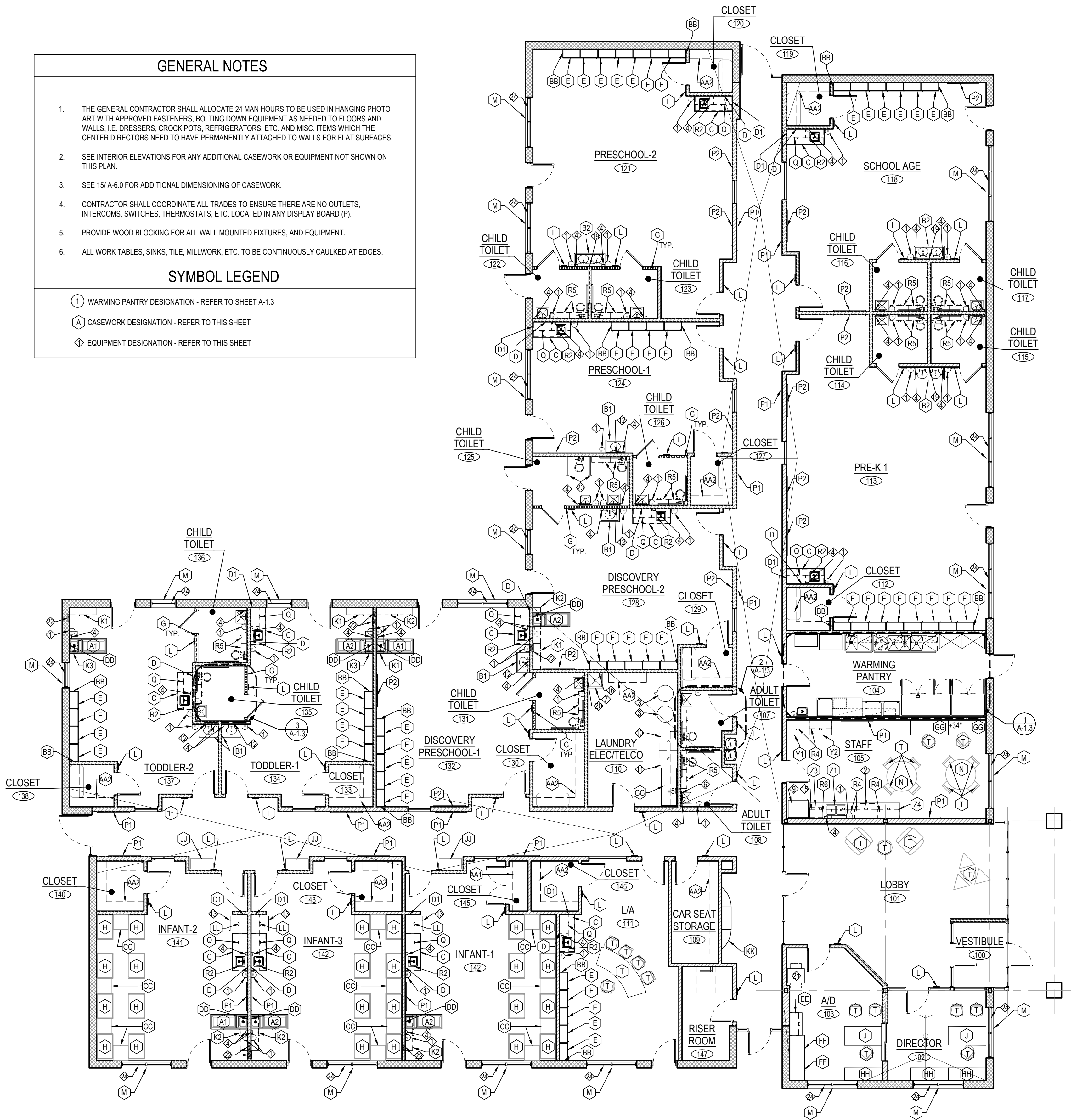

CASEWORK SCHEDULE

MARK	PRODUCT NUMBER	MANUF.	DESCRIPTION	DIMENSIONS (INCHES)			MOUNTING		RESPON. PROVIDED/ INSTALLED	SERVICES				REMARKS
				W	D	H	WALL	FLOOR		ELECTRIC	TELE/ DATA	PLUMBING	OTHER	
A1	8914A	●	CHANGE TABLE RH	60"	23"	37"			●					W/ POP OUT TRASH & CONTOURED ENDSPLASH #TR874
A2	8913A	●	CHANGE TABLE LH	60"	23"	37"			●					W/ POP OUT TRASH & CONTOURED ENDSPLASH #TR874
B1	2360R	●	SINGLE VANITY	31"	21"	18"	●			●				FOR MOUNTING HEIGHTS SEE INTERIOR ELEVATIONS
B2	2364R	●	DOUBLE VANITY	49"	21"	18"	●			●				FOR MOUNTING HEIGHTS SEE INTERIOR ELEVATIONS
C	2911A	●	PREP TABLE W/ SINK	VAR	24.6"	33"			●	●				WIDTH VARIES - SEE PLAN, LOCKABLE
D	2886R	●	SOLID BACKSPLASH	60"	0.5"	20"	●							CUT DOWN IN FIELD WHERE SHORTER THAN COUNTER
D1	2901R	●	SOLID ENDSPLASH	24.5"	0.5"	20"	●			●				PROVIDE DEEP PLASTIC BASKETS & OVERLAY PANEL #TR567 AT ENDS
E	2566A	●	4-UNIT CUBBIE	28"	14"	62"				●				
F	2920A	●	TEACHER STORAGE	48"	24"	72"			●					
G	2882R, 2883R, 2884R	●	SS WALL CAP- 6" L, L, T	-	-	-				●				COMES IN 6' LENGTH, A 'T' SHAPE AND A 'L' SHAPE- CAP ALL LOW WALLS
H	-	●	CRIB	40"	27"	41"				●				
J	2555A	●	DIRECTOR'S DESK	60"	30"	35"			●					
K1	2828A	●	DIAPER STORAGE	46"	14.5"	24"	●			●				
K2	KC-0005	●	DIAPER STORAGE	57"	14.5"	24"	●			●				
K3	KC-0007	●	DIAPER STORAGE	35"	14.5"	24"	●			●				
L	-	●	CLASSROOM SIGNAGE	10" dia						●				REFER TO TENANT INTERIOR SIGN DRAWINGS AND COORDINATE WITH SIGN VENDOR.
M	5346	●	SS WINDOW SILL	12"	5"	1/2"								
N	9650R	●	ROUND STAFF TABLE	48"	48"	29"				●				
P1	-	●	DISPLAY BOARD	48"	-	-	●			●				SEE 5/A-6.0 FOR MOUNTING HEIGHTS
P2	-	●	DISPLAY BOARD	48"	-	-	●			●				SEE 5/A-6.0 FOR MOUNTING HEIGHTS
P3	-	●	DISPLAY BOARD	36"	-	-	●			●				SEE 5/A-6.0 FOR MOUNTING HEIGHTS
P4	-	●	DISPLAY BOARD	30"	-	-	●			●				SEE 5/A-6.0 FOR MOUNTING HEIGHTS
Q	2829A	●	WALL STEREO CABINET	30"	13.5"	35"	●			●				
R2	2628A	●	WALL CABINET	30"	13.5"	35"	●			●				
R3	-	●	REFRIGERATOR CABINET	36"	13.5"	24"	●			●				
R4	2574A	●	WALL CABINET	36"	13.5"	35"	●			●				
R5	2879A	●	WALL CABINET	30"	9.5"	35"	●			●				
R6	-	●	MICROWAVE CABINET	36"	13.5"	35"	●			●				
S	2937A, 2906R	●	COT STORAGE COMBO	61.5"	23.8"	94"	●			●				
T	-	●	LOOSE FURNITURE	-	-	-				●				
X	NOT USED	-	-	-	-	-								
Y1	2843A	●	LAMINATOR TABLE	36"	24"	35"	●			●				
Y2	2846A	●	LAMINATOR TABLE	36"	24"	35"	●			●				
Z1	2840A	●	SINK BASE	36"	24"	35"	●			●				
Z2	NOT USED	●	BASE CABINET	30"	24"	35"	●			●				
Z3	2842A	●	BASE CABINET	24"	24"	35"	●			●				
Z4	2843A	●	BASE CABINET	36"	24"	35"	●			●				
AA1	2810R	●	SHELVING	96"	24"		●			●				SEE DETAIL 11/A-7.0
AA2	2609A	●	SHELVING	96"	14.7"		●			●				SEE DETAIL 5/A-7.0
BB	2567R	●	OVERLAY END PANEL	-	14"	64"	●			●				
CC	-	●	INFANT DRESSOR	24"	24"	-	●			●				
DD	2885R	●	CHANGE SS END SPLASH	27"	-	22.5"	●			●				
EE	2947A	●	DATA CENTER	36"	25"	84"	●			●				
FF	2944A	●	TALL STORAGE	36"	25"	84"	●			●				
GG	2880R	●	COUNTERTOP	VAR	25"	5"	●			●				
HH	2550	●	CREENZA	60"	21"	30"	●			●				
JJ	2954A	●	BOOTIE BENCH	32"	15"	18"	●			●				W/ STORAGE BIN BELOW
KK	2942A	●	FAMILY CENTER	98.5"	15"	34"	●			●				
LL	2791A	●	REFRIGERATOR CABINET	30"	13.5"	23"	●			●				

FURNITURE NOTE: ALL STEVENS CASEWORK SHALL BE PL-2. REFER TO FINISH SCHEDULE ON A-1.1. COORDINATE W/ CASEWORK MANUFACTURER TO ENSURE THE PROPER FINISHES ARE IN THE CORRECT AREAS.  
SEE INTERIOR ELEVATIONS FOR EXTENT OF NOTES ON ALL CASEWORK.  
ALL MILLWORK SHALL HAVE THE EDGES AGAINST WALLS SEALED AND FINISHED WITH A SCRIBE.

EQUIPMENT SCHEDULE

MARK	DESCRIPTION	DIMENSIONS (INCHES)			MOUNTING		RESPON. PROVIDED/ INSTALLED	SERVICES				REMARKS
		W	D	H	WALL	FLOOR		ELECTRIC	TELE/ DATA	PLUMBING	OTHER	
1	PAPER TOWEL DISPENSER	9.25"	8.75"	11.5"	●			●				G.P. - SOFPULL #58204; VERIFY INSTALLATION ALLOWS DOOR TO OPEN COMP.
2	DISHWASHER	24"	24"	32"	●			●				GE - GLDT690DBB
3	WATER HEATER	-	-	-				●				SEE PLUMBING DRAWINGS FOR ADDITIONAL INFORMATION
4	SOAP DISPENSER	5.6"	4.6"	10.7"	●			●				REQUIRED VENDOR 'ECO LAB' SEE NOTE 3
5	GRAB BAR	-	-	-	●			●				SEE SHEET A-1.3 FOR SIZES AND MOUNTING HEIGHTS
6	REST ROOM MIRROR	24"	1"	36"	●			●				BOBRICK B283-2436 - MOUNT BOTTOM OF REFLECTIVE SURFACE 40" A.F.F.
7	MOP SINK	24"	24"	10"	●			●				SEE PLUMBING DRAWINGS FOR ADDITIONAL INFORMATION
8	TOILET PAPER DISPENSER	13.6"	5.73"	8.6"	●			●				GEORGIA PACIFIC - #59206 SEE NOTE 1
9	REFRIGERATOR (STAFF)	32"	30"	65"				●				16-17 CU.; COLOR: BLACK
10	DRYER	29"	32.3"	40.8"	●			●				WHIRLPOOL - WED9290FW, PEDESTAL - XHPW115DW
11	WASHER	29"	32.3"	40.8"	●			●				LG - #VM8100HVA, PEDESTAL - WDP5V
12	SMALL MIRROR	18"	1"	24"	●			●				BOBRICK B165 1824 - MOUNT 1" ABOVE BACK SPLASH - MOUNTED HORIZONTAL
13	REFRIGERATOR (INFANTS)	24.25"	28"	61.75"	●			●				WHIRLPOOL WRT111SFD8; TO BE PROVIDED BY CONTRACTOR
14	ELECTRIC WATER COOLER	-	-	-	●			●				SEE PLUMBING DWGS FOR ADDITIONAL INFORMATION
15	MICROWAVE	21"	16"	12"	●			●				GE - JES1460DSBB
16	MOP HOOKS	-	-	-	●			●				MOUNTED ABOVE FLOOR SINK
17	SANITARY NAPKIN RECEPTACLE	-	-	-	●			●				NOT USED
18	CONVEX MIRROR	-	-	-	●			●				NOT USED
19	MIRROR	36"	1"	18"	●			●				BOBRICK B165 1836 - MOUNT 1" ABOVE BACK SPLASH - MOUNTED HORIZONTAL
20	MOP SINK SOAP DISPENSER	-	-	-	●			●				REQUIRED VENDOR AND INSTALLER 'ECO LAB' SEE NOTE 2
21	COPIER	-	-	-				●				
22	RECESSED TRASH RECEPTACLE	17"	8"	31"	●			●				BOBRICK B-3644 - MOUNTING HEIGHT 3'-8"; SEE ELEVATION 15/ A-6.0
23	TOILET PARTITION	-	-	-	●			●				SEE DETAIL 11/ A-7.0
24	WINDOW SHADES	-	-	-	●			●				

- NOTES:
- ALL GEORGIA PACIFIC DISPENSERS ARE PROVIDED AT NO COST. CONTACT GP NATIONAL ACCOUNT MANAGER, CHRISTOPHER FEMAL AT CHRISTOPHER.FEMAL@GAPAC.COM
  - MOP SINK SOAP DISPENSER TO BE SUPPLIED BY GC THROUGH REQUIRED VENDOR 'ECO LAB' AND INSTALLED BY VENDOR. GC TO PLACE ORDER 30 DAYS PRIOR TO INSTALL. ECO LAB WILL SHIP MATERIALS TO SITE, GC TO STORE ON SITE UNTIL INSTALL. ECO LAB REPRESENTATIVE: CHRIS MARCH, SR. ACCOUNT SPECIALIST 8300 CAPITAL DRIVE GREENSBORO, NC 27409 727-242-3758 CHRIS.MARCH@ECOLAB.COM
  - ECO LAB HAND SOAP DISPENSER TO BE PROVIDED AND INSTALLED BY G.C. THROUGH THROUGH ECO LAB VENDOR ABOVE

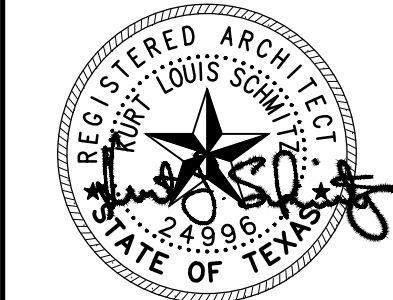

**ARCHITECTS, INC.**  
Lakewood, Ohio 44107  
17710 Detroit Avenue  
Phone (216) 521-5134  
Fax (216) 521-4824  
www.aadarchitects.com

**KinderCare Education**  
Plano, TX  
COMMUNICATIONS PARKWAY  
PLANO, TX

REVISIONS

#	DATE	TYPE	PERMIT & BID
1	07/14/17		
2			
3			
4			
5			
6			
7			
8			
9			

CASEWORK AND EQUIPMENT PLAN

DATE 07/14/17

JOB NO. 17150

**A-1.2**  
SHEET NO.