

# 90,455 SF

Industrial Space For Lease



## Prologis Union City 14



33001 Dowe Avenue  
Union City, California 94587, USA

### LOCATION

- Close proximity to Oakland International Airport and the Port of Oakland, with excellent access to Interstate 880 via Alvarado-Niles Road or Whipple Road. Easy access to Highway 92/San Mateo Bridge & Highway 84/Dumbarton Bridge.

### FACILITY

- ±90,455 SF Warehouse
- ±4,108 SF Office
- ±28' Clear Height
- 16 Dock-High Doors
- 800 Amps @ 277/480 Volts Power
- Fully Sprinklered
- ±40' x 40' Column Spacing
- Fenced/Secure
- Call broker for Rate & Touring Instructions
- Available Now

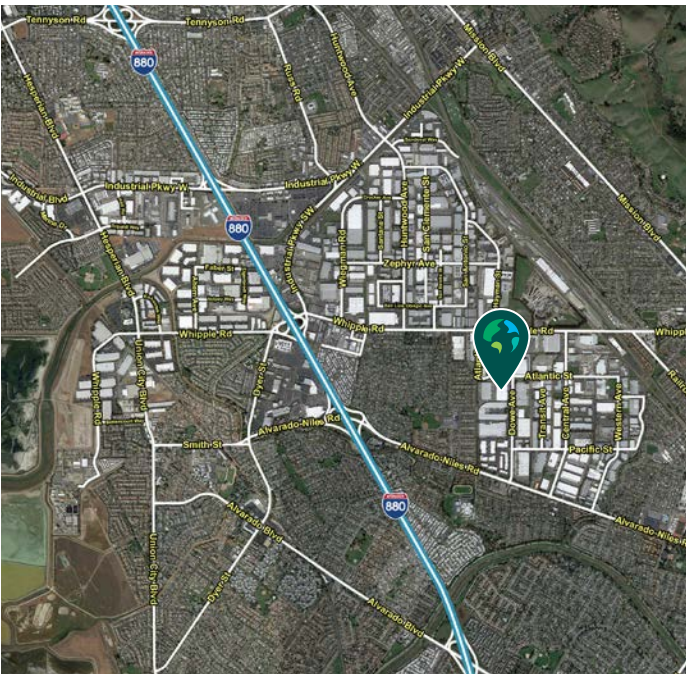

**Prologis Essentials: your single-source service for efficient move-in and operations at [prologisessentials.com](https://www.prologisessentials.com)**

# 90,455 SF

## Industrial Space For Lease



# Prologis Union City 14

33001 DOWE AVENUE  
UNION CITY  
±90,455 SF

- AVAILABLE
  - LEASED
  - BACKGROUND LAND
  - DOCK DOOR
- NORTH

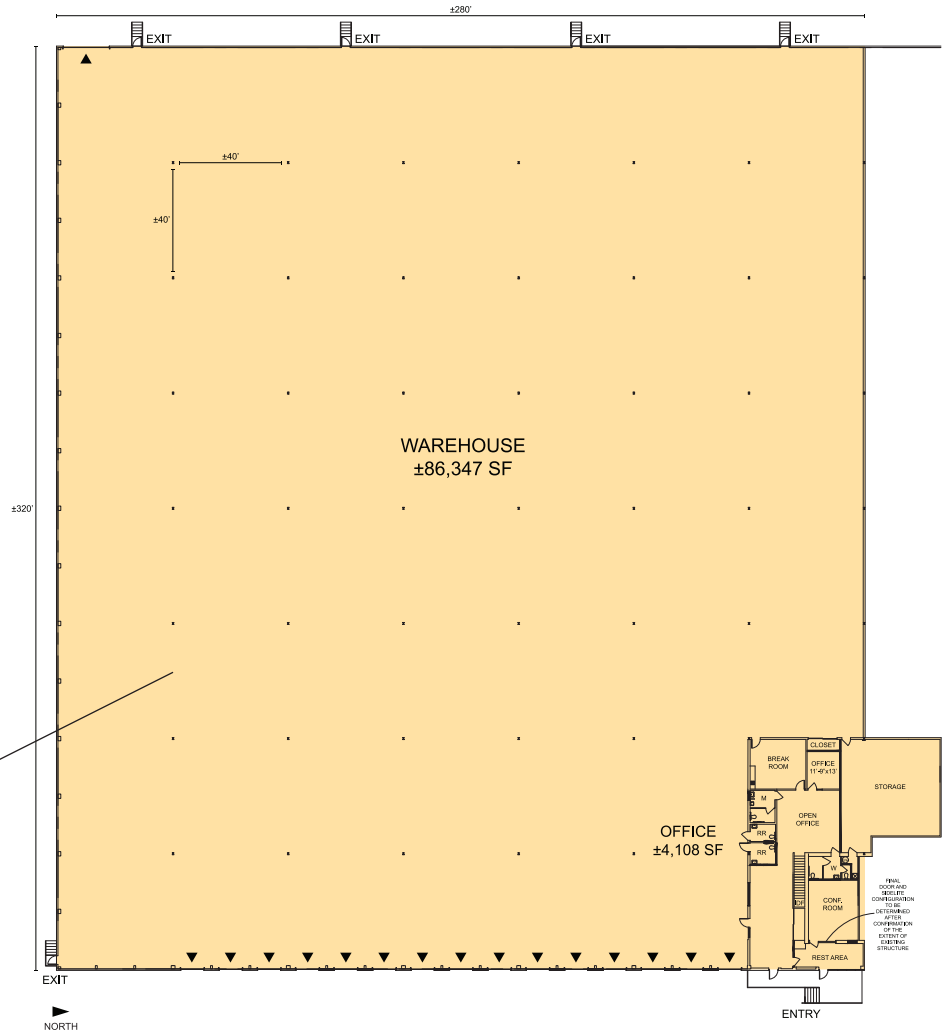
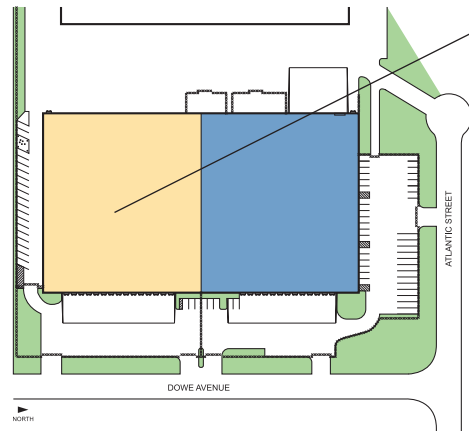

Proposed floor plan



**KBC Advisors**  
Sam Higgins, SIOR  
sam.higgins@kbcadvisors.com  
cell +1 415 987 8798  
312 Clay Street, Suite 180  
Oakland, CA 94607 USA  
DRE License# 01329023



**KBC Advisors**  
Tom Damaschino, SIOR  
tom.damaschino@kbcadvisors.com  
cell +1 510 599 1189  
312 Clay Street, Suite 180  
Oakland, CA 94607 USA  
DRE License# 01261227



**Prologis**  
Jordan Lewis  
jlewis2@prologis.com  
ph +1 510 661 4025  
680 N. McCarthy Blvd., Suite 100  
Milpitas, CA 95035 USA  
DRE License# 02034839

**Prologis Essentials: your single-source service for efficient move-in and operations at [prologisessentials.com](http://prologisessentials.com)**

No warranty or representation, expressed or implied, is made as to the accuracy of the information contained herein, and same is submitted subject to error and omissions.

# GO BEYOND THE BUILDING

**Prologis Essentials** is the single source for warehouse solutions to keep facilities running at a high level of efficiency. Our offerings are easy and convenient to procure and implement, providing support for move-in, moving forward, and growing any business.

## MATERIAL HANDLING

- A. Racking & Shelving
  - I. Layout and Design
  - II. New and Used Material
  - III. Permitting Services
  - IV. Buybacks and Liquidations
- B. Forklifts
  - I. Electric and Propane
  - II. New, Used, and Refurbished
  - III. Rentals
  - IV. Service



## ENERGY

- A. Solar
- B. LED Lighting
- C. EV Charging
- D. Generators



## AUTOMATION/ ADVANCED SOLUTIONS

- A. Conveyor and Sortation
- B. Locus Robotics
- C. VLMs, Shuttles, Carousels, AS/RS
- D. Pick Modules/Mezzanine

## SMART BUILDING

- A. Fiber Backbone
- B. Network and Cabling
- C. Internet Service
- D. Access Points
- E. Security Cameras and Monitoring Services
- F. Badge Access and Control
- G. Barcode Scanning



## PRODUCTS AND SERVICES

- A. Moving and Relocation Services
- B. HVLS Fans
- C. Office Furniture
- D. In-Plant Modular Offices
- E. Yard Ramps
- F. Janitorial Service
- G. Pest Control



**John Kenley**  
Essentials Solutions Manager  
jkenley@prologis.com  
415-733-9402

 **PROLOGIS**<sup>®</sup>  
ESSENTIALS

[www.prologisessentials.com](http://www.prologisessentials.com)