

For Sublease

3840 Metro Drive, Stockton, CA

Building Features

Building Size	±45,602 SF
Available	±23,032 SF
Office	±1,030 SF
Dock Doors	2
Grade Level Doors	2
Clear Height	±21' - 22'
Warehouse Lighting	T-8
Power	800 amps 277/480v
Fire Suppression	.33 GPM / 3,000 SF
Zoning	I-L (City of Stockton)
Year Built	2007
Master Lease Expiration	10/31/2026
Sublease Rate	Contact Broker

Overview

- Warehouse facility in well-established industrial park.
- Close proximity to major California supply chain routes including: HWY 99 & Interstate 5, which access Interstate 580 to the Bay Area and the BNSF Intermodal.



Tim Mustin
Managing Director
tim.mustin@jll.com
+1 209 390 1687
License #01857876

Michael Matter
Vice President
michael.matter@jll.com
+1 209 390 1702
License #01435801

John Fondale, SIOR
Managing Director
john.fondale@jll.com
+1 209 390 1694
License #01017415

Michael Sharapata
Senior Managing Director
michael.sharapata@jll.com
+1 509 822 0088
License #01737708

For Sublease

3840 Metro Drive, Stockton, CA

±23,032 SF

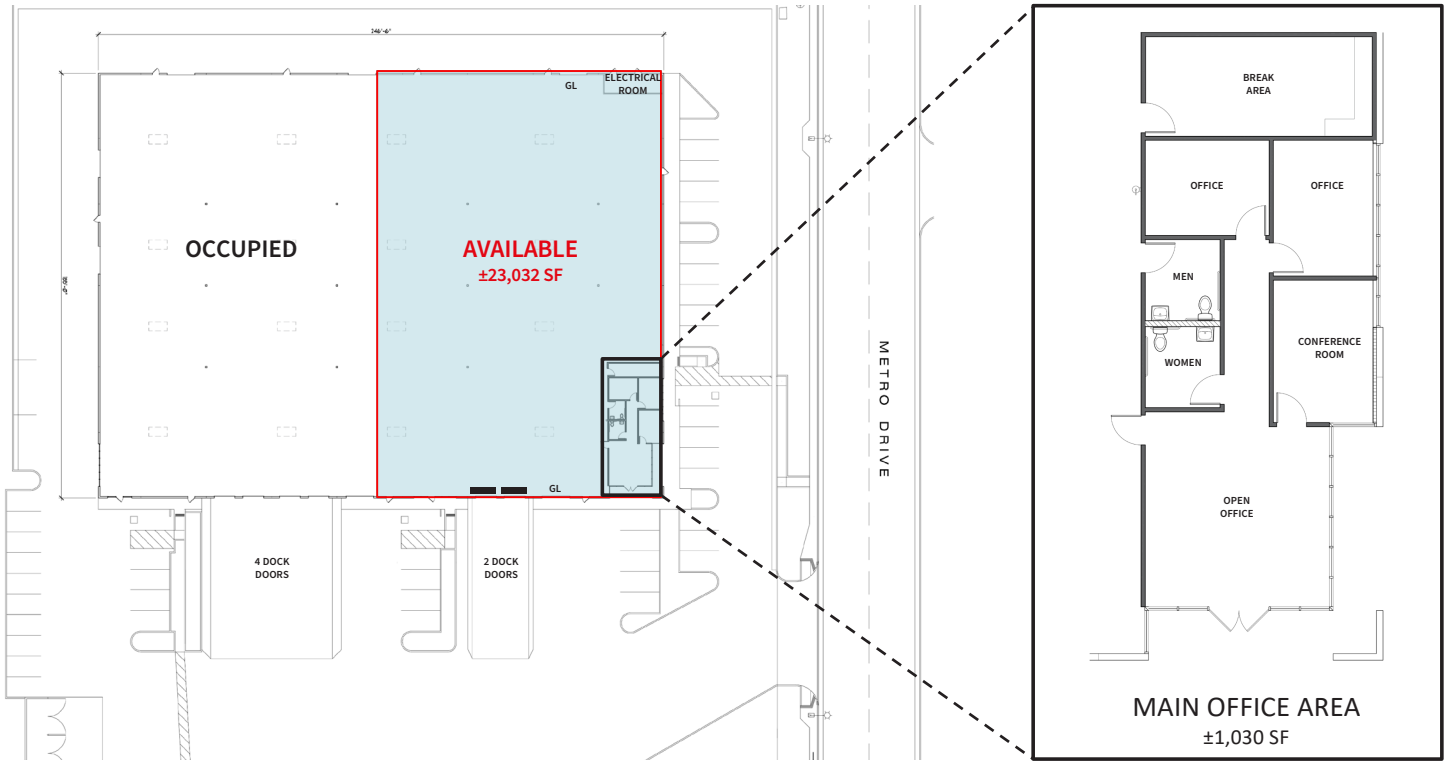

Tim Mustin
Managing Director
tim.mustin@jll.com
+1 209 390 1687
License #01857876

Michael Matter
Vice President
michael.matter@jll.com
+1 209 390 1702
License #01435801

John Fondale, SIOR
Managing Director
john.fondale@jll.com
+1 209 390 1694
License #01017415

Michael Sharapata
Senior Managing Director
michael.sharapata@jll.com
+1 509 822 0088
License #01737708

Although information has been obtained from sources deemed reliable, neither Owner nor JLL makes any guarantees, warranties or representations, express or implied, as to the completeness or accuracy as to the information contained herein. Any projections, opinions, assumptions or estimates used are for example only. There may be differences between projected and actual results, and those differences may be material. The Property may be withdrawn without notice. Neither Owner nor JLL accepts any liability for any loss or damage suffered by any party resulting from reliance on this information. If the recipient of this information has signed a confidentiality agreement regarding this matter, this information is subject to the terms of that agreement. ©2024. Jones Lang LaSalle IP, Inc. All rights reserved.