

For Lease

Retail Space: ±1,500 SF

AVAILABLE



For more information:

Edens Plaza

4105 West Beltline Blvd.

Columbia, South Carolina 29204

Patrick Palmer, CCIM

+1 803 556 3340

ppalmer@naicolumbia.com

Bobby Baboni, CCIM

+1 803 744 9846

bbalboni@naicolumbia.com

Edens Plaza



Interior Photo



Property Features

- Edens Plaza Shopping Center is the dominant shopping center within its retail corridor with tenant mix consisting of Roses Discount Store, Hibbett, Citi Trends, City Gear, US Wings & Deli, and Cricket Wireless.
- In addition to the impressive tenant roster within Edens Plaza, other surrounding retailers in the trade corridor include McDonald's, Dollar Tree, Jackson Hewitt, Family Dollar, Advance Auto Parts, Burger King, and Murphy USA.
- The center is strategically located at the high-traffic intersection of Two Notch Rd (18,600 VPD) and W. Beltline Blvd (22,200 VPD).
- The center is benefitted by great visibility with pylon signage available to tenants.
- Edens Plaza is centrally located in a densely populated area that includes 165,153 people in 5-mile radius.
- There are five access points off W. Beltline Blvd, including a fully signalized main entrance.
- Outparcel building available for potential purchase or lease.
- Abundant parking – approximately 3.75 per 1,000 SF
- Suite 55 Available: $\pm 1,500$ SF.
 - Lease Rate: \$12.00 PSF, per year, NNN.

THE INFORMATION CONTAINED HEREIN HAS BEEN GIVEN TO US BY THE OWNER OF THE PROPERTY OR OTHER SOURCES WE DEEM RELIABLE. WE HAVE NO REASON TO DOUBT ITS ACCURACY, BUT WE DO NOT GUARANTEE IT. ALL INFORMATION SHOULD BE VERIFIED PRIOR TO PURCHASE OR LEASE.

NAIColumbia

807 Gervais Street, Suite 200
Columbia, South Carolina 29201
+1 803.254.0100
www.naicolumbia.com

Site Plan

Suite	Tenant	GLA
10	Future Redevelopment	4000
20	Roses Discount Stores	35625
30	Hibbett & City Gear Combo Store	9600
40	Impac Mortgage	1920
50	US Wings & Deli	3000
55	AVAILABLE	1500
60	Your Professional Image	7500
70	Tobacco Shop	3800
80	Beauty Max	5685
90	Cricket Wireless	2500
110	Citi Trends	22090
130	Brite Touch	2588

99808

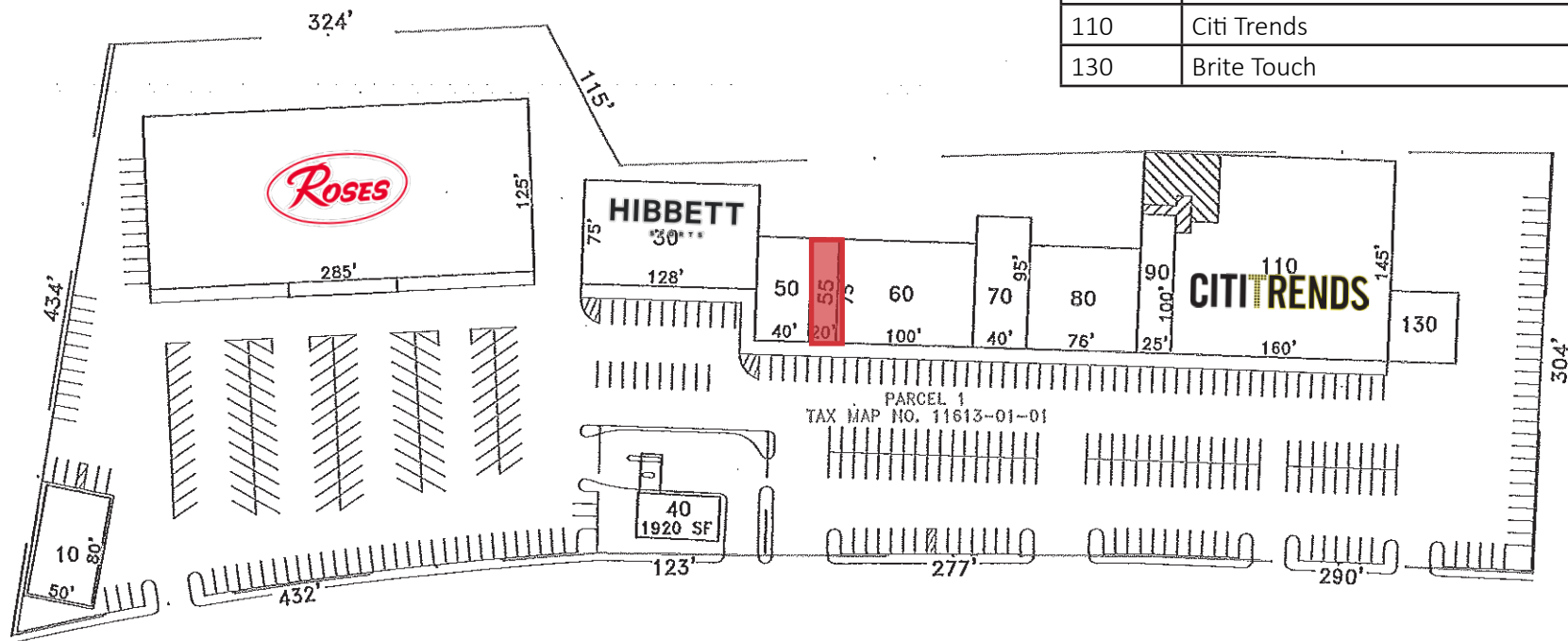

THE INFORMATION CONTAINED HEREIN HAS BEEN GIVEN TO US BY THE OWNER OF THE PROPERTY OR OTHER SOURCES WE DEEM RELIABLE. WE HAVE NO REASON TO DOUBT ITS ACCURACY, BUT WE DO NOT GUARANTEE IT. ALL INFORMATION SHOULD BE VERIFIED PRIOR TO PURCHASE OR LEASE.

NAIColumbia

807 Gervais Street, Suite 200
Columbia, South Carolina 29201
+1 803.254.0100
www.naicolumbia.com

Edens Plaza

For Lease

Retail Space: ±1,500 SF



THE INFORMATION CONTAINED HEREIN HAS BEEN GIVEN TO US BY THE OWNER OF THE PROPERTY OR OTHER SOURCES WE DEEM RELIABLE. WE HAVE NO REASON TO DOUBT ITS ACCURACY, BUT WE DO NOT GUARANTEE IT. ALL INFORMATION SHOULD BE VERIFIED PRIOR TO PURCHASE OR LEASE.

NAI Columbia

807 Gervais Street, Suite 200
Columbia, South Carolina 29201
+1 803.254.0100
www.naicolumbia.com

NAI Columbia

Demographic Profile

Demographic Profile

Two Notch Rd & N Beltline Blvd | Columbia, SC

	1 Mile	3 Miles	5 Miles		1 Mile	3 Miles	5 Miles		1 Mile	3 Miles	5 Miles
Population				2023 Age Dist.				Median Household Income			
2020 Census	8,636	71,393	166,545	0 - 4	8.2%	5.3%	4.9%	2023 Estimate	\$36,739	\$46,025	\$46,844
2023 Estimate	8,744	73,747	170,865	5 - 9	6.4%	5.0%	4.6%	2028 Projection	\$40,275	\$51,846	\$52,196
2028 Projection	8,779	75,377	174,123	10 - 14	6.2%	5.1%	4.6%				
% Chg. 2022-2027	0.4%	2.2%	1.9%	15 - 19	5.9%	7.7%	8.8%	Average Household Income			
				20 - 24	7.0%	9.4%	14.9%	2023 Estimate	\$56,689	\$81,589	\$77,147
Households				25 - 34	12.0%	13.3%	15.8%	2028 Projection	\$65,192	\$92,206	\$86,706
2020 Census	3,687	31,301	69,685	35 - 44	12.0%	11.5%	11.2%				
2023 Estimate	3,763	32,683	72,457	45 - 54	9.5%	10.1%	9.0%	Per Capita Household Income			
2028 Projection	3,832	33,845	74,808	55 - 64	12.4%	12.6%	10.4%	2023 Estimate	\$25,140	\$36,864	\$33,969
				65 - 74	11.0%	11.2%	8.8%	2028 Projection	\$29,303	\$42,108	\$38,483
Families				75 - 84	6.2%	6.0%	4.7%				
2010 Census	2,134	16,194	32,819	85+	3.1%	2.8%	2.1%	2023 Household Income Dist.			
2023 Estimate	2,090	16,053	33,344					Less than \$15,000	26.0%	21.1%	19.1%
2028 Projection	2,118	16,479	34,102	Median Age				\$15,000 - \$24,999	12.0%	10.4%	9.8%
				2010 Census	34.7	36.0	29.7	\$25,000 - \$34,999	9.8%	8.8%	9.6%
2023 Housing Data				2023 Estimate	38.5	38.5	32.5	\$35,000 - \$49,999	14.0%	12.3%	13.9%
Owner Occ. Housing Units	1,778	17,442	32,944	2028 Projection	40.2	39.4	33.0	\$50,000 - \$74,999	15.4%	15.3%	16.2%
Renter Occ. Housing Units	1,944	15,241	39,513					\$75,000 - \$99,999	10.4%	8.8%	9.6%
				Average Household Size				\$100,000 - \$149,999	7.9%	10.9%	11.2%
2023 Business Data				2020 Census	2.28	2.13	2.10	\$150,000 - \$199,999	1.5%	4.8%	4.6%
Total Businesses:	252	4,922	8,332	2023 Estimate	2.26	2.11	2.08	\$200,000 and Up	2.9%	7.6%	6.0%
Total Employees:	2,928	73,400	126,003	2028 Projection	2.23	2.08	2.06				