

367 CENTRAL AVENUE

BETWEEN CHARLES & BOWERS STREETS | JERSEY CITY, NJ

SIGNAGE

MediCenter
WALK IN

367 CENTRAL AVENUE

BETWEEN CHARLES & BOWERS STREETS | JERSEY CITY, NJ

PROPERTY HIGHLIGHTS

- Currently Rainbow
- In the heart of one of Jersey City's fastest growing markets, "Jersey City Heights"
- High foot traffic area
- Surrounded by new residential developments
- Neighbors include:
AT&T, H & R Block, Blimpie, Burger King, Chase, USPS, Valley National Bank, Walgreens, Papa John's, and many more!!

SIZE: 4,250 SF Ground Floor
3,250 SF Selling Lower Level

FRONTAGE: 38'

POSSESSION: Arranged

ASKING RENT: Upon Request

Floor Plan:
Ground Floor

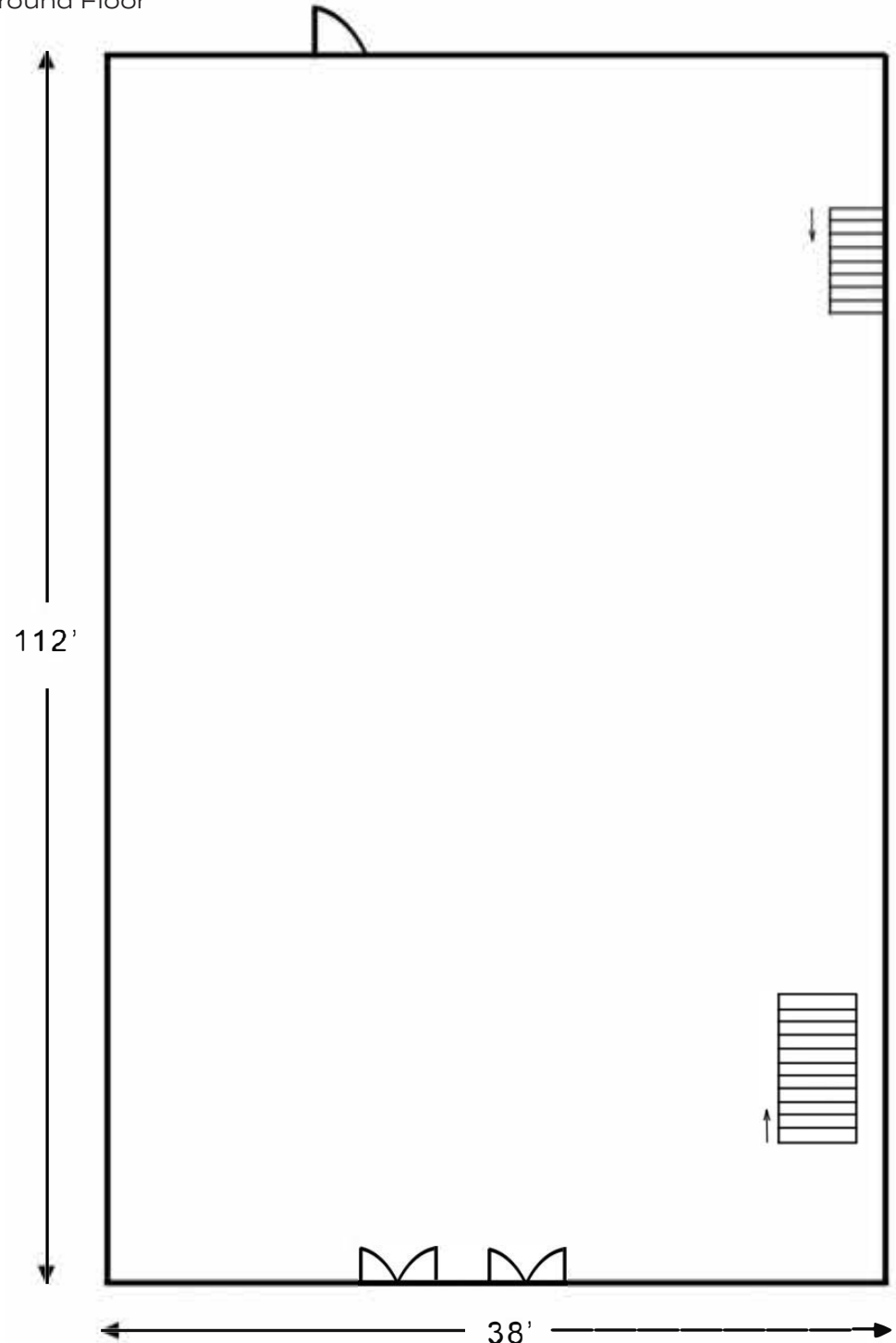

367 CENTRAL AVENUE

BETWEEN CHARLES & BOWERS STREETS | JERSEY CITY, NJ

AREA MAP:

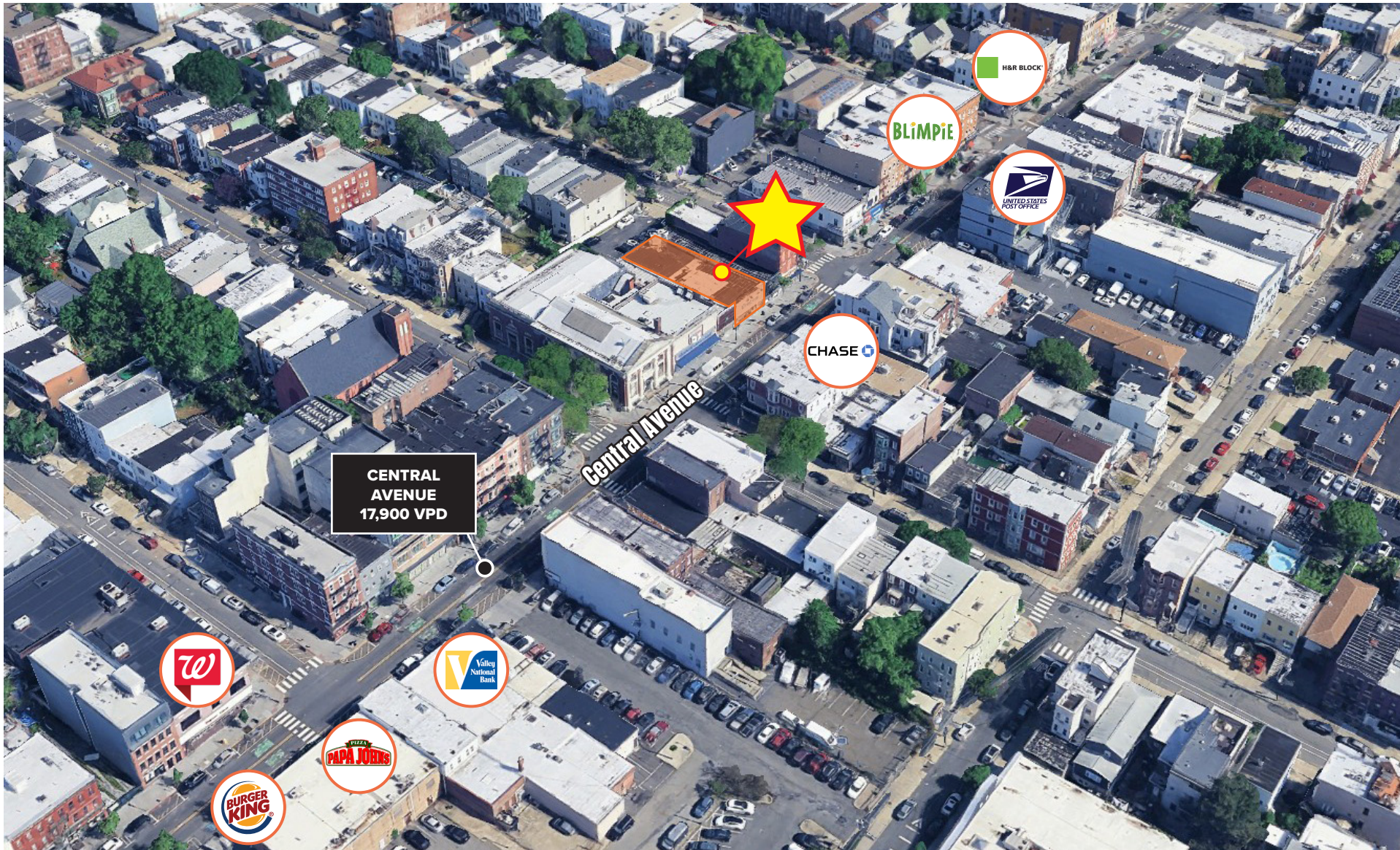

All information supplied in this marketing presentation and/or flyer is from sources deemed reliable and is furnished subject to errors, omissions, modifications, removal of listings from sale/lease and to any listing condition. Any square footage, dimensions, floor plans and/or technical data set forth are approximations and are subject to further elaboration/confirmation.

367 CENTRAL AVENUE

BETWEEN CHARLES & BOWERS STREETS | JERSEY CITY, NJ

FOR MORE INFORMATION,
PLEASE CONTACT:

ELLIOT STEIN

917.993.1442 | EStein@ksrny.com

BARRY FISHBACH

917.273.6752 | Fishbach@ksrny.com

