

FOR LEASE - 11,250 SF

6200 Tri County Parkway | Schertz, Texas 78154



PROPERTY FEATURES

- 2 Grade Level Doors
- 24' Clear Height
- 90' Deep Truck Court
- ESFR Sprinkler System
- Small Yard

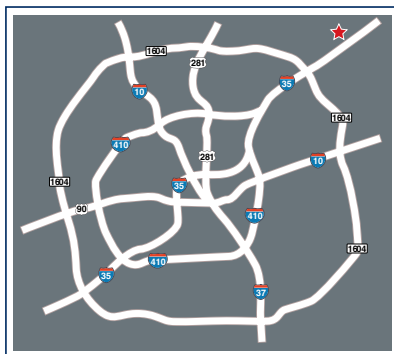

For Lease Information:

PRUITT REALTY

Commercial Real Estate Services

4830 N. Loop 1604 W • San Antonio, TX 78249

cell **210.410.8000**

office **210.349.8000**

6200 TRI COUNTY PARKWAY SCHERTZ, TEXAS 78154

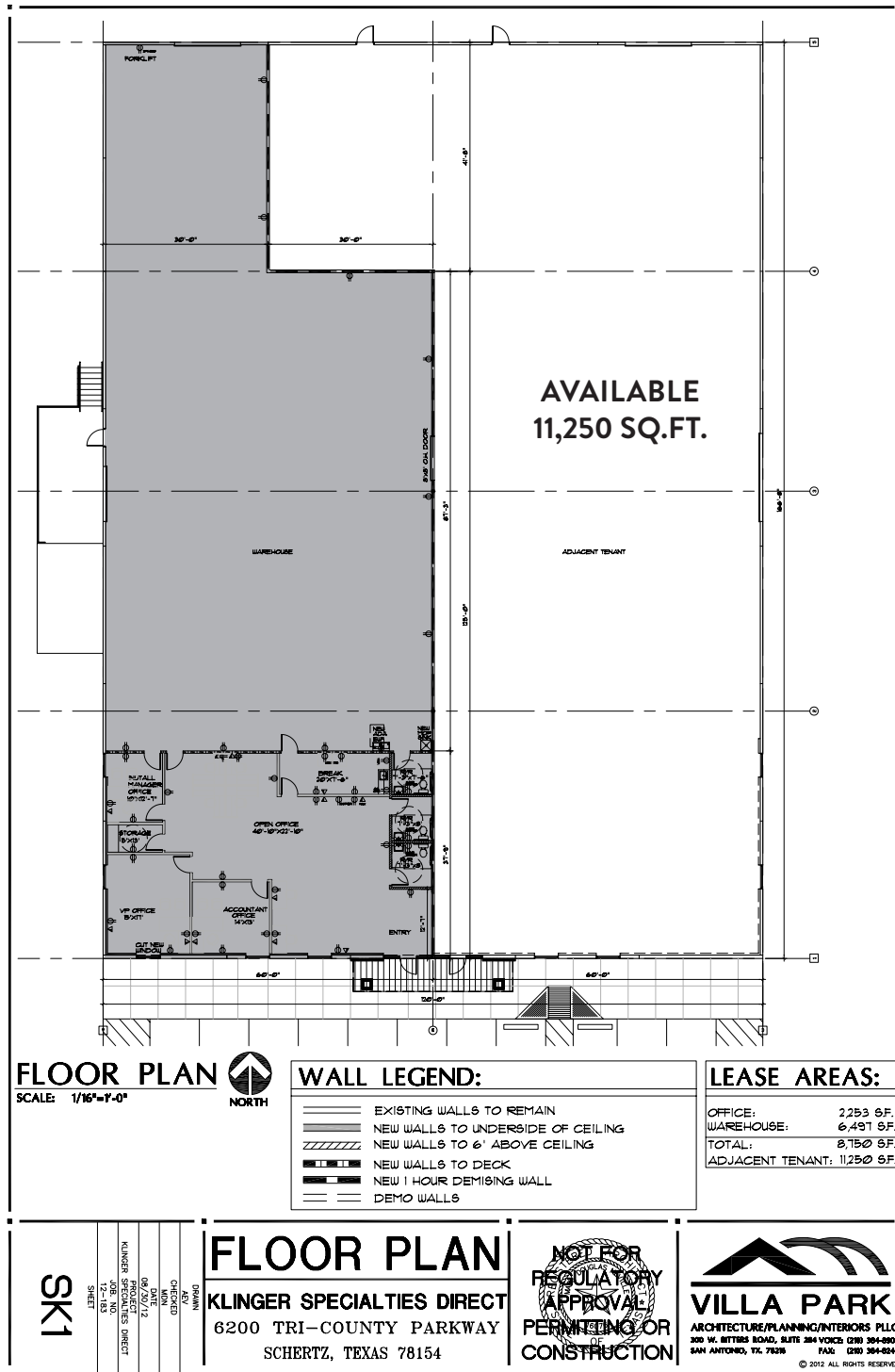

MARKETING BY:

PRUITT REALTY
COMMERCIAL REAL ESTATE SERVICES

4830 NORTH LOOP 1604 W. • SAN ANTONIO, TEXAS 78249

CONTACT: **HANK PRUITT, SIOR, CCIM**

CELL: **210.410.8000**

OFFICE: **210.349.8000**

The information contained herein was obtained from sources believed reliable; however, Pruitt Realty, Inc. makes no guarantees, warranties or representation as to the completeness or accuracy thereof. The presentation of this property is submitted subject to errors, omissions, change of prices or conditions prior to sale or lease or withdrawal without notice.

HANK@PRUITTREALTY.COM