



# 2880

SUNRISE BLVD.  
RANCHO CORDOVA

±1,263 SF - ±27,082 SF PROFESSIONAL OFFICE SPACE AVAILABLE

## SUNRISE CORPORATE CENTER

**NEWMARK**

**LUCAS LUGO** 916-569-2322 [lucas.lugo@nmrk.com](mailto:lucas.lugo@nmrk.com) CA RE License #01916673  
**JASON BRINITZER** 916-569-2341 [jason.brinitzer@nmrk.com](mailto:jason.brinitzer@nmrk.com) CA RE License #02114854



## PROJECT HIGHLIGHTS

- Suites available for immediate occupancy
- Building signage is available
- Easy freeway access
- Very near light rail station
- Two-story corporate office building in the heart of Rancho Cordova
- 4/1,000 SF parking ratio
- Extensive landscaping with water features
- On-site fitness center & conference room

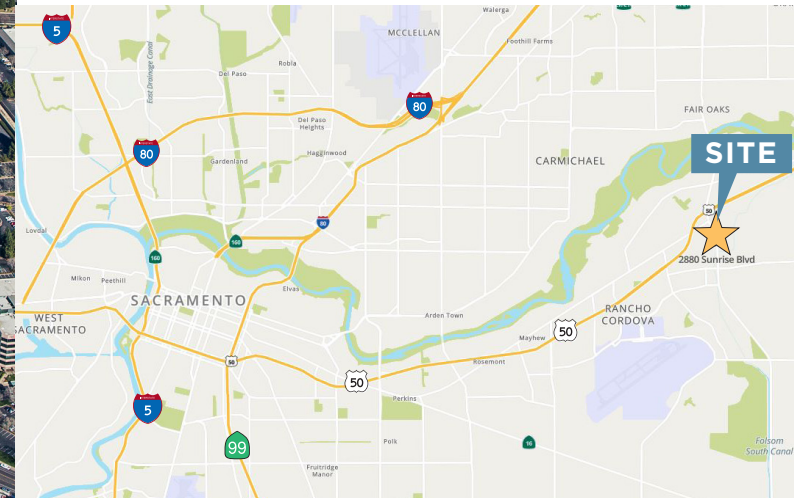

**2880** SUNRISE BLVD.  
RANCHO CORDOVA

**LUCAS LUGO** 916-569-2322 [lucas.lugo@nmrk.com](mailto:lucas.lugo@nmrk.com) CA RE License #01916673  
**JASON BRINITZER** 916-569-2341 [jason.brinitzer@nmrk.com](mailto:jason.brinitzer@nmrk.com) CA RE License #02114854

# FLOOR PLAN

## FIRST FLOOR

- Suite 100 ±3,350 RSF
- Suite 102 ±1,705 RSF
- Suite 118 ±1,779 RSF
- Suite 136 ±2,136 RSF
- Suite 137 ±1,263 RSF
- Suite 138 ±4,049 RSF
- Suite 139 ±1,383 RSF

**SUITES 137, 139 CAN BE COMBINED FOR A TOTAL OF ±2,646 RSF**

**SUITES 100, 102 & 118 CAN BE COMBINED FOR A TOTAL OF ±6,834 RSF**

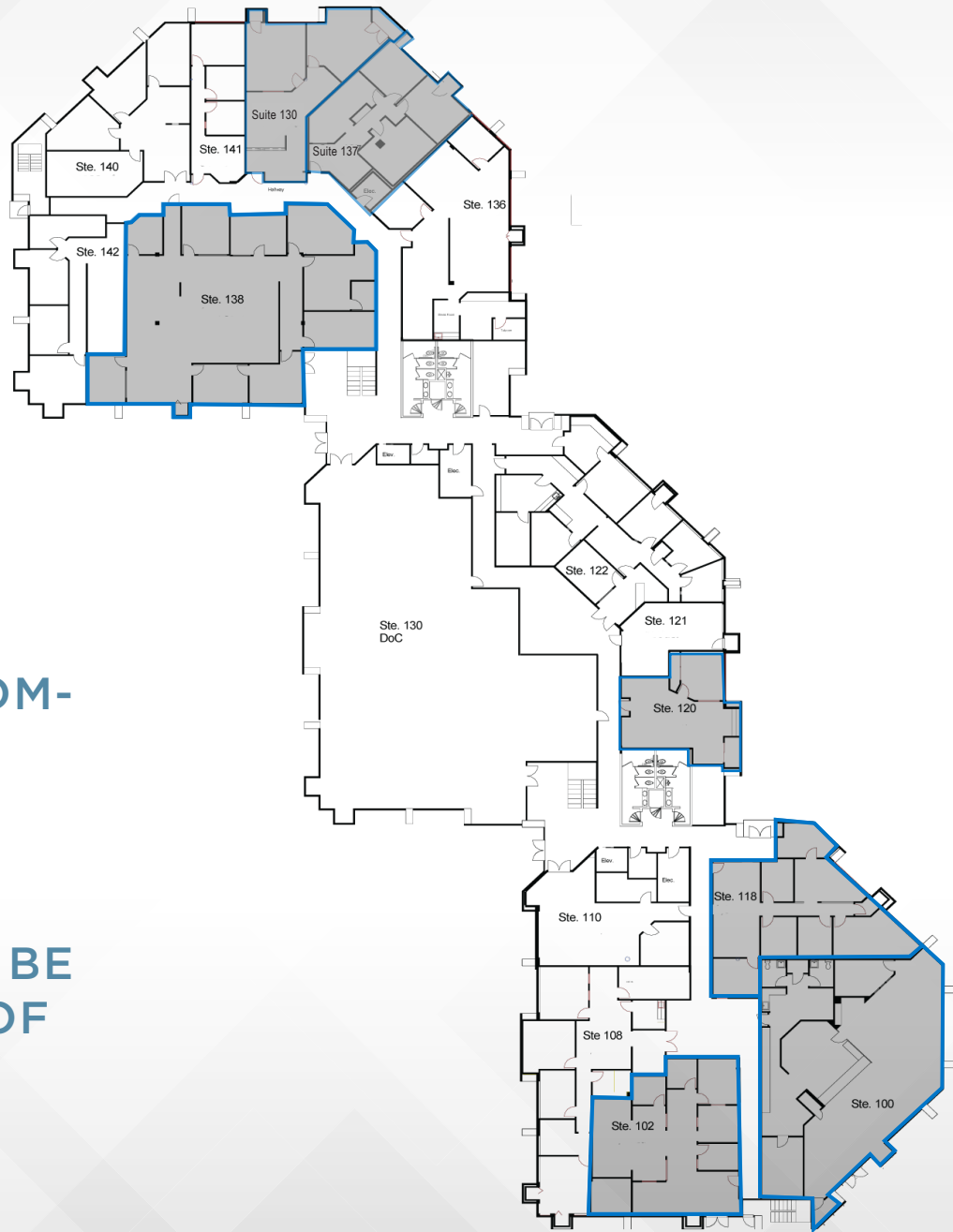

# FLOOR PLAN SECOND FLOOR

- Suite 200 ±1,784 RSF
- Suite 202 ±4,325 RSF
- Suite 214 ±2,654 RSF
- Suite 218 ±3,472 RSF

**SUITES 200 & 202 CAN BE  
COMBINED FOR A TOTAL OF  
±6,109 RSF**

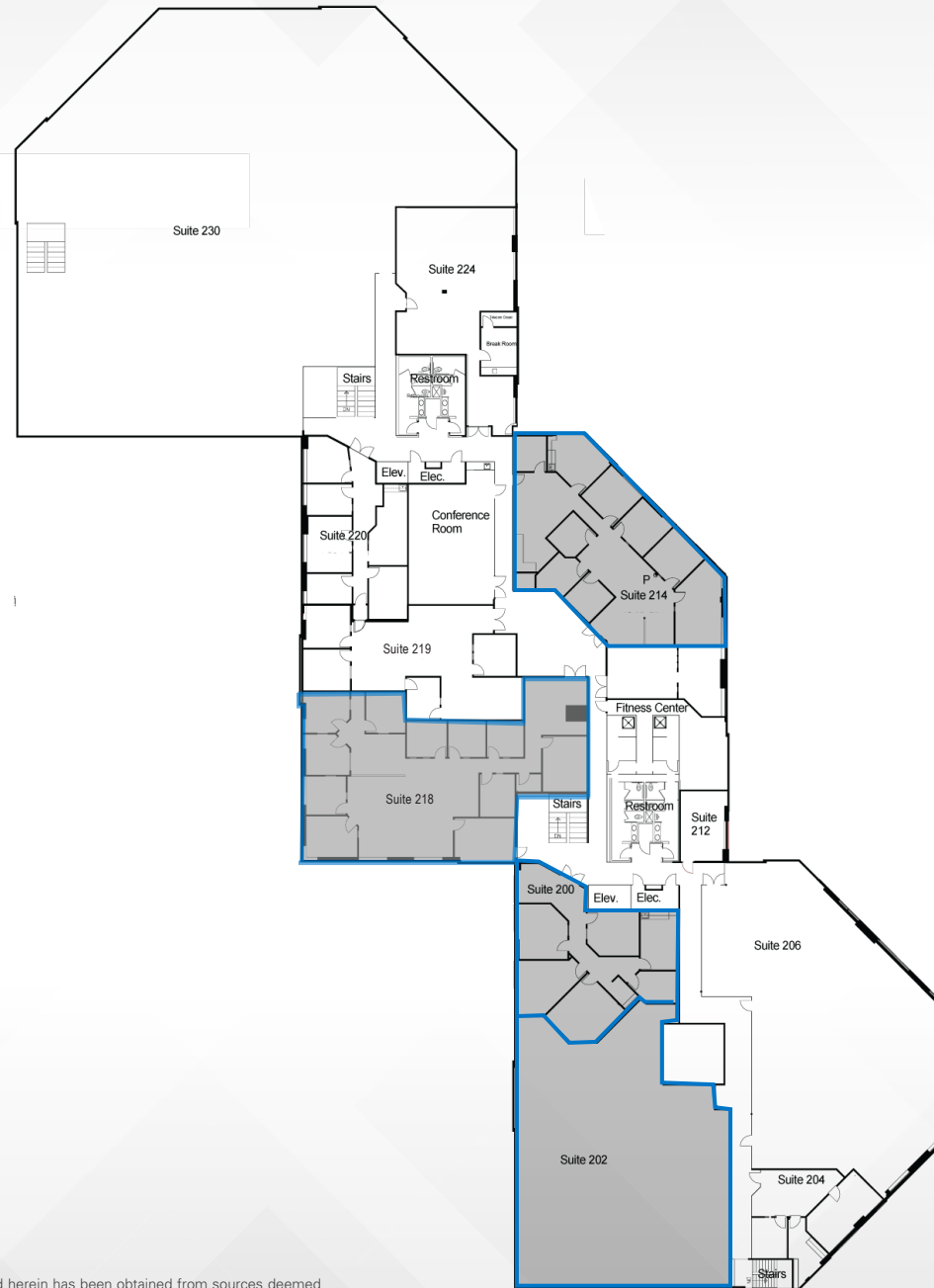

The distributor of this communication is performing acts for which a real estate license is required. The information contained herein has been obtained from sources deemed reliable but has not been verified and no guarantee, warranty or representation, either express or implied, is made with respect to such information. Terms of sale or lease and availability are subject to change or withdrawal without notice. 14-0310 • 6/25