

**Interstate 5
Commercial Buildings
66th Avenue West
Neighboring Commercial Building**



2DFLOORPLANS.COM

371 NW Gilman Blvd.
Suite 140
Issaquah, WA 98027
425-677-7511

This drawing is an instrument of service and is the sole property of the client listed. Any alteration of this drawing without removal of references to 2-D As-Built Floor Plans, Inc. is prohibited.

Drawing scale and dimensions are provided for reference only. Refer to CAD files for exact measurements.

©2010 2-D As-Built Floor Plans, Inc. All Rights Reserved.

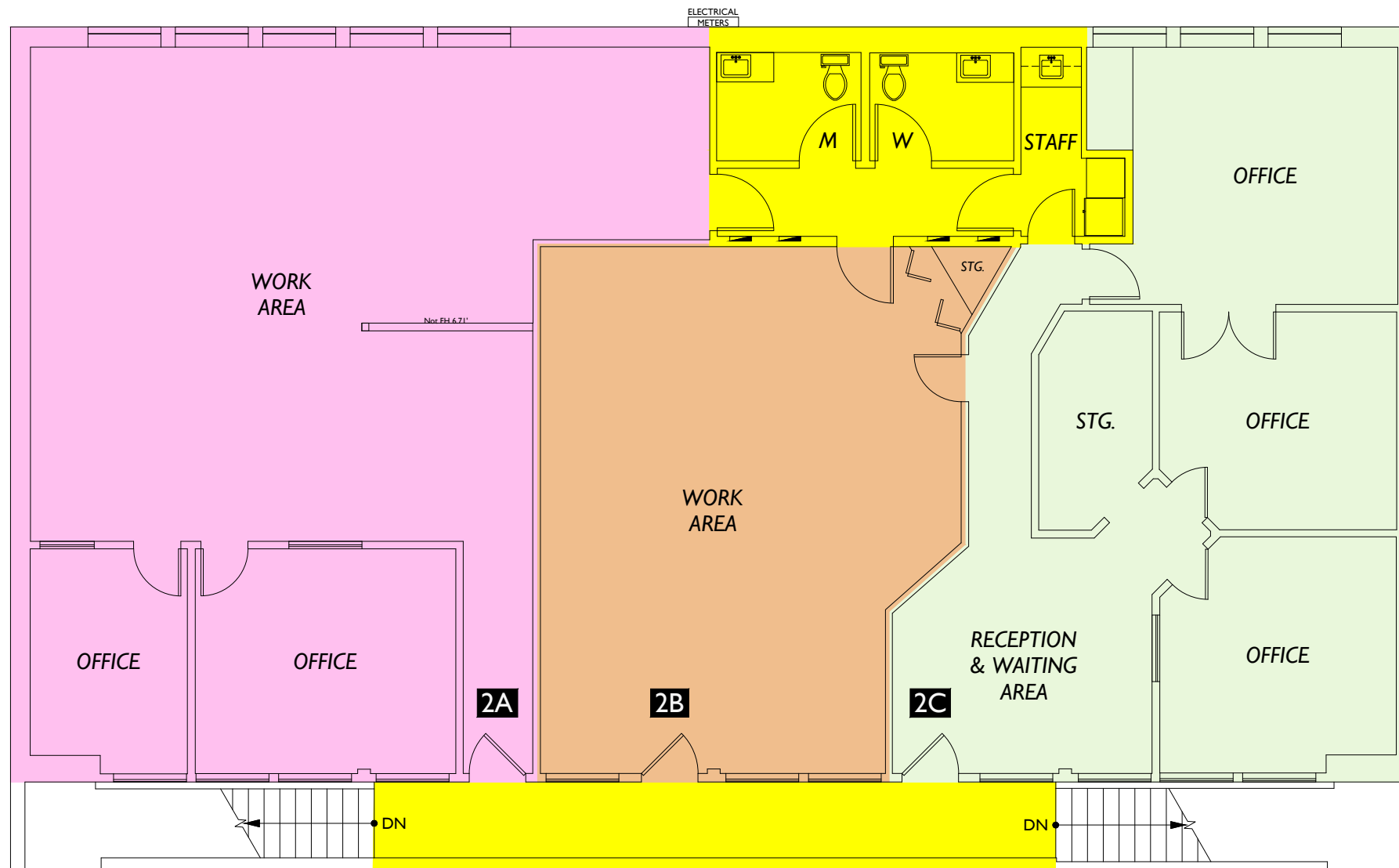

212th Street Southwest
Neighboring Commercial Buildings

Neighboring Commercial Buildings
216th Street Southwest
Commercial Buildings
220th Street Southwest

Area Analysis performed in accordance with ANSI/BOMA Z65.2 - 2019 Standard.

Project: C24-877

Date	Action
10/22/2024	Initial Building Measure
C24-877	

Client:
HRK Investments, LLC

Site:
Industrial Building
21307 67th Avenue West
Lynnwood, WA 98118

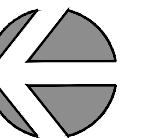

Lease Plan

2

Floor

Floor Summary	SQ. FT.
Total Rentable Area	3,167.57
Total Occupant Area	2,754.03
Load Factor	1.150158

Floor Service Area	413.54
Building Service Area	0
Total Vertical	0

Suite #	Occupant Area	Rentable Area
Suite 2A	1,229.74	1,414.40
Suite 2B	612.82	704.84
Suite 2C	911.47	1,048.33

**Parking Lot & Loading Area
67th Avenue West
Commercial Buildings
Pacific Highway WA-99**

