



RETAIL PROPERTY FOR SALE

212 S MAIN ST & 116 E CRONLY ST

LAURINBURG, NC 28352

212 South Main Street and 116 East Cronly Street is a ±6,264 SF, two-tenant retail/office building located at a signalized corner in Downtown Laurinburg. With excellent visibility and steady daytime traffic, the building is ideal for retail, service providers, and professional users.



Alyssa Stepusin Byrd

abyrd@lee-associates.com

O: 919.576.2512

C: 919.482.0660

DETAILS

| | |
|---------------|-------------|
| Property Type | Retail |
| Building Size | ±6,264 SF |
| Lot Size | 0.16 acres |
| Year Built | 1974 |
| GIS PIN | 01005106004 |
| Zoning | CB |
| Sale Price | Call Broker |

LEE & ASSOCIATES
COMMERCIAL REAL ESTATE SERVICES
RALEIGH • DURHAM • WILMINGTON

We obtained the information above from sources we believe to be reliable. However, we have not verified its accuracy and make no guarantee, warranty or representation about it. It is submitted subject to the possibility of errors, omissions, change of price, rental or other conditions, prior sale, lease or financing, or withdrawal without notice. We include projections, opinions, assumptions or estimates for example only, and they may not represent current or future performance of the property. You and your tax and legal advisors should conduct your own investigation of the property and transaction.

RETAIL FOR SALE
212 S MAIN ST & 116 E CRONLY ST

212 South Main Street, Laurinburg, NC 28352



COMMERCIAL REAL ESTATE SERVICES
RALEIGH • DURHAM • WILMINGTON

TOTAL SIZE
6,264 SF

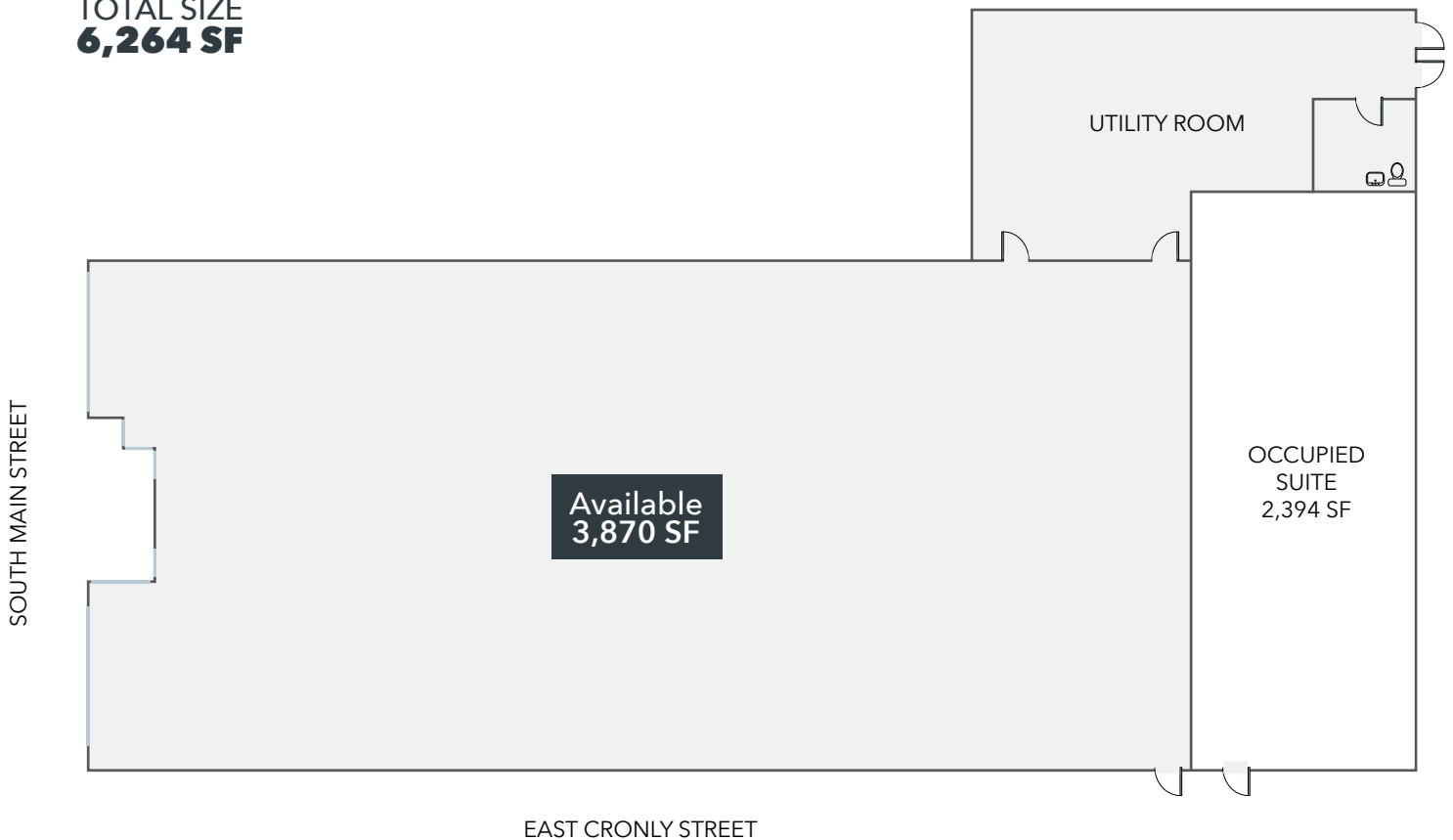

Alyssa Stepusin Byrd
abyrd@lee-associates.com
O: 919.576.2512
C: 919.482.0660

All information furnished regarding property for sale, rental or financing is from sources deemed reliable, but no warranty or representation is made to the accuracy thereof and same is submitted to errors, omissions, change of price, rental or other conditions prior to sale, lease or financing or withdrawal without notice.
No liability of any kind is to be imposed on the broker herein.

RETAIL FOR SALE

212 S MAIN ST & 116 E CRONLY ST

212 South Main Street, Laurinburg, NC 28352



COMMERCIAL REAL ESTATE SERVICES
RALEIGH • DURHAM • WILMINGTON



OVERVIEW

212 S Main Street and 116 E Cronly Street is a $\pm 6,264$ SF, two-tenant retail/office building located at a signalized corner in Downtown Laurinburg. With excellent visibility and steady daytime traffic, the building is ideal for retail, service providers, and professional users.

LOCATION

Located at the signalized intersection of South Main Street and Cronly Street, this property sits in the heart of Downtown Laurinburg, a designated Main Street America Affiliate community.

KEY DETAILS

- $\pm 6,264$ SF building for sale
- 2,394 SF is leased to a professional services office
- 3,870 SF retail/showroom with 12' ceiling heights
- Located in Laurinburg's Downtown Social District
- Prominent signalized corner location with excellent exposure
- Ample nearby public and street parking
- Walkable to restaurants, shops, and community amenities
- Call broker for pricing



Alyssa Stepusin Byrd
abyrd@lee-associates.com
O: 919.576.2512
C: 919.482.0660

All information furnished regarding property for sale, rental or financing is from sources deemed reliable, but no warranty or representation is made to the accuracy thereof and same is submitted to errors, omissions, change of price, rental or other conditions prior to sale, lease or financing or withdrawal without notice.
No liability of any kind is to be imposed on the broker herein.