

DRIVE-THRU PAD AVAILABLE FOR LEASE

10340-10368 CENTRAL AVE
MONTCLAIR, CA 91763



±13,730 SF/0.31 ACRES
GROUND LEASE OR
BUILD-TO-SUIT AVAILABLE



PROPERTY FEATURES

- Last Shop Space Available For Lease.
- High traffic counts of: ±61,000 CPD on Central Ave.
- Walking distance from Our Lady of Lourdes Church, Saratoga Park, and Kingsley Elementary.
- High street exposure.
- Ground lease or build-to-suit drive-thru available.
- Considerable population in immediate proximity.
- An abundance of schools within a one-mile radius.

3 MILE RADIUS DEMOS

206,590
POPULATION



\$103,329
AVERAGE
HOUSEHOLD
INCOME

DAYTIME
DEMOGRAPHICS

123,966

TRAFFIC COUNTS

At Central Ave & Holt Blvd: 63,637 CPD

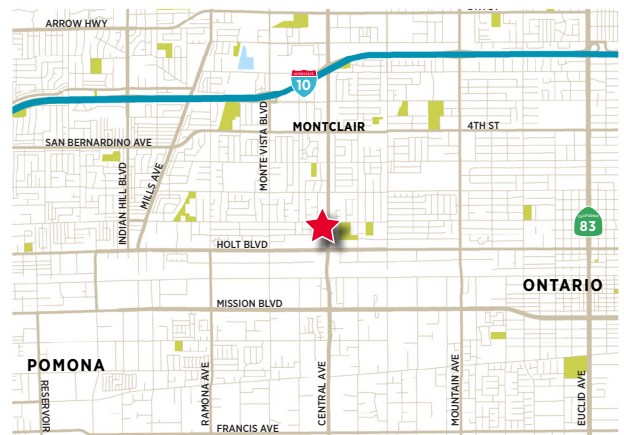

Daniel Watson
Associate
+1 951 395 0000
dwatson@catalystretail.com
Lic. #02165277

Chase Harvey
Partner
+1 909 406 4000
charvey@catalystretail.com
Lic. #01954291

Jay Nichols
Managing Partner
+1 909 406 4000
jnichols@catalystretail.com
Lic. #01905191

This information has been obtained from sources believed reliable. We have not verified it and make no guarantee, warranty or representation about it. Any projections, opinions, assumptions or estimates used are for example only and do not represent the current or future performance of the property. You and your property advisors should conduct a careful, independent investigation of the property to determine to your satisfaction the suitability of the property for your needs. Revised: October 29, 2025 9:55 AM

DRIVE-THRU PAD AVAILABLE FOR LEASE

10340-10368 CENTRAL AVE
MONTCLAIR, CA 91763



AVAILABILITIES

**DRIVE
THRU**

**±13,730 SF
±0.31 ACRES**

13,730 SF/0.31 ACRES
GROUND LEASE OR
BUILD-TO-SUIT AVAILABLE
*Please reach out to Brokers
for details*

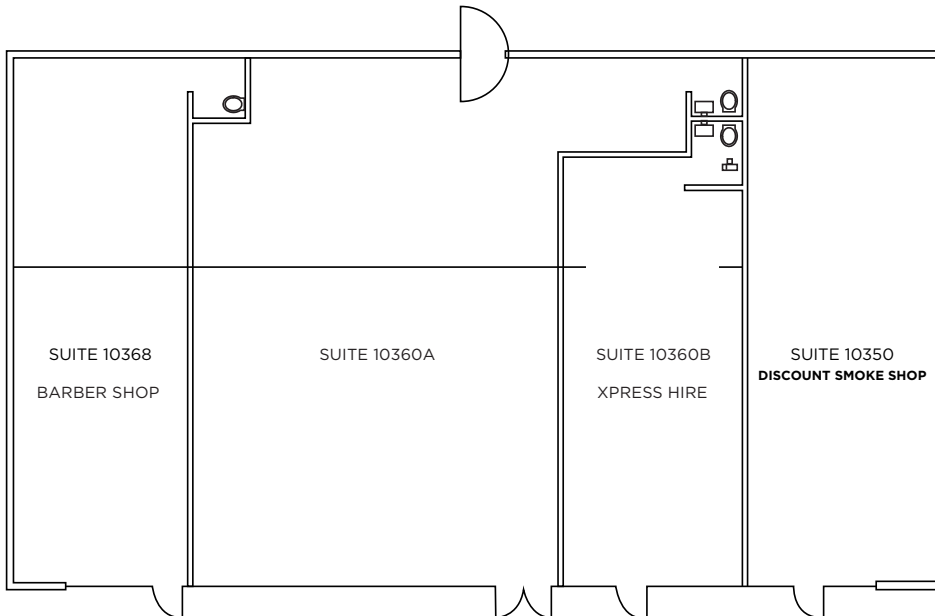
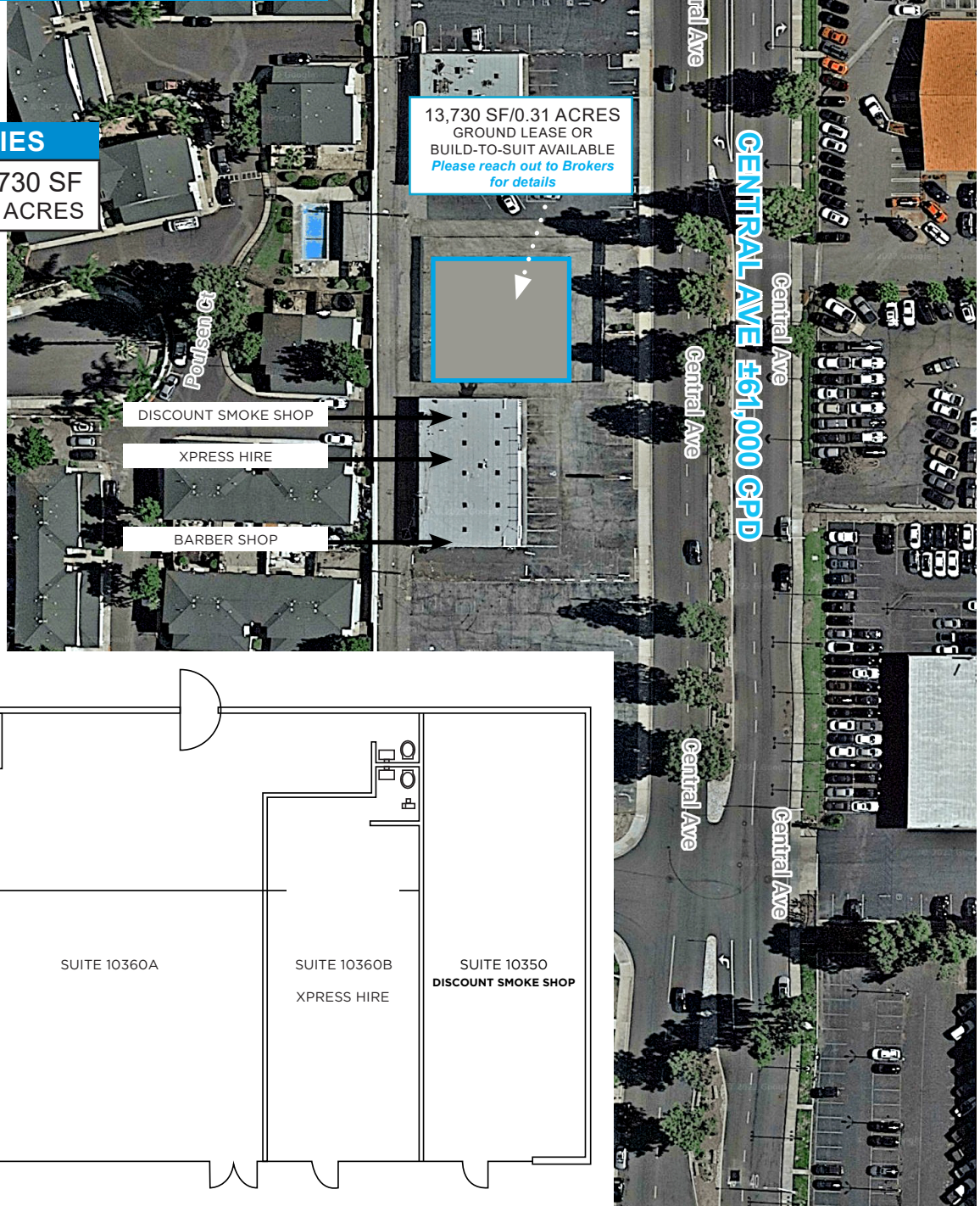

Daniel Watson
Associate
+1 951 395 0000
dwatson@catalystretail.com
Lic. #02165277

Chase Harvey
Partner
+1 909 406 4000
charvey@catalystretail.com
Lic. #01954291

Jay Nichols
Managing Partner
+1 909 406 4000
jnichols@catalystretail.com
Lic. #01905191

This information has been obtained from sources believed reliable. We have not verified it and make no guarantee, warranty or representation about it. Any projections, opinions, assumptions or estimates used are for example only and do not represent the current or future performance of the property. You and your property advisors should conduct a careful, independent investigation of the property to determine to your satisfaction the suitability of the property for your needs. Revised: October 29, 2025 9:55 AM

DRIVE-THRU PAD AVAILABLE FOR LEASE

10340-10368 CENTRAL AVE
MONTCLAIR, CA 91763



Daniel Watson
Associate
+1 951 395 0000
dwatson@catalystretail.com
Lic. #02165277

Chase Harvey
Partner
+1 909 406 4000
charvey@catalystretail.com
Lic. #01954291

Jay Nichols
Managing Partner
+1 909 406 4000
jnichols@catalystretail.com
Lic. #01905191

This information has been obtained from sources believed reliable. We have not verified it and make no guarantee, warranty or representation about it. Any projections, opinions, assumptions or estimates used are for example only and do not represent the current or future performance of the property. You and your property advisors should conduct a careful, independent investigation of the property to determine to your satisfaction the suitability of the property for your needs. Revised: October 29, 2025 9:55 AM

DRIVE-THRU PAD AVAILABLE FOR LEASE

10340-10368 CENTRAL AVE
MONTCLAIR, CA 91763

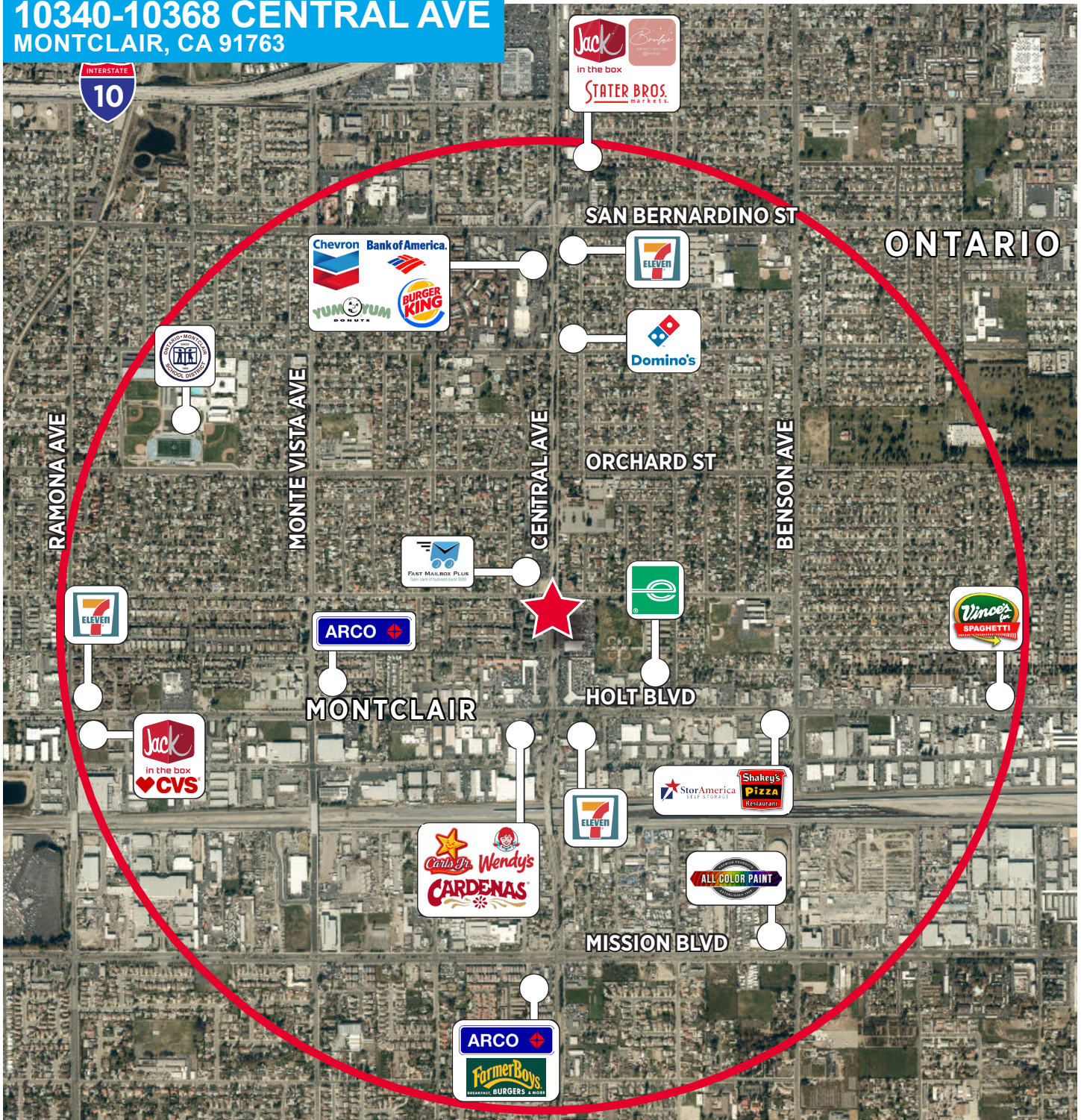

Daniel Watson
Associate
+1 951 395 0000
dwatson@catalystretail.com
Lic. #02165277

Chase Harvey
Partner
+1 909 406 4000
charvey@catalystretail.com
Lic. #01954291

Jay Nichols
Managing Partner
+1 909 406 4000
jnichols@catalystretail.com
Lic. #01905191

This information has been obtained from sources believed reliable. We have not verified it and make no guarantee, warranty or representation about it. Any projections, opinions, assumptions or estimates used are for example only and do not represent the current or future performance of the property. You and your property advisors should conduct a careful, independent investigation of the property to determine to your satisfaction the suitability of the property for your needs. Revised: October 29, 2025 9:55 AM