

FOR LEASE

RIVERSTONE MARKETPLACE | 3,363 SF

4101 SE 192nd Avenue | Vancouver, WA 98683



900 Washington St, Suite 850, Vancouver, WA
360.597.0574 | www.fg-cre.com



◆ Top-Tier Space in a Grocery-Anchored Plaza:

Situated in Camas' dynamic SE 192nd Avenue corridor, this property offers exceptional visibility as a prominent outparcel to the well-established Riverstone Marketplace. It is surrounded by high-traffic anchors such as QFC, Starbucks, and Roots Restaurant + Bar, creating a strong draw for daily consumer activity. The space is an excellent fit for retail, medical, office, or wellness-based businesses, with no exclusivity restrictions, allowing maximum flexibility for a wide range of uses.

◆ Interior Layout:

- Approx. 3,363 SF of well-appointed space
- Bright, welcoming reception and waiting area
- 10 spacious private offices (current build-out)
- 3 dedicated restrooms
- Fenced outdoor area

◆ Property Features:

- 28 surface parking stalls + 2 ADA-compliant spaces
- High-visibility signage opportunities – front & rear
- Easy access for staff and customers

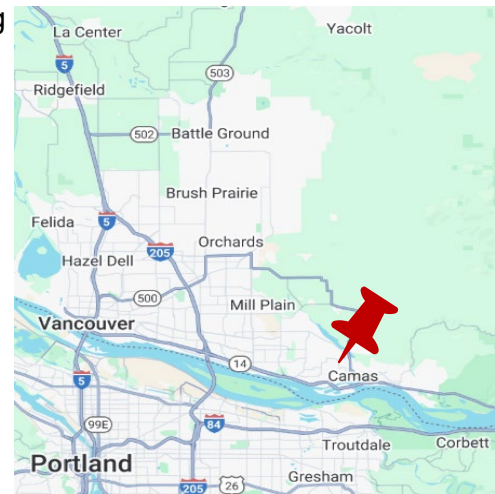

FOR MORE INFORMATION:

Scott Higgins

360.597.0577 | shiggins@fg-cre.com

KC Fuller

360.597.0569 | kfuller@fg-cre.com

FOR LEASE

RIVERSTONE MARKETPLACE | 3,363 SF

4101 SE 192nd Avenue | Vancouver, WA 98683



900 Washington St, Suite 850, Vancouver, WA
360.597.0574 | www.fg-cre.com

Option #1 (current build-out)

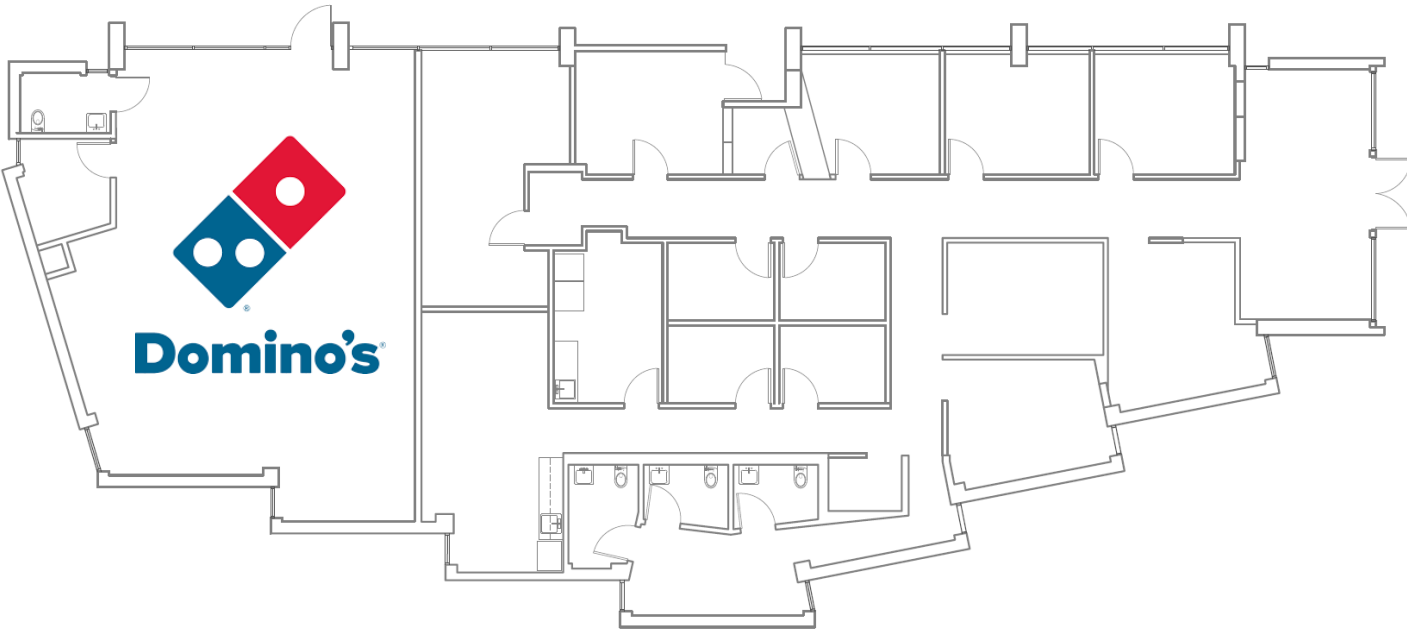

Option #2

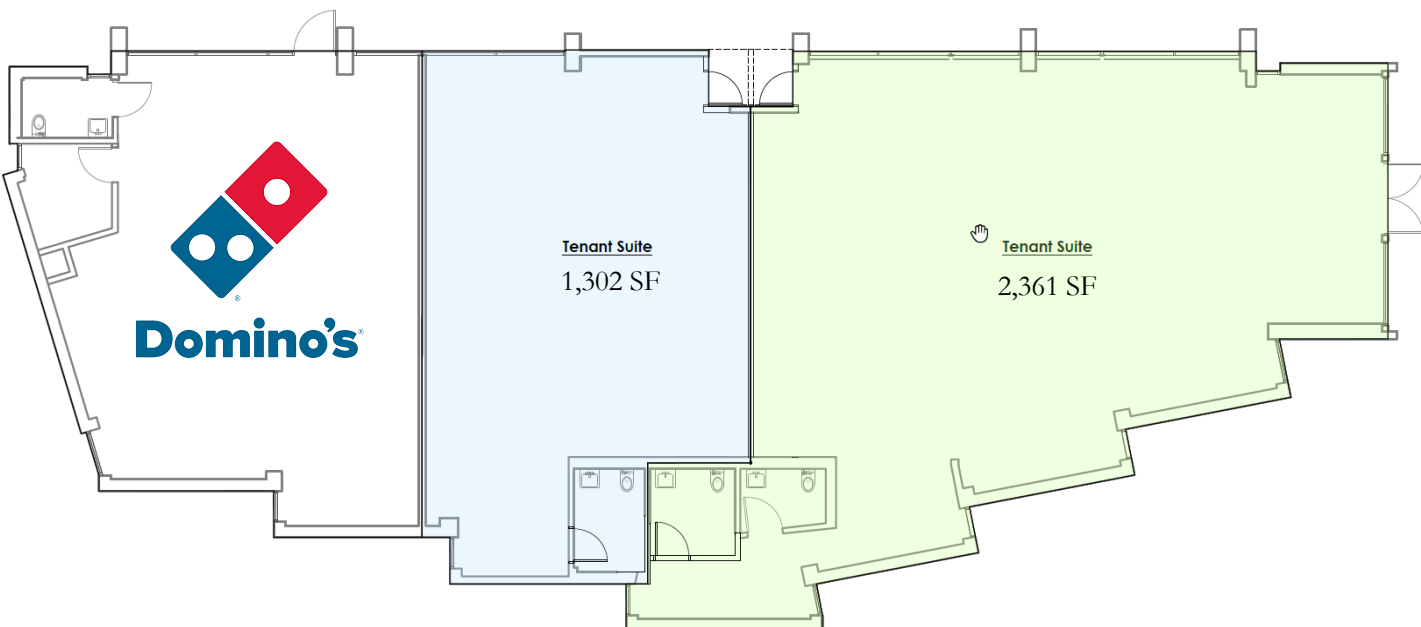

FOR LEASE

RIVERSTONE MARKETPLACE | 3,363 SF

4101 SE 192nd Avenue | Vancouver, WA 98683



900 Washington St, Suite 850, Vancouver, WA
360.597.0574 | www.fg-cre.com



Top 4 Traffic Volume Counts

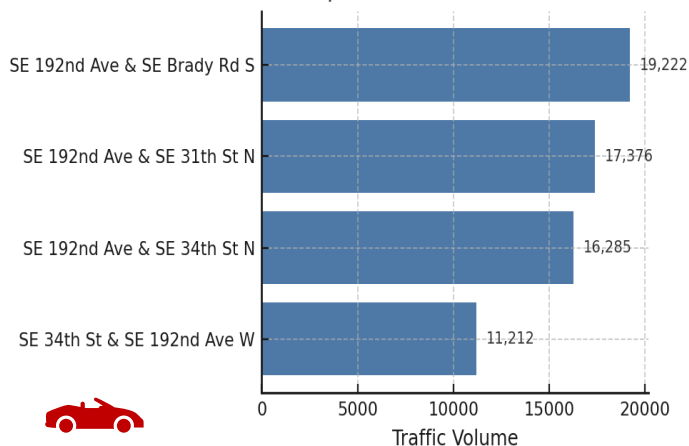

Employment & Business

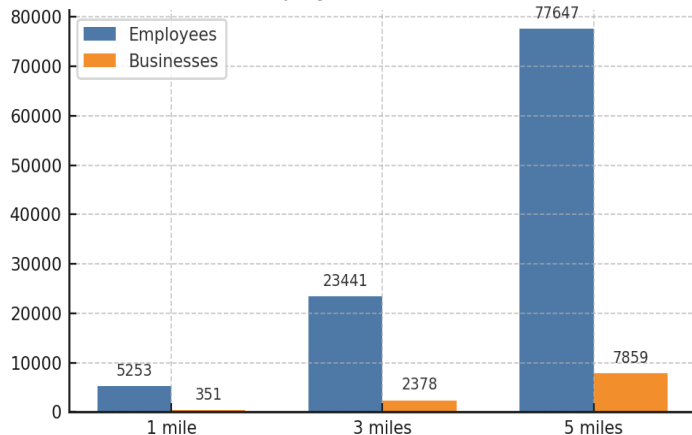

This statement with the information it contains is given with the understanding that all the negotiations relating to the purchase, rental or leasing of the property described above shall be conducted through this office. The above information, while not guaranteed, has been secured from sources we believe to be reliable.