



Shoreline Drive - Retail

4000 - 4016 Shoreline Drive
Sprink Park, MN 55384

For Lease



- Direct Lake Minnetonka Views
- Executive Office Suite (1st Floor)
- Natural Light
- Covered Parking
- Zoned Heating/Cooling
- Flexible Lease Terms
- Possible Dock Access
- Modified Gross Lease
 - \$20/PSF



www.copperwoodmn.com

684 Excelsior Blvd – Suite 210, Excelsior, MN 55331

Patrick Senescall
o. 952.392.1310 | c. 612.875.8104
patrick@copperwoodmn.com



A Division of Copperwood Investments, LLC



Shoreline Drive - Retail

4000 - 4016 Shoreline Drive
Spring Park, MN 55384

For Lease



Executive Office Availability

- 1,369 sf – Available Immediately
- 4 Private Offices
- Glass Front with Lake Views
- Common Area Restroom and Foyer (Yellow)
- Space Available – 30 Days Notice
- Monthly Modified Gross Rent \$2,300.00 per month
 - o Utilities in addition
- Tenants In the building include:*
 - Art Gallery
 - Home Décor
 - Restaurant
 - Your Name Here

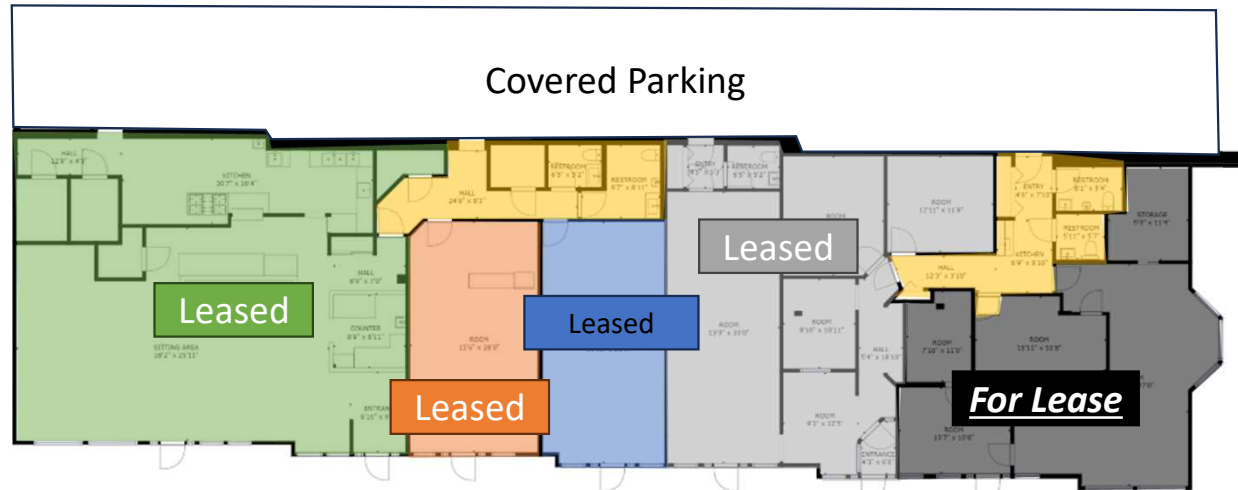

www.copperwoodmn.com

684 Excelsior Blvd – Suite 210, Excelsior, MN 55331

Patrick Senescall
o. 952.392.1310 | c. 612.875.8104
patrick@copperwoodmn.com



A Division of Copperwood Investments, LLC



Shoreline Drive - Retail

4000 - 4016 Shoreline Drive
Sprink Park, MN 55384

For Lease

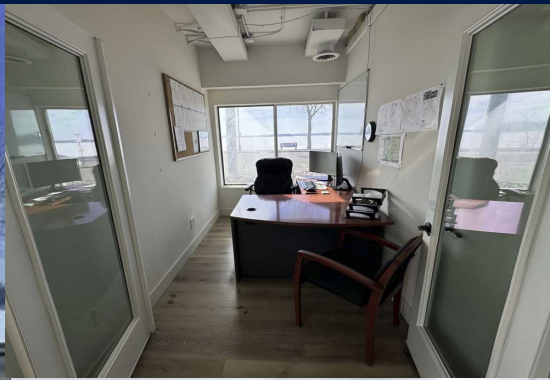

www.copperwoodmn.com

684 Excelsior Blvd – Suite 210, Excelsior, MN 55331

Patrick Senescall
o. 952.392.1310 | c. 612.875.8104
patrick@copperwoodmn.com



A Division of Copperwood Investments, LLC