

5501 Whitaker Avenue

Philadelphia, PA

50,000 - 304,000 SF available for sublease



Property specifications

- 50,000 - 304,000 SF available
- 17' - 24' clear height
- 34 (9' x 10') loading doors
- 1 drive-in door
- 1 loading platform
- Varying office sizes
- Shared parking
- 100% sprinklered
- Racking available upon request
- Sublease available through December 2031
- Significantly below market lease rate



Mitch Russell
+1 610 249 2274
mitch.russell@jll.com

Kyle Lockard
+1 610 249 2279
kyle.lockard@jll.com

Larry Maister
+1 610 249 2297
larry.maister@jll.com

Floor Plan

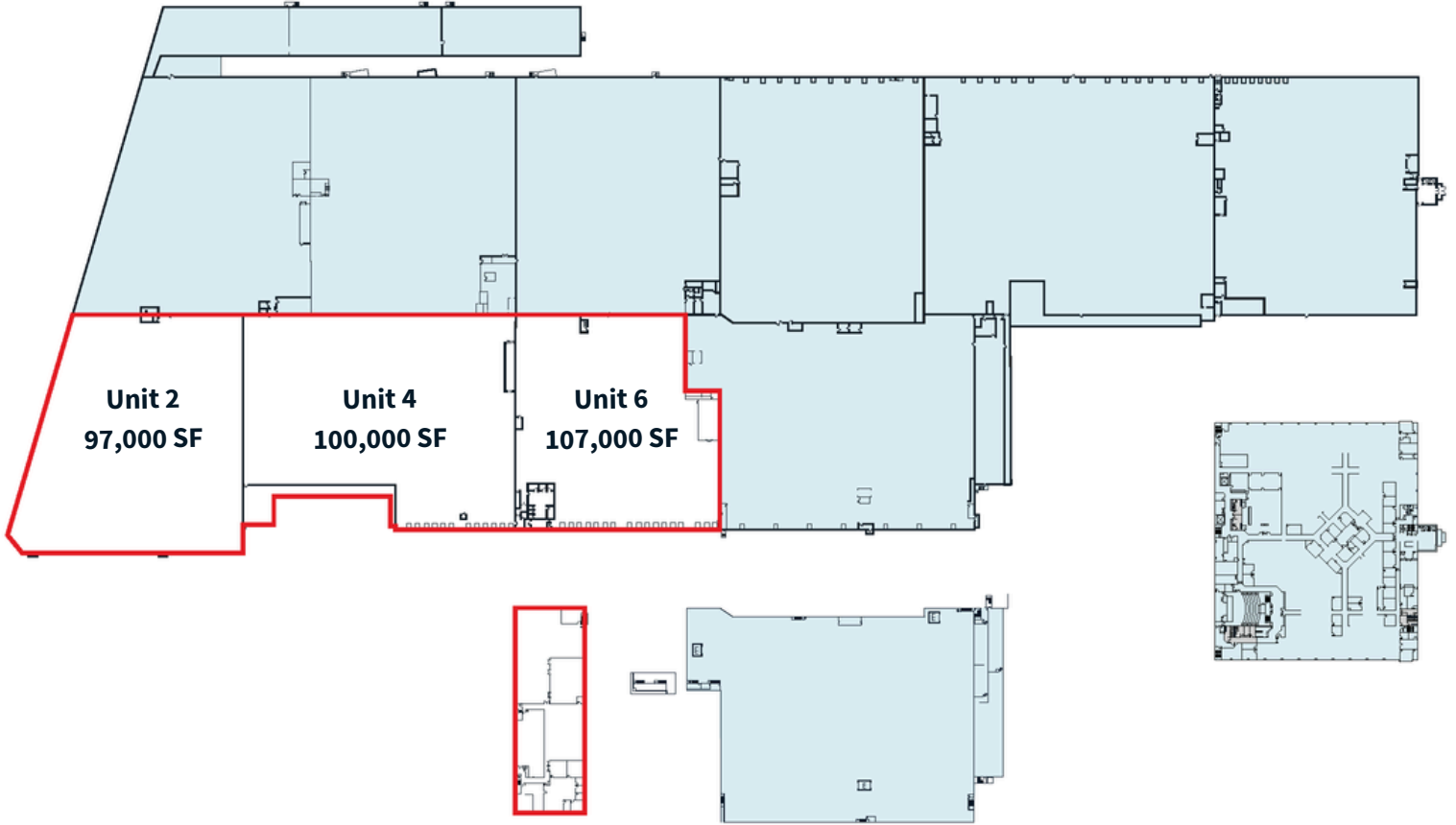

Mitch Russell
+1 610 249 2274
mitch.russell@jll.com

Kyle Lockard
+1 610 249 2279
kyle.lockard@jll.com

Larry Maister
+1 610 249 2297
larry.maister@jll.com