

# FOR LEASE

8 HOLLAND, IRVINE

±7,836 SF INDUSTRIAL SPACE



## PROPERTY FEATURES

- ±7,836 SF Industrial Space
- ±2,969 SF of Single-Story Office Space
- 400 Amps – 120/208v
- 17' Clear Height
- 1 GL Door (12' x 12')
- 20 Parking Spaces (2.55:1,000 SF)
- Excellent Irvine Spectrum Location
- Part of a Larger ±21,681 SF Building
- **Asking Rate: \$1.75/SF NNN + \$0.32/SF OPEX**

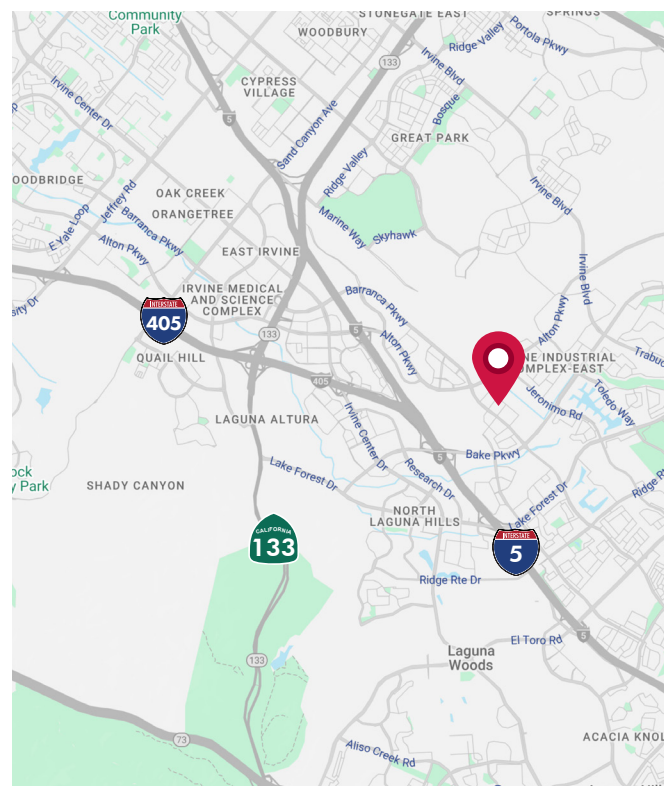

DALE CAMERA  
Senior Vice President  
License ID# 01313921  
949.790.3132  
dcamera@leeirvine.com

JASON HELMICK  
Senior Vice President  
License ID# 01786729  
949.790.3119  
jhelmick@leeirvine.com

ZACH SCHWANER  
Senior Vice President  
License ID# 02009623  
949.790.3159  
zschwanner@leeirvine.com

DYLAN DAVEY  
Associate  
License ID# 02219560  
949.790.3162  
ddavey@leeirvine.com

 **LEE & ASSOCIATES**  
COMMERCIAL REAL ESTATE SERVICES

**ORANGE COUNTY INDUSTRIAL**

# FOR LEASE

8 HOLLAND, IRVINE

±7,836 SF INDUSTRIAL SPACE

## SITE PLAN

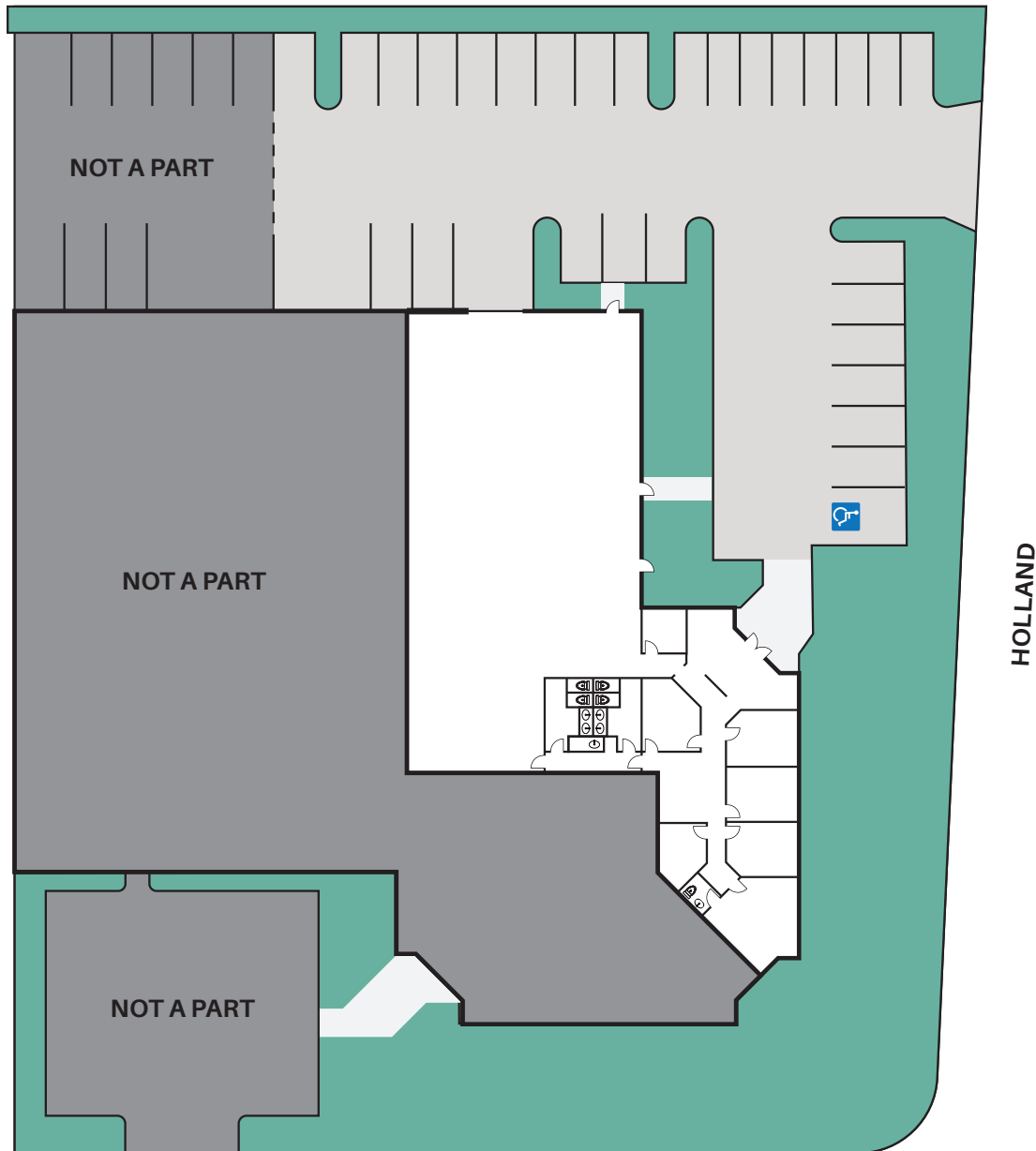

THOMAS

DALE CAMERA  
Senior Vice President  
License ID# 01313921  
949.790.3132  
dcamera@leeirvine.com

JASON HELMICK  
Senior Vice President  
License ID# 01786729  
949.790.3119  
jhelmick@leeirvine.com

ZACH SCHWANER  
Senior Vice President  
License ID# 02009623  
949.790.3159  
zschwaner@leeirvine.com

DYLAN DAVEY  
Associate  
License ID# 02219560  
949.790.3162  
ddavey@leeirvine.com



# FOR LEASE

8 HOLLAND, IRVINE

±7,836 SF INDUSTRIAL SPACE



**DALE CAMERA**  
Senior Vice President  
License ID# 01313921  
949.790.3132  
dcamera@leeirvine.com

**JASON HELMICK**  
Senior Vice President  
License ID# 01786729  
949.790.3119  
jhelmick@leeirvine.com

**ZACH SCHWANER**  
Senior Vice President  
License ID# 02009623  
949.790.3159  
zschwanner@leeirvine.com

**DYLAN DAVEY**  
Associate  
License ID# 02219560  
949.790.3162  
ddavey@leeirvine.com

