

For Lease

Golden Ln. & Lewis St.



[Click for a Virtual Tour](#)

265 Golden Ln.
Suite A
Reno, NV 89502

Michael Keating, SIOR
Partner
775.386.9727
mkeating@logicCRE.com
S.0174942

Michael Dorn
Senior Associate
775.453.4436
mdorn@logicCRE.com
S.0189635

Listing Snapshot



\$1.35 PSF
Lease Rate



± 2,167 SF
Available Warehouse Square Footage

Property Highlights

- Flex Industrial space in central Reno
- 10' roll-up door and 12' clear height
- Tenant is responsible for power, gas, internet, and phone service
- Power: 220 Amp
- One (1) private office
- ± 1,987 SF of warehouse and ± 180 SF of office
- Reznor heated

Demographics

	1-mile	3-mile	5-mile
2024 Population	12,925	137,887	261,339
2024 Average Household Income	\$74,737	\$78,535	\$94,799
2024 Total Households	5,377	58,896	108,349



Aerial

-  Government
-  Mixed-Use
-  Hospitals
-  Multifamily
-  Airports
-  Parks
-  Schools
-  Hotels / Casinos
-  Retail



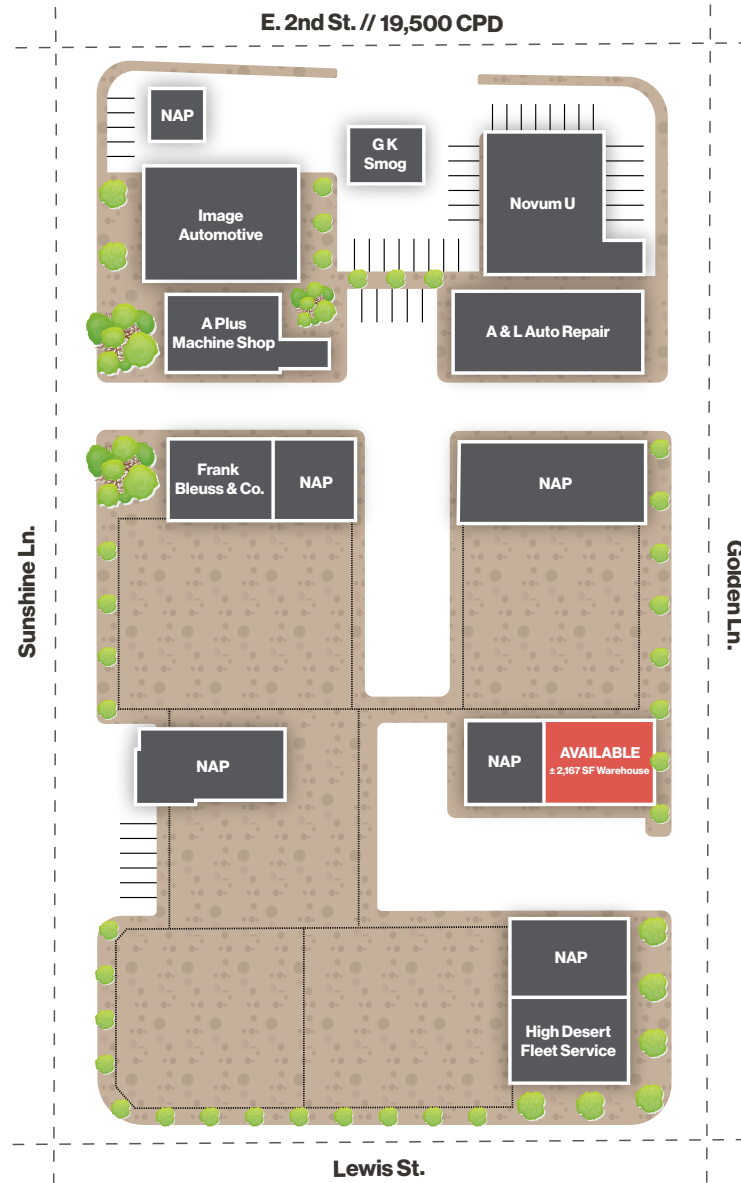

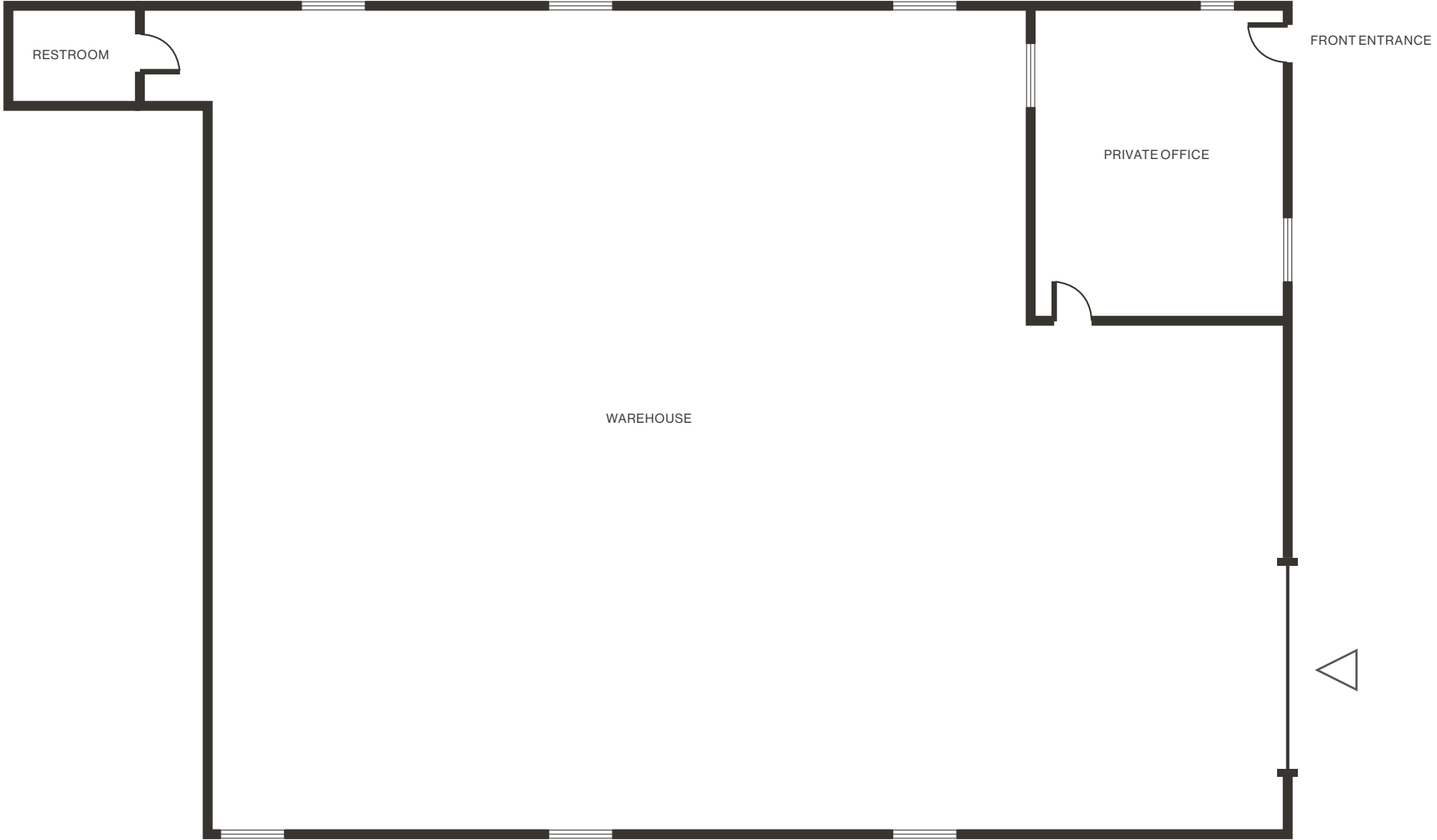

Property Photos



LOGIC Commercial Real Estate

Specializing in Brokerage and Receivership Services

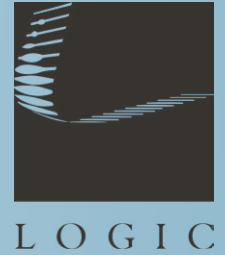

Join our email list and
connect with us on LinkedIn

The information herein was obtained from sources deemed reliable; however LOGIC Commercial Real Estate makes no guarantees, warranties or representation as to the completeness or accuracy thereof.

For inquiries please reach out to our team.

Michael Keating, SIOR

Partner
775.386.9727
mkeating@logicCRE.com
S.0174942

Michael Dorn

Senior Associate
775.453.4436
mdorn@logicCRE.com
S.0189635